

## B 80 W BP DOSE (ROLLER)

Walk-behind scrubber dryer (80 l) with traction drive. Ideal for 1500–3000 m². Sample configuration with contra-rotating roller brushes with sweeping function and 65 centimetre working width.



Order no. 1.259-010.2

Technical data		
EAN code		4039784590106
Drive type		Battery
Traction drive		Traction motor
Working width of brushes	mm	750
Working width, vacuuming	mm	940
Tank of fresh/dirty water	l	80 / 80
Theoretical area performance	m²/h	3000
Practical area performance	m²/h	2250
Battery type		maintenance-free
Battery	V / Ah	24 / 240
Battery runtime	h	max. 4
Battery charging time	h	approx. 9
Power supply for battery charger	V / Hz	100 - 240 / 50 - 60
Brush rotational speed	rpm	600 - 1400
Brush contact pressure	kg	54
Water consumption	l/min	10
Sound pressure level	dB(A)	69
Current type	V / Hz	100 - 240 / 50 - 60
Rated input power	W	max. 2200
Total permissible weight	kg	404
Dimensions (L × W × H)	mm	1550 × 809 × 1154

Users must receive training on this device.

Equipment		
Roller brush	Piece(s)	2
Fact		■
Sweeping function		■
Powerful traction drive		■
Battery charger		■
2-tank system		■
Motor		Battery

■ included in delivery.



## 4 batteries to choose from

- Maintenance-free with 170 Ah, 180 Ah, 240 (C5), and low-maintenance with 180 Ah (C5).
- Battery charger compatible with the different battery types.
- For a long battery life.



## The brush head and squeegee are automatically adjusted

- Automatic lowering depending on the selected cleaning programme.
- Squeegee is automatically raised when reversing.



## Brush head with rollers

- Available with either a 65 or 75 centimetre working width.
- Integrated drawer for coarse particles protects the squeegee against blockages.
- Water savings thanks to contra-rotating roller brushes.

## EQUIPMENT FOR B 80 W BP DOSE (ROLLER)

1.259-010.2

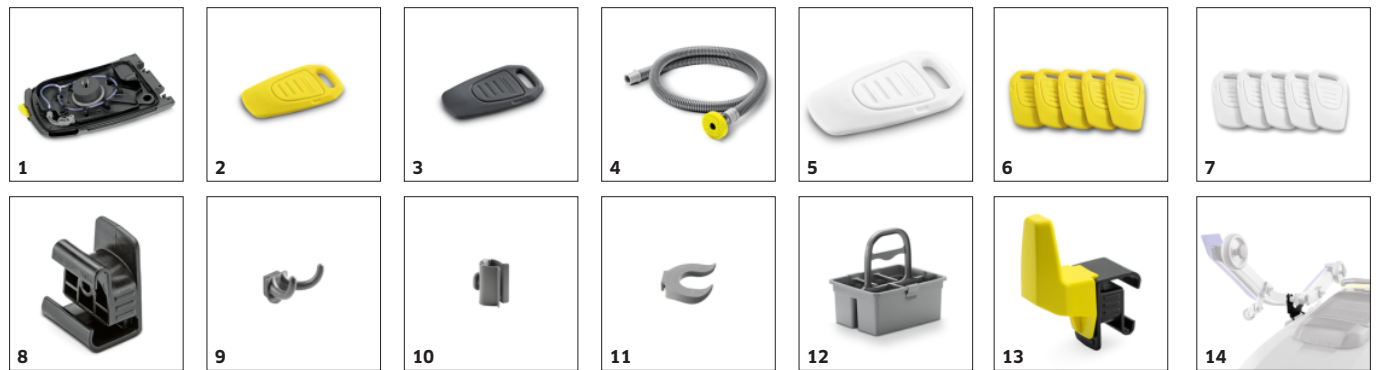

		Order no.	Description	
<b>OTHER ACCESSORIES FOR SCRUBBER DRYERS</b>				
<b>Miscellaneous</b>				
Cover with tank rinsing system	1	4.035-369.0	Tank cover for a scrubber drier with rinsing system for a tank cleaning.	■
KIK key, yellow	2	5.035-344.0	User key for using the appliance	■
KIK key, grey	3	5.035-348.0	Supervisor key for using the appliance	■
Filling hose	4	6.680-124.0	1,500-mm filling hose for easy device filling from a water tap. With universal tapered fitting for all standard taps.	□
KIK key, white	5	4.035-076.0	User key for using the appliance programmable	□
KIK key set, yellow	6	4.035-408.0	Key for operators. Cannot be adjusted.	□
KIK key set, white	7	4.035-064.0		□
<b>Cleaning tool kit accessories</b>				
Adapter Homebase	8	5.035-488.0	Fastener for various hooks and clips on the machine.	□
Double hook	9	6.980-077.0	Double hook for attaching rubbish bags, etc. to the machine. Only for use with the Homebase adapter 5.035-488.0.	□
Holder handhold grey	10	6.980-078.0	Mop clip for attaching a mop to the machine. Only for use with the Homebase adapter 5.035-488.0.	□
Bottle holder	11	6.980-080.0	Suitable for transporting spray bottles – only in conjunction with Home Base adapter 5.035-488.0.	□
Home Base Box Kit	12	4.035-406.0	The Box kit provides enough space for three cleaning agent bottles along with cloths, scrapers, spare rubbish bags, gloves, etc.	□
Universal hook kit	13	4.070-075.0	Hook and adaptor kit for attachment to the Home Base rail scrubber drier by Kärcher. Ideal for space-saving storage of hoses (for example, spray suction attachment kit) on the machine.	□
Holder suction bar complete	14	9.753-088.0		□

■ Included in delivery. □ Available accessories.

## EQUIPMENT FOR B 80 W BP DOSE (ROLLER)

1.259-010.2



		Order no.	Description	
<b>OTHER ACCESSORIES FOR SCRUBBER DRYERS</b>				
<b>RM Dosierstation</b>				
Cleaning agent dosage kit, wall mounted DS 3	15	2.641-811.0	Directly connectable with the tab, water and detergent will be filled in the fresh water tank in the preset mixture. Can also be used with filling system kit.	<input type="checkbox"/>
<b>KITS</b>				
<b>Other attachment kits</b>				
Auto-Fill	16	4.035-345.0	Automatic filling system. Water supply automatically stops when the tanks is full. With safety overflow.	<input checked="" type="checkbox"/>
Suction hose accessories	17	4.444-015.0	For vacuuming water out of corners or containers (e.g. freezers).	<input type="checkbox"/>
Set deflector roll stack formation SB	18	4.035-619.0		<input type="checkbox"/>
<b>Fleet mounting kit</b>				
Add-on kit	19	2.644-391.0		<input type="checkbox"/>
<b>Spray extraction mounting kit</b>				
Spray suction attachment kit	20	2.642-740.0	Simplifies cleaning areas inaccessible for machines.	<input type="checkbox"/>
<b>ROLLER BRUSHES FOR BR</b>				
Roller brush red for replacement - R75, medium, red, 700 mm	21	4.035-578.0		<input type="checkbox"/>
Roller brush white - R75, soft, white, 700 mm	22	6.907-729.0		<input type="checkbox"/>
Roller brush orange - R75, high / low, orange, 700 mm	23	6.907-730.0		<input type="checkbox"/>
Roller brush green - R75, hard, green, 700 mm	24	6.907-731.0		<input type="checkbox"/>
Roller brush black - R75, very hard, black, 700 mm	25	6.907-732.0		<input type="checkbox"/>
Roller brush, soft, white, 638 mm	26	6.906-981.0	Soft, for cleaning sensitive surfaces and for polishing. Fits on R 65.	<input type="checkbox"/>
Roller brush red for replacement BR65, medium, red, 638 mm	27	4.035-187.0		<input type="checkbox"/>
Roller brush, high / low, orange, 638 mm	28	6.906-982.0	Medium hard, for cleaning strong structured floors and deeper joints. Fits R 65.	<input type="checkbox"/>

■ Included in delivery. □ Available accessories.

## EQUIPMENT FOR B 80 W BP DOSE (ROLLER) 1.259-010.2



		Order no.	Description	
<b>ROLLER BRUSHES FOR BR</b>				
Roller brush, hard, green, 638 mm	29	6.906-983.0	Roller brush, hard, green. Length: 638 mm. Wear-resistant star-wheel mechanism. For heavily soiled floors and basic cleaning. Bristles: Polyamide with silicon carbide, 0.6 mm thick, 20 mm long.	<input type="checkbox"/>
Roller brush, very hard, black, 638 mm	30	6.906-984.0	Very hard, for extremely sticky dirt and for deep cleaning; for unsensitive surfaces only. Fits R 65.	<input type="checkbox"/>
<b>BRUSH HEADS</b>				
Brush-head R65	31	2.763-046.0		<input type="checkbox"/>
Brush-head R75	32	2.763-047.0		<input type="checkbox"/>
<b>ROLLER PADS / ROLLER PAD SHAFT</b>				
<b>Roller pad shaft</b>				
Roll pad - R75, 700 mm	33	4.762-627.0		<input type="checkbox"/>
Pad roller shaft, 638 mm	34	4.762-433.0	Roller pad shaft, aluminium For roller pads or microfibre rollers, length 638 mm. Fits brush head R 56.	<input type="checkbox"/>
<b>Roller pads</b>				
Roller pad, medium, red	35	6.369-456.0	Roller pads (x20), medium, red. For cleaning non-structured floors. Suitable for use with appropriate pad roller shaft. About 7 to 7.5 pads are required per 10 cm shaft length.	<input type="checkbox"/>
Roller pad, hard, green	36	6.369-455.0	Roller pads (x20), hard, green. For removing stubborn dirt and basic cleaning of non-structured floors. Suitable for use with appropriate pad roller shaft.	<input type="checkbox"/>
<b>Microfibre shaft</b>				
Microfibre roller, 700 mm	37	4.114-007.0	World innovation: application of microfibre rollers combines the excellent cleaning properties of microfibres with the benefits of the roller brush technology. Combined with roller pad shaft 4.762-434.0. Fits on R 75.	<input type="checkbox"/>
Microfibre roller, 638 mm	38	4.114-006.0	World innovation: application of microfibre rollers combines the excellent cleaning properties of microfibres with the benefits of the roller brush technology. Combined with roller pad shaft 4.762-433.0. Fits on R 65.	<input type="checkbox"/>
<b>DISC PADS / PAD DRIVE BOARDS</b>				
<b>Pads</b>				
Pad, medium-soft, red, 650 mm, 5 Piece(s)	39	6.371-000.0	Medium-hard pad (650 × 300 mm) in red version for cleaning all floors in combination with the S 65 head.	<input type="checkbox"/>
Pad, hard, brown, 650 mm, 5 Piece(s)	40	4.642-025.0	Tough, brown pad (650 × 300 mm) including Velcro fastener. For restoring shine in combination with the S 65 head. Only for insensitive surfaces.	<input type="checkbox"/>
<b>SUCTION BARS AND SQUEEGEES</b>				
<b>Suction bar, complete</b>				
Squeegee, 1000 mm, V-shaped	41	4.777-080.0	Suitable for all conventional floors and with very good gliding properties on crevices: V-shaped squeegee with length of 1,000 mm and suction lips made from wear-resistant polyurethane with a long lifetime.	<input type="checkbox"/>
Squeegee, 900 mm, V-shaped	42	4.777-079.0	900 mm long, V-shaped squeegee with suction lips made from wear- and oil-resistant polyurethane with a long lifetime and for all floors. With spirit level for precise adjustment.	<input type="checkbox"/>

■ Included in delivery.    □ Available accessories.

## EQUIPMENT FOR B 80 W BP DOSE (ROLLER)

1.259-010.2



		Order no.	Description	
<b>SUCTION BARS AND SQUEEGEES</b>				
<b>Squeegees for suction bars</b>				
Rubber lip set corrugated oil resistant, oil-resistant, grooved, 1116 mm	43	6.273-024.0	Designed for our 1,000 mm-long, V-shaped squeegees, this fluted suction lip set impresses on all floors. High-quality, oil-resistant design made from durable polyurethane.	<input type="checkbox"/>
Rubber lip set corrugated oil resistant, oil-resistant, grooved, 1010 mm	44	6.273-023.0	Suction lip set, fluted and developed for V-shaped squeegees with length of 900 mm. The suction lips are made of wear- and oil-resistant polyurethane and are suitable for all floors.	<input type="checkbox"/>
Suction lips, oil-resistant, grooved, 960 mm	45	6.273-208.0	Includes front and rear squeegee blades, 960 mm. Grooved squeegee blades of hard-wearing, oil-resistant, transparent polyurethane. For all standard floors.	<input type="checkbox"/>
Suction lips, oil-resistant, slotted, 960 mm	46	6.273-205.0	Includes front and rear squeegee blades, 960 mm. Slotted squeegee blades of hard-wearing, oil-resistant, transparent polyurethane. For sensitive floors.	<input type="checkbox"/>
Suction lips, oil-resistant, closed, 960 mm	47	6.273-291.0	Closed, oil-resistant, for structured floors.	<input type="checkbox"/>
Suction lips, Natural rubber, 960 mm	48	6.273-214.0	Squeegee blade kit includes front and rear squeegee blades, 960 mm. Soft natural rubber grooved squeegee blades. For all standard floors.	<input type="checkbox"/>
Rubber lip set oil resistant BR-BD530,55, oil-resistant, grooved, 890 mm	49	6.273-207.0	Squeegee blade kit includes front and rear squeegee blades, 870 mm. Grooved squeegee blades of hard-wearing, oil-resistant, transparent polyurethane. For all standard floors.	<input type="checkbox"/>
Suction lips, oil-resistant, slotted, 890 mm	50	6.273-229.0	Squeegee blade kit includes front and rear squeegee blades, 870 mm. Slotted squeegee blades of hard-wearing, oil-resistant, transparent polyurethane. For sensitive floors.	<input type="checkbox"/>
Suction lips, oil-resistant, closed, 890 mm	51	6.273-290.0	Suction lip set, consisting of front and rear suction lip. 890 mm long. In an enclosed design made from wear-resistant, oil-resistant and transparent polyurethane. For textured floors.	<input type="checkbox"/>
Rubber lip set standard, Natural rubber, 890 mm	52	6.273-213.0	Squeegee blade kit includes front and rear squeegee blades, 870 mm. Soft natural rubber grooved squeegee blades. For all standard floors.	<input type="checkbox"/>
<b>TRACTION BATTERIES AND CHARGERS</b>				
<b>Batteries</b>				
Battery kit Gel 4x 6V/240Ah, 24 V, 240 Ah, maintenance-free	53	2.815-102.0		<input type="checkbox"/>
Battery kit Gel 4x 6V/180Ah, 24 V, 180 Ah, maintenance-free	54	2.815-101.0		<input type="checkbox"/>
Battery kit AGM 4x 6V/285Ah, 24 V, 285 Ah, maintenance-free	55	2.815-095.0		<input type="checkbox"/>
Battery kit AGM 4x 6V/170Ah, 24 V, 170 Ah, maintenance-free	56	2.815-092.0		<input type="checkbox"/>

☐ Available accessories.

EQUIPMENT FOR B 80 W BP DOSE (ROLLER)  
1.259-010.2

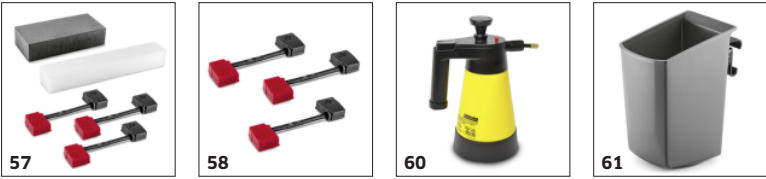

		Order no.	Description	
TRACTION BATTERIES AND CHARGERS				
Accessories for batteries				
Mounting kit battery kit	57	2.638-064.0		<input type="checkbox"/>
	58	2.638-106.0		<input type="checkbox"/>
Distance holder set VII	59	4.642-021.0	Fits quick charger set 2.642-751.0. Prevents the battery from slipping into the machine.	<input type="checkbox"/>
SPRAYERS				
Pump spray bottle 1 l	60	6.394-409.0	1 litre pump spray bottle - including pump and pressure tank - for easy, uniform spraying for cleaning or crystallising.	<input type="checkbox"/>
SPRAY EXTRACTION CLEANERS				
Other				
Cleaning agent container, complete	61	4.070-006.0	Kit consisting of cleaning agent container and Home Base adapter. For connecting Home Base rail.	<input type="checkbox"/>

☐ Available accessories.