

HD 17/14-4S PLUS

Super class cold water pressure washer for continuous operation in tough operating conditions. The HD 17/14-4S comes with very high water flow rate and lower pressure.



Order no. 1.286-915.0

- Save energy and time: EASY!Force high-pressure guns and EASY!Lock quick-release locks.
- Water-cooled three-phase motor
- Outstanding cleaning performance

Technical data

EAN code		4054278162959
Current type	Ph / V / Hz	3 / 400 / 50
Flow Rate	l/h	650 - 1700
Water feed temperature	°C	60
Operating pressure	bar / MPa	30 - 140 / 3 - 14
Max. Pressure	bar / MPa	154 / 15.4
Power rating	kW	9.4
Weight (with accessories)	kg	72.2
Weight incl. packaging	kg	78.2
Dimensions (L x W x H)	mm	560 x 500 x 1090

Equipment

Trigger gun		EASY!Force Advanced
Trigger gun with soft grip		■
High-pressure hose	m	10
Spray lance	mm	1050
Power nozzle		■
Dirt Blaster spray lance		■
4-pole three-phase motor with air and water cooling		■
Pressure switch control		■
Integrated fine mesh water filter		■
Electronic motor protection system with LED display		■
Oil sight glass		■
Servo Control		■
Brass water inlet fitting		■

■ included in delivery.

This device requires instruction.



Save energy and time: EASY!Force high-pressure guns and EASY!Lock quick-release locks.

- At last – work without getting tired: the EASY!Force high-pressure gun.
- EASY!Lock quick-release locks: durable and robust. And five times faster than screws.



Proven Kärcher quality

- 4-pole water-cooled electric motor.
- Robust brass cylinder head and ceramic pistons.
- Reinforced, unbreakable plastic chassis.



For increased safety

- Integrated electronics for unit monitoring.
- Automatic switch-off in case of undervoltage or overvoltage.
- Switches off in case of leaks or phase failure.

EQUIPMENT FOR HD 17/14-4S PLUS

1.286-915.0

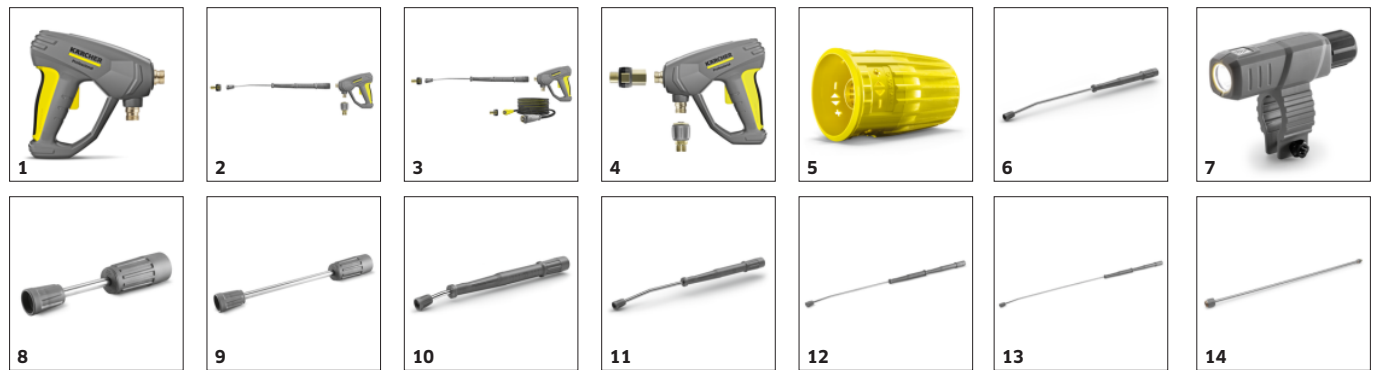

		Order no.	Description	
TRIGGER GUNS				
Trigger guns				
EASY!Force Advanced	1	4.118-005.0	Effortless, not energy-sapping: the EASY!Force high-pressure gun uses the recoil force of the high-pressure jet to reduce the holding force for the operator to zero.	■
Conversion kit 1 from high pressure hose	2	4.111-050.0	A conversion kit which enables secure connection from an M22 hose onto our innovative EASY!Force trigger gun. The kit includes the EASY!Force Trigger gun, adaptors and lance.	□
Conversion kit 2 from device	3	4.111-051.0	Provides all the parts required to utilise our EASY!Force technology even on our non-Easy!Force machines. Including adaptors, lance, Easy!Force trigger gun and hose.	□
Conversion kit 3 only EASY!Force	4	4.111-052.0	A conversion kit for the EASY!Force gun, which includes the correct adaptors to connect to the M22 style lance and hose.	□
Servo Control				
Servo Control, 1100 l/h -	5	4.118-009.0	Servo control for water flow and pressure control (> 1100 l/h) on the trigger gun.	■
SPRAY LANCES				
Rotating spray lances				
Spray lance, 1050 mm, rotatable	6	4.112-000.0	1050 mm stainless steel lance (manual coupling) with ergonomic handle for ease of use and protection. Rotatable 360° under pressure.	■
LED nozzle light	7	2.680-002.0	LED work light for assembly on EASY!Force spray lances, providing a clear view in poor lighting conditions ensuring controlled cleaning results.	□
Spray lance, 250 mm, rotatable	8	4.112-027.0	250 mm stainless steel lance (manual coupling) with ergonomic handle for ease of use and protection. Rotatable 360° under pressure.	□
Spray lance, 400 mm, rotatable	9	4.112-024.0	400 mm stainless steel lance (manual coupling) with ergonomic handle for ease of use and protection. Rotatable 360° under pressure.	□
Spray lance, 600 mm, rotatable	10	4.112-007.0	600 mm stainless steel lance (manual coupling) with ergonomic handle for ease of use and protection. Rotatable 360° under pressure.	□
Spray lance, 840 mm, rotatable	11	4.112-006.0	850 mm stainless steel lance (manual coupling) with ergonomic handle for ease of use and protection. Rotatable 360° under pressure.	□
Spray lance, 1550 mm, rotatable	12	4.112-018.0	1550 mm stainless steel lance (manual coupling) with ergonomic handle for ease of use and protection. Rotatable 360° under pressure.	□
Spray lance, 2050 mm, rotatable	13	4.112-021.0	2050 mm stainless steel lance (manual coupling) with ergonomic handle for ease of use and protection. Rotatable 360° under pressure.	□
Spray lance extender, 1000 mm	14	4.112-048.0	Spray lance extension with EASY!Lock connection. Length 1000 mm.	□

■ Included in delivery. □ Available accessories.

EQUIPMENT FOR HD 17/14-4S PLUS

1.286-915.0



		Order no.	Description	
SPRAY LANCES				
Double lance				
Double lance, 960 mm	15	2.112-016.0	960 mm double lance for variable pressure adjustment on handle at full water flow rate. Suitable for agricultural use (e.g. stable cleaning).	<input type="checkbox"/>
Angular spray lance				
WC and gutter lance	16	4.112-029.0	Stainless steel lance WC and gutter with nozzle insert. Specially shaped for effective and hygienic cleaning of gutters and toilets.	<input type="checkbox"/>
Flexible spray lance				
Flexible lance, 1050 mm	17	4.112-035.0	1050 mm flexible lance with variable bend from 20° to 140°, ideal for cleaning difficult to reach areas, e.g. gutters.	<input type="checkbox"/>
High pressure articulated joint	18	4.112-057.0	For hard-to-reach areas: High-pressure articulated joint with infinite angle adjustment up to 120°. Simply attach directly to the spray lance of the pressure washer.	<input type="checkbox"/>
Gutter cleaner				
Gutter cleaning lance	19	2.112-015.0	The lance is suited for cleaning of gutter systems. Because of the shape of the lance and the special nozzle the gutter can be cleaned without removing the cover plates.	<input type="checkbox"/>
Undercarriage spray lance				
Underbody lance	20	4.112-032.0	Stainless steel lance for effective and easy underbody and wheel arch cleaning. Without high-pressure nozzle.	<input type="checkbox"/>
Additional handle				
Additional handle for EASY!Lock spray lances	21	4.321-380.0	Comfortable in every situation – the additional handle is easy to attach to the spray lance of our new EASY!Lock generation and makes work easier by allowing you to adjust your posture to suit the particular task.	<input type="checkbox"/>
ROTARY NOZZLES (DIRT BLASTERS)				
Dirt blaster, large				
Dirt Blaster Nozzle, large, 120	22	4.114-044.0	The dirt blaster with rotating pencil jet offers 10 times better cleaning performance. Ceramic nozzle and bearing ring for a long service life. Further data: Max. 300 bar, 30 MPa, 85°C.	<input checked="" type="checkbox"/>
KÄRCHER POWER NOZZLE				
Power nozzle spray angle 25°				
Power Nozzle 25°, 115	23	2.113-060.0	Fan jet nozzle for large-area coverage and stubborn dirt and stains.	<input checked="" type="checkbox"/>
HIGH-PRESSURE HOSES				
Standard with unions on both sides				
High-pressure hose, 10 m, 220 bar, 2 × EASY!Lock	24	6.110-041.0		<input checked="" type="checkbox"/>
High-pressure hose, 15 m, 220 bar, 2 × EASY!Lock	25	6.110-042.0	15 m high-pressure hose M 22 × 1.5) with kink protection and threaded couplings at both ends. Further data: DN 10/155°C/220 bar.	<input type="checkbox"/>
High-pressure hose, 20 m, 220 bar, 2 × EASY!Lock	26	6.110-043.0	with union on both sides, M 22 × 1.5 with anti-kink protection. NW 10/155°C/220 bar	<input type="checkbox"/>
High-pressure hose, 25 m, 220 bar, 2 × EASY!Lock	27	6.110-044.0		<input type="checkbox"/>
High-pressure hose, 40 m, 220 bar, 2 × EASY!Lock	28	6.110-045.0		<input type="checkbox"/>

■ Included in delivery. □ Available accessories.

EQUIPMENT FOR HD 17/14-4S PLUS

1.286-915.0



		Order no.	Description	
HIGH-PRESSURE HOSES				
Standard with unions on both sides				
High-pressure hose, 15 m, 210 bar, 2 × EASY!Lock	29	6.110-059.0	High-pressure hose for water volumes greater than 1,800 l / h. With union on both sides. 2x M 22 × 1.5 with anti-kink protection.	<input type="checkbox"/>
High-pressure hose, 40 m, 210 bar, 2 × EASY!Lock	30	6.110-060.0		<input type="checkbox"/>
INTERIOR CLEANING HEADS				
HKF 50				
HKF 50 P	31	3.631-008.0	Spray head driven by a compressed air motor for the industrial container cleaning Cleaning of small barrels (200 – 500 l)	<input type="checkbox"/>
Spray head HKF 50, stainless steel	32	3.631-009.0		<input type="checkbox"/>
NOZZLE UNION / SPACER				
Nozzle union				
Nozzle screws	33	4.112-011.0	Nozzle screws with protectors for high-pressure and power nozzles	<input type="checkbox"/>
PIPE CLEANING				
Pipe cleaning hose, ID 6				
Hose assembly TR pipe cleaning DN6 max.2	34	6.110-046.0	The 10 m pipe cleaning hose is a highly flexible high pressure hose for pipe interior cleaning (threaded connection for nozzle R 1/8).	<input type="checkbox"/>
Pipe cleaning hose, DN 6, 20 m, 220 bar	35	6.110-008.0		<input type="checkbox"/>
Hose assembly TR pipe cleaning DN6 max.2	36	6.110-047.0	The 30 m pipe cleaning hose is a highly flexible high pressure hose for pipe interior cleaning (threaded connection for nozzle R 1/8).	<input type="checkbox"/>
Pipe cleaning nozzle				
Dirt blaster pipe cleaning D21/060	37	4.765-002.0	The forward-tilted rotating pencil jet removes the most stubborn dirt. The three backwards-tilted jets ensure the necessary forward movement, as well as convenient handling.	<input type="checkbox"/>
Dirt blaster pipe cleaning D30/060	38	4.765-005.0		<input type="checkbox"/>
Nozzle pipe cleaning size 120	39	5.763-089.0	Pipe cleaning nozzle with 24 mm diameter. With 8 nozzles tilted back at a 30° angle.	<input type="checkbox"/>
Pipe cleaning nozzle	40	5.763-019.0	16 mm pipe cleaning nozzle with internal thread. Various jet directions for environmentally-friendly cleaning of blocked drains and pipes.	<input type="checkbox"/>
	41	5.763-016.0		<input type="checkbox"/>
		42	5.763-021.0	30 mm pipe cleaning nozzle with internal thread. Various jet directions for environmentally-friendly cleaning of blocked drains and pipes.

☐ Available accessories.

EQUIPMENT FOR HD 17/14-4S PLUS

1.286-915.0



		Order no.	Description	
PIPE CLEANING				
Pipe cleaning nozzle				
Rotating pipe cleaning nozzle	43	6.415-440.0	Rotating pipe cleaning nozzle with internal thread and four rotating jets for environmentally-friendly cleaning of blocked drains and pipes.	<input type="checkbox"/>
FLOOR AND HARD SURFACE CLEANER				
Hard surface cleaner FR 30 ME				
FR 30 ME surface cleaner	44	2.111-013.0	Hot water resistant stainless steel surface cleaner with double ceramic bearings, non-marking swivel castors and suction hose connection. Ideal for indoor cleaning, e.g. food industry.	<input type="checkbox"/>
Hard Surface Cleaner FR 50				
FR 50 surface cleaner	45	2.111-023.0	Hot water resistant stainless steel surface cleaner with 500 mm working width. Ideal for large areas. With double ceramic bearings, push handle, non-marking swivel castors and detergent dosing system.	<input type="checkbox"/>
Machine-specific nozzle kit for FR				
Nozzle kit for FR, 1300 l/h - 1800 l/h	46	2.640-781.0	Machine-specific nozzle kit Kärcher power nozzle for hard surface cleaners	<input type="checkbox"/>
Machine-specific nozzle kits for FRV				
Nozzle kit for FRV, 100	47	2.643-769.0	Machine-specific nozzle kit Kärcher power nozzles and jet nozzle for FRV 30 and FRV 50.	<input type="checkbox"/>
Hard surface cleaner FRV 30 Me				
Extension hose FRV 30 Me and FRV 50 Me	48	4.441-040.0	5 m extension hose for FRV 30 Me. Includes connecting adapter.	<input type="checkbox"/>
FRV 30 Me Surface Cleaner	49	2.111-012.0	Thanks to automatic suction of the dirty water, the stainless steel FRV 30 Me Surface Cleaner makes surface cleaning more efficient in both inside and outside areas. Hot water cleaning up to 85°C.	<input type="checkbox"/>
Surface Cleaner FR 50 Me				
FRV 50 Me surface cleaner	50	2.111-024.0	Surface cleaning with automatic suction of the dirty water for very large surfaces. Hot water cleaning up to 85°C.	<input type="checkbox"/>
FOAM SYSTEMS				
Cup foam lance				
Cup foam lance Basic 3, 900 l/h - 2500 l/h	51	4.112-055.0	For high-pressure cleaners with a flow rate of 900-2500 l/h: new, robust and very high-quality foam cup lance with outstanding foam quality while consuming half as much cleaning agent.	<input type="checkbox"/>
1-litre cleaning agent container for cup foam lance basic	52	5.071-414.0		<input type="checkbox"/>
1-litre cleaning agent container for cup foam lance advanced	53	6.414-050.0	Additional 1-litre cleaning agent container for quick replacement of the cleaning agent (for foam lance 2.112-017.0 and 2.112-018.0).	<input type="checkbox"/>
Cup foam lance Advanced 3, 900 l/h - 2500 l/h	54	4.112-065.0		<input type="checkbox"/>
Cup foam lance DUO Advanced 3, 900 l/h - 2500 l/h	55	4.112-069.0		<input type="checkbox"/>
Inno Foam Set				
Inno foam kit with detergent injector	56	2.112-000.0	High-pressure foam system with double lance (foam nozzle and high-pressure jet for rinsing). For use with mobile and stationary high-pressure and HDS pressure cleaners for cleaning or disinfection.	<input type="checkbox"/>

☐ Available accessories.

EQUIPMENT FOR HD 17/14-4S PLUS

1.286-915.0

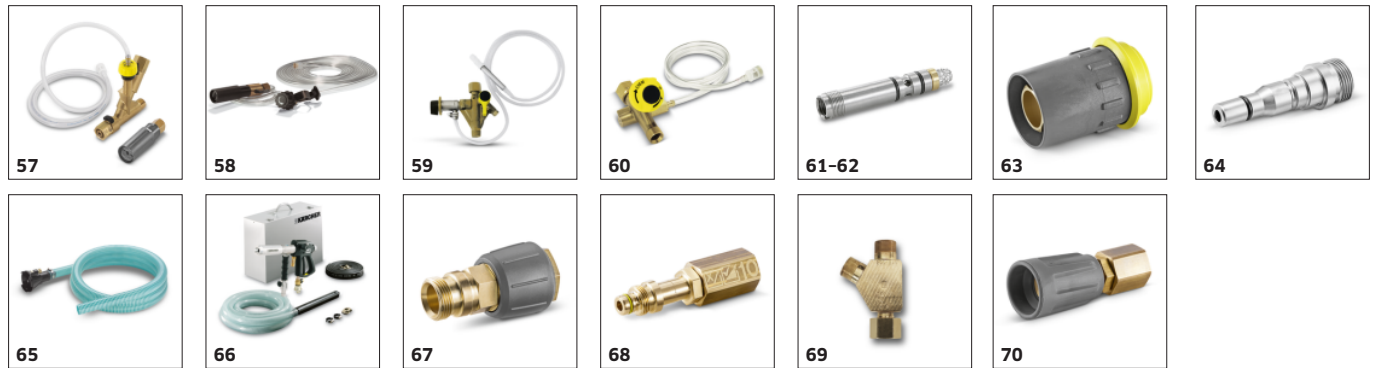

		Order no.	Description	
FOAM SYSTEMS				
Easy Foam Set				
Easy Foam Set with RM injector	57	2.112-010.0	HP foam system for use with. HD/HDS units for cleaning and disinfecting. Foam nozzle for connection to lance and HP chemical injector with precision 0-5% metering valve. The machine specific nozzle kit has to be ordered separately.	<input type="checkbox"/>
Foam nozzle mounting kit				
Foam nozzle kit	58	2.112-013.0	Foaming agent kit. The foam nozzle is ideal for use in sanitary areas and the food industry and wherever long application times are necessary.	<input type="checkbox"/>
MIXERS AND INJECTORS				
HP detergent injector				
Detergent injector for high and low pressure (without nozzles)	59	4.637-032.0	Detergent injector for independent high and low pressure dosage. Maximum dosage about 15%.	<input type="checkbox"/>
Detergent injector for high pressure	60	4.637-033.0	Cleaning agent dosage at high pressure 3 - 5 %	<input type="checkbox"/>
Nozzle insert with order no. 3.637-001				
High pressure for units rated 1100 l/h or more	61	4.769-002.0	For high pressure with machines above 1.100 l/h	<input type="checkbox"/>
Low pressure for units rated 1100 l/h or more	62	4.769-006.0	For low pressure with machines above 1.100 l/h	<input type="checkbox"/>
QUICK CONNECT				
Quick-fitting pipe union coupler trapezo	63	2.115-000.0	For fast changes between different spray lances/accessories. Perfect for Kärcher spray unit, suitable for trigger gun/spray lance interface. With M 22 x 1.5 internal thread.	<input type="checkbox"/>
Quick-fitting pipe union plug nipple tra	64	2.115-001.0	Hardened stainless steel male coupling for quick coupling 2.115-000. With M 22 x 1.5 external thread.	<input type="checkbox"/>
DRUM AND TANK CLEANING				
Add-on kit mud sucker	65	2.641-798.0		<input type="checkbox"/>
OTHER HP ACCESSORIES				
Jet gun	66	2.869-067.0	Short set-up time, easy transport, instant switch off - the jet gun is the affordable cleaning method for all kinds of small to medium-sized areas. Adjustable pressure/water volume.	<input type="checkbox"/>
COUPLING PARTS				
Rotary coupling				
Rotary coupling	67	4.111-021.0	Kärcher rotary coupling prevents twisting and kinking of high-pressure hoses for ease of use. Connector Easy!Lock. With grip protection.	<input type="checkbox"/>
Connector				
Nozzle connector/screw connector	68	4.111-022.0	Nozzle connector/screw connector for connecting high-pressure nozzles and accessories to the high-pressure trigger gun (with nozzle connector). Connectors: 1x M 22 x 1.5 and 1x M 18 x 1.5.	<input type="checkbox"/>
Y distributor	69	4.111-024.0	Offers the option to connect two spray units to the machine. Installation on the high pressure outlet.	<input type="checkbox"/>
Short spray unit	70	4.111-038.0	For attaching high-pressure nozzles and accessory parts to HP trigger gun (with nozzle screws). Not compatible with triple nozzles.	<input type="checkbox"/>

☐ Available accessories.

EQUIPMENT FOR HD 17/14-4S PLUS

1.286-915.0

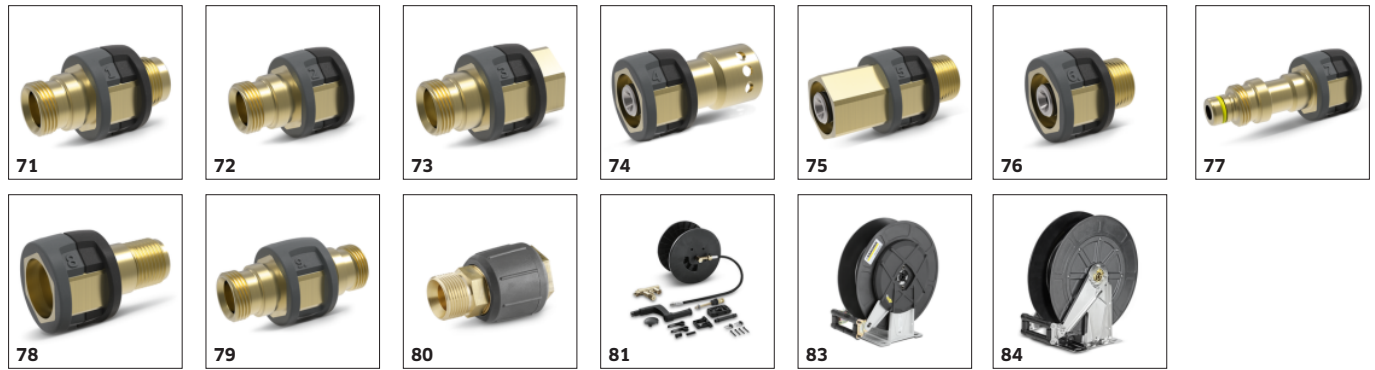

		Order no.	Description	
COUPLING PARTS				
Adapter EASY!Lock				
Adapter 1 M22AG-TR22AG	71	4.111-029.0	Adapter 1 to connect the old hose with the new hose	<input type="checkbox"/>
Adapter 2 M22IG-TR22AG	72	4.111-030.0	Adapter 2 to connect the old device with the new hose and the old gun with the new hose	<input type="checkbox"/>
Adapter 3 M22IG-TR22AG	73	4.111-031.0	Adapter 3 to connect the old gun with the new spray lance and new servo regulator	<input type="checkbox"/>
Adapter M22 - Swivel	74	4.111-032.0	M22 × 1,5female and swivel connection. For extension of high-pressure hoses with AVS connection or for usage of the telescopic lance with a high-pressure hose with AVS connection.	<input type="checkbox"/>
Adapter 5 TR22IG-M22AG	75	4.111-033.0	Adapter 5 to connect the new gun with the old spray lance and new servo regulator with the old spray lance	<input type="checkbox"/>
Adapter 6 TR22IG-M22AG	76	4.111-034.0	Adapter 6 to connect the new device with the old hose and the old hose with the new gun	<input type="checkbox"/>
Adapter 7 M18IG-TR20AG	77	4.111-035.0	Adapter 7 to connect the old spray lance with the new nozzle	<input type="checkbox"/>
Adapter 8 TR20IG-M18AG	78	4.111-036.0	Adapter 8 to connect the new spray lance with the old nozzle	<input type="checkbox"/>
Coupler -2xM22x1,5	79	4.111-037.0	Brass double connector for connecting and extending high-pressure hoses. With rubber protection. Connector: 2x M 22 × 1.5 m.	<input type="checkbox"/>
ADAPTER for replacement TR22IG-M22AG Er	80	4.111-046.0	Rotatable adapter for connecting EASY!Force high-pressure gun and high-pressure hoses with M 22x1.5 connection	<input type="checkbox"/>
HOSE REELS				
Hose reel add-on kit				
Hose reel attachment kit for HD super class, 20 m	81	2.110-008.0	ABS hose reel for mounting on the machine. For safe and tidy stowage of high-pressure hoses. Can be rotated under pressure, with M 22 × 1.5 connection.	<input type="checkbox"/>
Automatic, self-winding hose reels				
Automatic plastic hose reel incl. high-pressure hose, 15 m	82	2.639-257.0		<input type="checkbox"/>
Automatic hose reel, powder-coated steel / plastic, 20 m	83	6.392-074.0	Automatic hose reel for 20 m high-pressure hose. The console is made from powder-coated steel, the drum is made from plastic.	<input type="checkbox"/>
Automatic stainless steel / synthetic material hose drum, 20 m	84	6.392-083.0	Automatic hose reel for 20 m high-pressure hose. The console consists of stainless steel, the drum is made from plastic.	<input type="checkbox"/>

☐ Available accessories.

EQUIPMENT FOR HD 17/14-4S PLUS

1.286-915.0



		Order no.	Description	
HOSE REELS				
Automatic, self-winding hose reels				
Automatic hose reel, coated, 20 m	85	6.392-106.0	Automatic hose reel of durable plastic. Painted steel bracket. Suitable for 20 m high-pressure hose.	<input type="checkbox"/>
Hose reel, automatic, basalt grey-coated, 20 m	86	6.392-105.0	Automatic hose reels provide the highest level of safety and convenience for winding and unwinding HP hoses.	<input type="checkbox"/>
Automatic hose reel, stainless steel, includes swivel holder, 20 m	87	6.392-076.0	Automatic stainless steel hose reel. With swivel holder. Suitable for 20 m high-pressure hose.	<input type="checkbox"/>
Automatic stainless steel hose reel, 40 m	88	6.392-442.0	Automatic hose reels provide the highest level of safety and convenience for winding and unwinding HP hoses. Compatible high-pressure hose, e.g. order no. 6.110-076.0 (ID 8, 40 m, 400 bar, 1x hose reel connection attachment kit).	<input type="checkbox"/>
Powder-coated swivel holder	89	2.639-931.0	Swivel holder for automatic hose reel wall mounting. For maximum action radius and flexibility of high-pressure hose. Rotatable 120°. Galvanised steel.	<input type="checkbox"/>
Stainless steel swivel holder	90	2.641-867.0	Swivelling wall bracket made of high-grade steel (for 2.641-866). This makes maximum flexibility and convenience possible when working with the HP hose.	<input type="checkbox"/>
FACADE AND SOLAR PANEL CLEANING				
Brushes				
Brush hard	91	6.960-133.0	Brush with hard bristles for cleaning industry facades and floor coverings and removing coarse dirt. Simple installation on telescopic lances or high-pressure lances from Kärcher.	<input type="checkbox"/>
Brush medium	92	6.960-134.0	Optimally cleans facades, roller shutters and textile fabrics: the brush with medium-hard bristles for fast and simple attachment to telescopic lances or high-pressure lances from Kärcher.	<input type="checkbox"/>
Brush soft	93	6.960-135.0	For simple installation on telescopic lances or high-pressure lances from Kärcher: brush with soft bristles for deep cleaning of sensitive surfaces such as glass or solar systems.	<input type="checkbox"/>
Telescopic				
TL low pressure adapter	94	4.580-097.0	TL low-pressure adapter comprising ball valve for tool-free installation on telescopic lances. Ideal for applications with rotating high-pressure brushes.	<input type="checkbox"/>
Telescopic lance TL 7 F	95	4.762-609.0	Telescopic lance TL 7 F with up to 7 m reach made from robust and lightweight glass fibre. With practical quick-release fasteners for simple retraction and extension.	<input type="checkbox"/>
Telescopic lance TL 7 H	96	4.762-610.0	Multifunctional hybrid telescopic lance TL 7 H made of rigid and lightweight carbon-glass fibre mix. Telescopic thanks to quick-release fastenings. Up to 7 m reach.	<input type="checkbox"/>
Telescopic lance TL 10 H	97	4.762-611.0	Up to 10 m reach: hybrid telescopic lance TL 10 H. Comprising carbon-glass fibre mix and suitable for multifunctional use. Simple retraction and extension thanks to quick-release fasteners.	<input type="checkbox"/>
Telescopic lance TL 10 C	98	4.762-612.0	Carbon fibre telescopic lance TL 10 C. With up to 10 m reach and practical quick-release fasteners. Multifunctional use for cleaning facades, windows or solar panels.	<input type="checkbox"/>

☐ Available accessories.

EQUIPMENT FOR HD 17/14-4S PLUS

1.286-915.0



		Order no.	Description	
FACADE AND SOLAR PANEL CLEANING				
Telescopic				
Telescopic lance TL 14 C	99	4.762-613.0	Maximum rigidity with minimum weight: telescopic lance TL 14 C made from carbon fibre. Enormous reach of 14 m, multifunctional use and easy to use thanks to quick-release fasteners.	<input type="checkbox"/>
TL high pressure adapter	100	4.775-154.0	TL high-pressure adapter, flexible high-pressure gun for high-pressure cleaning with telescopic lances. Ergonomic, easy to install, suitable for right- and left-handed individuals.	<input type="checkbox"/>
WET BLASTING ATTACHMENT				
Nozzle pack for wet blasting attachment				
Nozzle pack TR wet jet set 0100	101	2.112-030.0	Consisting of wet jet nozzle and nozzle insert – only for use in combination with wet jet unit 4.115-000.0 4.115-006.0.	<input type="checkbox"/>
Boron carbide nozzle				
Boron carbide nozzle, for machines as of 1000 l/h	102	6.415-083.0	In addition to nozzle packs. Very wear-resistant nozzle with boron carbide chuck for continuous-duty operation.	<input type="checkbox"/>
DRUM AND TANK CLEANING				
HKF 50 spray head, brass				
HKF 50 spray head , brass	103	3.631-039.0	Interior cleaning head for barrels and containers with bungholes of 50 mm and more.	<input type="checkbox"/>
HKF 50 spray head, brass	104	3.631-058.0		<input type="checkbox"/>
WATER CONNECTION				
Geka coupling				
With hose nozzle, R 1"	105	6.388-465.0	with hose barb	<input type="checkbox"/>
Hose coupling	106	6.388-458.0	with female thread	<input type="checkbox"/>
Suction filter				
Water filter	107	6.414-956.0	Suitable for ponds, storage tanks or similar, polyamide filter casing, stainless steel strainer, 800 µm mesh, R 3/4" and R 1" connection, without non-return valve	<input type="checkbox"/>
Suction filter with check valve	108	4.730-012.0	Brass suction filter suitable for ponds, storage tanks, etc. With check valve.	<input type="checkbox"/>
Fine-mesh water filter				
Add-on kit water filter universal	109	2.637-020.0		<input type="checkbox"/>
Fine-mesh water filter with adapter	110	4.730-102.0	Fine-mesh water filter, 125 µm, max. temperature 50°C. Protects the high-pressure cleaner from dirt particles contained in the water. Water flow rate up to 1200 l/h. Connection 3/4", with adapter, 1".	<input type="checkbox"/>
Fine-mesh water filter, 100 µm, R 1"	111	2.638-270.0	Fine-mesh water filter, 100 µm, max. temperature 60°C. Connects to high-pressure cleaner. Protects the high-pressure cleaner from dirt particles contained in the water. Water flow rate up to 1200 l/h. Connector 1".	<input type="checkbox"/>
Water supply hose				
Water supply hose	112	4.440-207.0	NW 19 R1" / R 3/4", up to 85 °C, for pick-up	<input type="checkbox"/>

☐ Available accessories.

EQUIPMENT FOR HD 17/14-4S PLUS

1.286-915.0



		Order no.	Description	
WATER CONNECTION				
Water supply hose				
Water supply hose	113	4.440-270.0	NW 19 R1" / R1", up to 85 °C	<input type="checkbox"/>
Backflow check valve				
Backflow preventer	114	2.641-374.0	To prevent detergent getting into the drinking water cycle in case of inlet at low-pressure. - hot water resistant up to 80 °C - tested according to IEC 60335-2-79 - integrated leakage protection	<input type="checkbox"/>
WASHING BRUSHES				
Push-on washing brush				
Push-on wash brush, M 18 × 1.5	115	4.113-001.0	Push-on wash brush for universal use. Simply push on to lance. Connector: M 18 × 1.6.	<input type="checkbox"/>
Rotating washing brush				
Rotating wash brush for > 800 l/h machines, nylon bristles	116	4.113-002.0	Driven by water stream. Gently removes fine dust and traffic film from any surface. Temperature resistant up to 60°C, M 18 × 1.5 (replaceable brush insert).	<input type="checkbox"/>
Rotating wash brush for > 800 l/h machines, natural bristles	117	4.113-005.0		<input type="checkbox"/>

☐ Available accessories.