

IVR-L 65/12-1 TC

The IVR-L 65/12-1 Tc industrial vacuum is a compact, entry-level machine with tilting chassis for vacuuming liquids and/or shavings in the metal processing industry.



Order no.

9.986-055.0

- Tilting chassis
- Compact construction style that takes up very little floor space
- Visual filling level display

Technical data

EAN code		4054278029696
Current type	Ph / V / Hz	1 / 220 - 240 / 50 - 60
Air flow	l/s / m³/h	59 / 212.4
Vacuum	mbar / kPa	230 / 23
Container content	l	65
Container material		Metal
Rated input power	kW	1.2
Vacuuming type		Electric
Nominal size		ID 50
Accessory nominal size		ID 40
Main filter dust class		L
Filter area for main filter	m²	0.25
Weight without accessories	kg	40
Weight (with accessories)	kg	40
Weight incl. packaging	kg	41
Dimensions (L × W × H)	mm	742 × 500 × 1100

Equipment

Accessories included with machine	no
Container emptying	Tilting chassis

■ included in delivery.

Users must receive training on this device.



Ergonomic tilting chassis

- Sophisticated system for safe, manual, effortless emptying.
- Frame system enables ergonomic tilted emptying using the roll-off mechanism.
- Quick and easy emptying of the container: just tip backwards and you're done!



Reliable overfill protection

- A float effectively prevents overfilling of the collection container.
- Transparent hose for checking the amount of fluid absorbed.
- The hose is also used for easy emptying.



High robustness, flexibility and modularity

- Machine and chassis very robust and equipped with high wall thicknesses.
- Rotatable hose connection with up to 360° rotatable pipe bend.
- Optionally available with overfill protection, strainer or accessories holder.

EQUIPMENT FOR IVR-L 65/12-1 TC 9.986-055.0

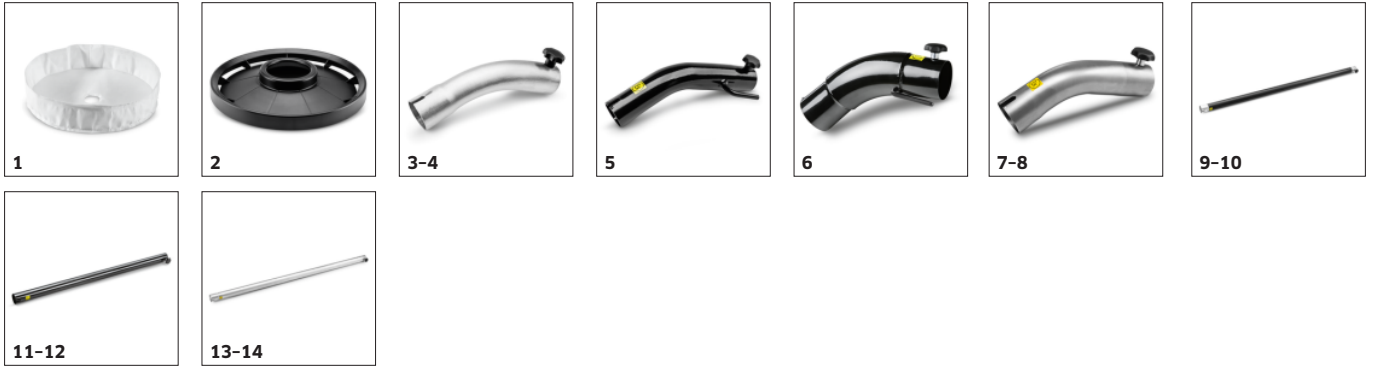

	Order no.	Description	
FILTERS			
Surface filters			
Surface filter PE L 0.25 m ²	1 9.980-225.0	Surface filter for dust class L with 360 mm diameter. Made from polyester, with 0.25 m ² filter area.	<input checked="" type="checkbox"/>
OTHER ACCESSORIES			
Baffle plate for box ø420mm	2 9.984-119.0	Baffle plate made from plastic with 420 mm diameter for containers and tanks.	<input checked="" type="checkbox"/>
HANDLES			
Elbow aluminium 45° DN40	3 9.989-544.0		<input type="checkbox"/>
Elbow aluminium 45° DN50	4 9.989-547.0		<input type="checkbox"/>
Hand grip curved 45°, DN 42	5 9.977-679.0		<input type="checkbox"/>
Hand grip 45°, DN 52 ohne Sterngriff	6 9.977-678.0		<input type="checkbox"/>
Hand grip curved stainless steel 45°IK D	7 9.989-036.0		<input type="checkbox"/>
Hand grip curved stainless steel 45°, IK	8 9.988-111.0		<input type="checkbox"/>
SUCTION TUBES			
Suction tube carbon 1500mm DN40	9 9.989-552.0		<input type="checkbox"/>
Suction tube carbon 1500mm DN50	10 9.989-553.0		<input type="checkbox"/>
Suction tube 750 mm DN40	11 9.977-525.0		<input type="checkbox"/>
Extension pipe 850mm DN 50, SBG	12 9.977-531.0		<input type="checkbox"/>
Extension pipe stainless steel DN50 US	13 9.989-038.0		<input type="checkbox"/>
Hand grip curved stainless steel 45°IK D	14 9.989-035.0		<input type="checkbox"/>

■ Included in delivery. □ Available accessories.

EQUIPMENT FOR IVR-L 65/12-1 TC 9.986-055.0



	Order no.	Description	
SUCTION TUBES			
Extension pipe stainless steel DN40 US	15	9.989-039.0	<input type="checkbox"/>
Extension pipe stainless steel DN50 IK,	16	9.988-114.0	<input type="checkbox"/>
ACCESORY SETS			
Liquid / Swarf			
Floor Cleaning Kit liquid Advanced DN40	17	9.990-895.0	<input type="checkbox"/>
NOZZLES			
Standard nozzles			
Standard nozzle PVC DN40	18	9.989-674.0	<input type="checkbox"/>
Standard nozzle PVC DN50	19	9.989-673.0	<input type="checkbox"/>
Nozzle elastic silicon DN42	20	9.988-401.0	<input type="checkbox"/>
Nozzle elastic silicon DN52	21	9.988-402.0	<input type="checkbox"/>
Standard nozzle rubber cuttable DN40	22	9.989-677.0	<input type="checkbox"/>
Standard nozzle rubber cuttable DN50	23	9.989-675.0	<input type="checkbox"/>
Standard aluminium nozzle DN40	24	9.980-748.0	<input type="checkbox"/>
Standard aluminium nozzle DN50	25	9.980-749.0	<input type="checkbox"/>
Standard nozzles bendable			
Nozzle, zinc coated, flexible, with rubber tip	26	9.981-420.0	<input type="checkbox"/>
	27	9.981-421.0	<input type="checkbox"/>
Standard nozzle, flexible, angled 90° PP DN40	28	9.981-429.0	<input type="checkbox"/>
		Flexible, electroconductive angled nozzle, DN 40, length: 800 mm.	

■ Included in delivery. □ Available accessories.

EQUIPMENT FOR IVR-L 65/12-1 TC 9.986-055.0



	Order no.	Description	
NOZZLES			
Standard nozzles bendable			
Standard nozzle, flexible, angled 90° PP DN50	29 9.981-430.0	Flexible, electroconductive angled nozzle, DN 50, length: 800 mm.	<input type="checkbox"/>
Floor nozzles			
Floor nozzle Alu 370 mm DN40	30 9.989-683.0		<input type="checkbox"/>
Floor nozzle Alu el 370 mm DN40	31 9.989-682.0		<input type="checkbox"/>
Aluminium floor nozzle 200 mm DN50	32 9.981-426.0	Floor nozzle, DN 50, with 200 mm suction width.	<input type="checkbox"/>
Floor nozzle Alu 370 mm DN50	33 9.989-664.0		<input type="checkbox"/>
Multi-purpose nozzle 370mm el. leit., DN	34 9.987-612.0		<input type="checkbox"/>
Floor nozzle Alu 500 mm DN50	35 9.989-684.0		<input type="checkbox"/>
Aluminium floor nozzle, el, 500 mm, DN50	36 9.981-925.0	Floor nozzle with 500 mm suction width and hinge. DN 50, electroconductive.	<input type="checkbox"/>
Multi-purpose nozzle 370mm el. leit., DN	37 9.989-558.0		<input type="checkbox"/>
	38 9.988-115.0		<input type="checkbox"/>
Floor nozzle rubber strip oil-resistant. 220 mm	39 9.981-923.0	Squeegee with plastic strip for floor nozzle, 220 mm wide.	<input type="checkbox"/>
Rubber lips with molding 370mm	40 9.981-914.0		<input type="checkbox"/>
Floor nozzle rubber strip 500 mm	41 9.981-915.0	Oil-resistant squeegee with profiled strip for floor nozzle, 500 mm wide.	<input type="checkbox"/>
Bürstenleiste Satz elektr. leitend, für	42 9.984-939.0		<input type="checkbox"/>

Available accessories.

EQUIPMENT FOR IVR-L 65/12-1 TC 9.986-055.0

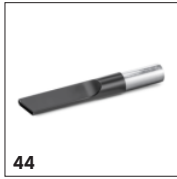
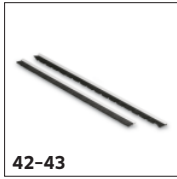

	Order no.	Description	
NOZZLES			
Floor nozzles			
Floor nozzle brush strip 500 mm	43	9.980-764.0	Brush strip set for floor nozzle 500 mm, with profiled strip. <input type="checkbox"/>
Crevice nozzles			
Crevice nozzle, lightweight plastic	44	9.988-117.0	<input type="checkbox"/>
Crevice nozzle PU 22 mm × 175 mm DN50	45	9.981-482.0	Crevice nozzle made from PU, DN 50. <input type="checkbox"/>
Crevice nozzle 18 mm × 120 mm DN50	46	9.981-442.0	Electroconductive crevice nozzle made from sheet steel, DN 50, with 17 mm slot width. <input type="checkbox"/>
Crevice nozzle 25 mm × 120 mm DN50	47	9.981-465.0	Electroconductive crevice nozzle made from sheet steel, DN 50, with 25 mm slot width. <input type="checkbox"/>
Crevice nozzles bendable			
Nozzle Langschaft Silikon DN52	48	9.988-403.0	<input type="checkbox"/>
Nozzle Crevice nozzle bendable 11 mm × 5	49	9.989-681.0	<input type="checkbox"/>
Crevice nozzle, zinc coated, flexible	50	9.981-423.0	<input type="checkbox"/>
Flexible crevice nozzle 12 mm × 45 mm DN50	51	9.981-424.0	Flexible, electroconductive galvanised crevice nozzle, DN 50, with 13 mm slot width. <input type="checkbox"/>
Crevice nozzle, zinc coated, flexible	52	9.981-425.0	<input type="checkbox"/>
Surface nozzles			
Nozzle with connecting piece 90° DN40	53	9.988-118.0	<input type="checkbox"/>
Nozzle with connecting piece 90° DN50	54	9.988-119.0	<input type="checkbox"/>
Nozzle Surface nozzle Alu 150 mm DN40	55	9.989-666.0	<input type="checkbox"/>
Nozzle Surface nozzle Alu 150 mm DN50	56	9.989-665.0	<input type="checkbox"/>

Available accessories.

EQUIPMENT FOR IVR-L 65/12-1 TC 9.986-055.0



	Order no.	Description	
NOZZLES			
Liquid nozzles			
Liquid nozzle 900 mm DN50	57	9.981-427.0	Bypass nozzle, DN 50, overall length: 1000 mm. <input type="checkbox"/>
Blind hole nozzles			
Nozzle Blind hole nozzle DN40	58	9.989-671.0	<input type="checkbox"/>
Nozzle Blind hole nozzle bended 60° DN40	59	9.989-669.0	<input type="checkbox"/>
Nozzle Blind hole nozzle bended 90° DN40	60	9.989-667.0	<input type="checkbox"/>
Nozzle Blind hole nozzle bended 90° 200	61	9.989-670.0	<input type="checkbox"/>
BRUSHES			
Standard brushes			
Standard brush 40 mm DN40	62	9.981-431.0	Flat brush nozzle DN 40. <input type="checkbox"/>
Standard brush 40 mm DN50	63	9.981-432.0	Flat brush nozzle DN 50. <input type="checkbox"/>
Pencil brushes			
Brush ø82 mm DN40	64	9.989-609.0	<input type="checkbox"/>
Brush ø82 mm DN50	65	9.989-608.0	<input type="checkbox"/>
Surface brushes			
Brush PP 24 mm DN40	66	9.989-610.0	<input type="checkbox"/>
Vacuum brush	67	9.981-911.0	<input type="checkbox"/>
	68	9.981-912.0	<input type="checkbox"/>
HOSES			
EVA			
Extension hose EVA el. DN42 3m	69	9.988-088.0	<input type="checkbox"/>
Extension hose EVA el. DN42 5m	70	9.988-089.0	<input type="checkbox"/>

Available accessories.

EQUIPMENT FOR IVR-L 65/12-1 TC 9.986-055.0



	Order no.	Description	
HOSES			
ME			
Hose connection kit DN40	71	9.989-627.0	<input type="checkbox"/>
PU			
Hose PU DN40 3 m	72	9.989-617.0	<input type="checkbox"/>
Hose PU DN40 5 m	73	9.989-618.0	<input type="checkbox"/>
Hose without connection PU DN40 15 m	74	9.989-637.0	<input type="checkbox"/>
ME-PU			
Hose ME-PU DN40 3 m	75	9.989-621.0	<input type="checkbox"/>
	76	9.989-622.0	<input type="checkbox"/>
Hose without connection ME-PU DN40 15 m	77	9.989-640.0	<input type="checkbox"/>
ADAPTERS / REDUCERS / DISTRIBUTORS			
Adapter Accessory			
Adapter DN50/DN51	78	9.989-603.0	<input type="checkbox"/>
Adapter DN51/DN50	79	9.989-601.0	<input type="checkbox"/>
Adapter DN50/DN61	80	9.989-602.0	<input type="checkbox"/>
Adapter DN61/DN50	81	9.989-604.0	<input type="checkbox"/>
Reducers			
Reduction DN50 to DN40	82	9.981-231.0	Reducer from DN 50 to DN 40. Material: Steel. Electroconductive. <input type="checkbox"/>
Expanders			
Expansion DN40 to DN50	83	9.981-936.0	Reducer from external cone DN 40 to internal cone DN 50. Material: Steel. Electroconductive. <input type="checkbox"/>
Expansion DN50 to DN70	84	9.981-921.0	Reducer from external cone DN 50 to internal cone DN 70. Material: Steel. Electroconductive. <input type="checkbox"/>

Available accessories.

EQUIPMENT FOR IVR-L 65/12-1 TC 9.986-055.0



85



86



87



88



89



90



91-94

	Order no.	Description		
ADAPTERS / REDUCERS / DISTRIBUTORS				
Distributors				
Y-adapter ID 52 to 2 × ID 42	85	9.981-149.0	<input type="checkbox"/>	
EMPTYING SUPPORTS				
Shaving baskets				
Swarf basket, 20 l	86	9.980-852.0	<input type="checkbox"/>	
Other emptying supports				
Float insert	87	9.982-118.0	<input type="checkbox"/>	
Fine fleece				
Filter fine fleece PE 20 l	88	9.989-612.0	<input type="checkbox"/>	
PRE-SEPARATORS				
Pre-separators				
Separator Tc Op Liquid 125 l DN70	89	9.989-686.0	<input type="checkbox"/>	
Pre-separator tank 200 l	90	9.989-685.0	<input type="checkbox"/>	
Pre-separator covers				
Pre-separator cover Op liquids ø 517 mm DN70	91	9.981-666.0	Pre-separator cover DN 70. Suitable for containers with 517 mm diameter.	<input type="checkbox"/>
Pre-separator cover Op liquids ø 575 mm DN70	92	9.981-662.0	Pre-separator cover DN 70 for 200 litre standard drum (9.989-685.0).	<input type="checkbox"/>
Pre-separator cover solid materials ø 517 mm DN70	93	9.981-665.0	Pre-separator cover DN 70. Suitable for containers with 517 mm diameter.	<input type="checkbox"/>
Pre-separator cover solid materials ø 575 mm DN70	94	9.981-661.0	Pre-separator cover DN 70 for 200 litre standard drum (9.989-685.0).	<input type="checkbox"/>

Available accessories.