

## IVR 40/15 SC

The IVR 40/15 Sc: Industrial vacuum cleaner for long work cycles. Vacuums up fine, combustible dusts in production areas and on machines. For installation in non-explosive areas.



### Order no.

9.986-066.0

- Cyclone-like pre-separation system
- Sound-damping
- Safe accessory storage

### Technical data

EAN code		4054278030067
Current type	Ph / V / Hz	3 / 400 / 50
Air flow	l/s / m³/h	58 / 210
Vacuum	mbar / kPa	200 / 20
Container content	l	40
Container material		Metal
Rated input power	kW	1.5
Vacuumping type		Electric
Nominal size		ID 50
Accessory nominal size		ID 50 / ID 40
Sound pressure level	dB(A)	57
Main filter dust class		M
Filter area for main filter	m²	1.75
Weight without accessories	kg	113
Weight incl. packaging	kg	113
Dimensions (L × W × H)	mm	890 × 670 × 1560

Users must receive training on this device.

### Equipment

Main filter	pocket filter
Accessories included with machine	no
Container emptying	Set down chassis

■ Included in delivery.

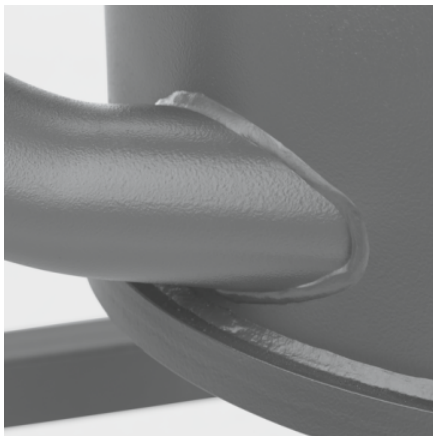

## Particularly robust, particularly flexible

- With practical, movable suction hose port/pipe bend.
- Despite its very compact design, it features numerous options for carrying accessories.
- Machine and chassis very robust and equipped with high wall thicknesses.



## Wear-resistant side channel compressor

- With 1.5 kW power and soft start-up for vacuuming small amounts of dust and solid materials.
- For strong suction power and service life of at least 20,000 hours.
- Optimally suited for mobile use in multiple shift operation.



## Convenient, manual filter cleaning

- Effortless operation by means of an ergonomically placed lever if required.
- Extends the life of the filter and thus reduces the maintenance effort.
- Identical cleaning results, regardless of the amount of force used.

## EQUIPMENT FOR IVR 40/15 SC

### 9.986-066.0



		Order no.	Description	
<b>FILTERS</b>				
<b>Pocket- / Star filters</b>				
Pocket filter	1	9.981-681.0		■
<b>Surface filters</b>				
Flat filter antistatic 0,45 m² Kat. "L"	2	9.980-180.0		□
<b>ACCESORY SETS</b>				
<b>Solid / Dust</b>				
Kit dust 3 m DN40	3	9.989-659.0		□
Kit solid dust DN50	4	9.989-662.0		□
<b>NOZZLES</b>				
<b>Standard nozzles</b>				
Standard nozzle PVC DN40	5	9.989-674.0		□
Standard nozzle PVC DN50	6	9.989-673.0		□
Nozzle elastic silicon DN42	7	9.988-401.0		□
Nozzle elastic silicon DN52	8	9.988-402.0		□
Standard nozzle rubber cuttable DN40	9	9.989-677.0		□
Standard nozzle rubber cuttable DN50	10	9.989-675.0		□
Standard aluminium nozzle DN40	11	9.980-748.0	Diagonal nozzle made from anodised aluminium, electroconductive, DN 40.	□
Standard aluminium nozzle DN50	12	9.980-749.0	Diagonal nozzle made from anodised aluminium, electroconductive, DN 50.	□
<b>Standard nozzles bendable</b>				
Nozzle, zinc coated, flexible, with rubber tip	13	9.981-420.0		□
	14	9.981-421.0		□

■ Included in delivery. □ Available accessories.

## EQUIPMENT FOR IVR 40/15 SC

### 9.986-066.0



		Order no.	Description	
<b>NOZZLES</b>				
<b>Standard nozzles bendable</b>				
Standard nozzle, flexible, angled 90° PP DN40	15	9.981-429.0	Flexible, electroconductive angled nozzle, DN 40, length: 800 mm.	<input type="checkbox"/>
Standard nozzle, flexible, angled 90° PP DN50	16	9.981-430.0	Flexible, electroconductive angled nozzle, DN 50, length: 800 mm.	<input type="checkbox"/>
<b>Floor nozzles</b>				
Floor nozzle Alu 370 mm DN40	17	9.989-683.0		<input type="checkbox"/>
Floor nozzle Alu el 370 mm DN40	18	9.989-682.0		<input type="checkbox"/>
Aluminium floor nozzle 200 mm DN50	19	9.981-426.0	Floor nozzle, DN 50, with 200 mm suction width.	<input type="checkbox"/>
Floor nozzle Alu 370 mm DN50	20	9.989-664.0		<input type="checkbox"/>
Multi-purpose nozzle 370mm el. leit., DN	21	9.987-612.0		<input type="checkbox"/>
Floor nozzle Alu 500 mm DN50	22	9.989-684.0		<input type="checkbox"/>
Aluminium floor nozzle, el, 500 mm, DN50	23	9.981-925.0	Floor nozzle with 500 mm suction width and hinge. DN 50, electroconductive.	<input type="checkbox"/>
Multi-purpose nozzle 370mm el. leit., DN	24	9.989-558.0		<input type="checkbox"/>
	25	9.988-115.0		<input type="checkbox"/>
Floor nozzle rubber strip oil-resistant. 220 mm	26	9.981-923.0	Squeegee with plastic strip for floor nozzle, 220 mm wide.	<input type="checkbox"/>
Rubber lips with molding 370mm	27	9.981-914.0		<input type="checkbox"/>
Floor nozzle rubber strip 500 mm	28	9.981-915.0	Oil-resistant squeegee with profiled strip for floor nozzle, 500 mm wide.	<input type="checkbox"/>

■ Included in delivery.    □ Available accessories.

## EQUIPMENT FOR IVR 40/15 SC

### 9.986-066.0

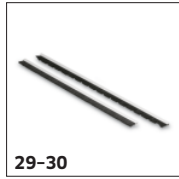

29-30



31-32



33-34



35-38

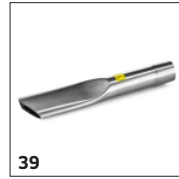

39

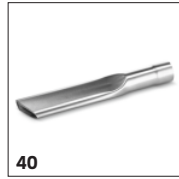

40



41



42-43, 45

		Order no.	Description	
<b>NOZZLES</b>				
<b>Floor nozzles</b>				
Bürstenleiste Satz elektr. leitend, für	29	9.984-939.0		<input type="checkbox"/>
Floor nozzle brush strip 500 mm	30	9.980-764.0	Brush strip set for floor nozzle 500 mm, with profiled strip.	<input type="checkbox"/>
<b>Crevice nozzles</b>				
Crevice nozzle, lightweight plastic	31	9.988-116.0		<input type="checkbox"/>
	32	9.988-117.0		<input type="checkbox"/>
Crevice nozzle PU 19 mm × 160 mm DN40	33	9.981-483.0	Crevice nozzle made from PU, DN 40.	<input type="checkbox"/>
Crevice nozzle PU 22 mm × 175 mm DN50	34	9.981-482.0	Crevice nozzle made from PU, DN 50.	<input type="checkbox"/>
Nozzle Crevice nozzle 17 mm × 120 mm DN4	35	9.989-680.0		<input type="checkbox"/>
Nozzle Crevice nozzle 25 mm × 120 mm DN4	36	9.989-678.0		<input type="checkbox"/>
Crevice nozzle 18 mm × 120 mm DN50	37	9.981-442.0	Electroconductive crevice nozzle made from sheet steel, DN 50, with 17 mm slot width.	<input type="checkbox"/>
Crevice nozzle 25 mm × 120 mm DN50	38	9.981-465.0	Electroconductive crevice nozzle made from sheet steel, DN 50, with 25 mm slot width.	<input type="checkbox"/>
Crevice nozzle slot nozzle V2A AK DN40	39	9.989-193.0		<input type="checkbox"/>
Crevice nozzle slot nozzle V2A AK DN50	40	9.988-123.0		<input type="checkbox"/>
<b>Crevice nozzles bendable</b>				
Nozzle Langschaft Silikon DN52	41	9.988-403.0		<input type="checkbox"/>
Nozzle Crevice nozzle bendable 11 mm × 5	42	9.989-681.0		<input type="checkbox"/>

☐ Available accessories.

## EQUIPMENT FOR IVR 40/15 SC

### 9.986-066.0



		Order no.	Description	
<b>NOZZLES</b>				
<b>Crevice nozzles bendable</b>				
Crevice nozzle, zinc coated, flexible	43	9.981-423.0		<input type="checkbox"/>
Flexible crevice nozzle 12 mm × 45 mm DN50	44	9.981-424.0	Flexible, electroconductive galvanised crevice nozzle, DN 50, with 13 mm slot width.	<input type="checkbox"/>
Crevice nozzle, zinc coated, flexible	45	9.981-425.0		<input type="checkbox"/>
<b>Surface nozzles</b>				
Nozzle with connecting piece 90° DN40	46	9.988-118.0		<input type="checkbox"/>
Nozzle with connecting piece 90° DN50	47	9.988-119.0		<input type="checkbox"/>
Nozzle Surface nozzle Alu 150 mm DN40	48	9.989-666.0		<input type="checkbox"/>
Nozzle Surface nozzle Alu 150 mm DN50	49	9.989-665.0		<input type="checkbox"/>
<b>Blind hole nozzles</b>				
Nozzle Blind hole nozzle DN40	50	9.989-671.0		<input type="checkbox"/>
Nozzle Blind hole nozzle bended 60° DN40	51	9.989-669.0		<input type="checkbox"/>
Nozzle Blind hole nozzle bended 90° DN40	52	9.989-667.0		<input type="checkbox"/>
Nozzle Blind hole nozzle bended 90° 200	53	9.989-670.0		<input type="checkbox"/>
<b>BRUSHES</b>				
<b>Standard brushes</b>				
Standard brush 40 mm DN40	54	9.981-431.0	Flat brush nozzle DN 40.	<input type="checkbox"/>
Standard brush 40 mm DN50	55	9.981-432.0	Flat brush nozzle DN 50.	<input type="checkbox"/>
<b>Pencil brushes</b>				
Brush ø82 mm DN40	56	9.989-609.0		<input type="checkbox"/>

☐ Available accessories.

EQUIPMENT FOR IVR 40/15 SC  
9.986-066.0



		Order no.	Description	
BRUSHES				
Pencil brushes				
Brush ø82 mm DN50	57	9.989-608.0		<input type="checkbox"/>
Surface brushes				
Brush PP 24 mm DN40	58	9.989-610.0		<input type="checkbox"/>
Vacuum brush	59	9.981-911.0		<input type="checkbox"/>
	60	9.981-912.0		<input type="checkbox"/>
HOSES				
PVC				
Hose PVC DN40 3 m	61	9.989-647.0		<input type="checkbox"/>
Hose PVC DN40 5 m	62	9.989-614.0		<input type="checkbox"/>
Hose without connection PVC DN40 15 m	63	9.989-633.0		<input type="checkbox"/>
Hose PVC DN50 3 m	64	9.989-615.0		<input type="checkbox"/>
Hose PVC DN50 5 m	65	9.989-616.0		<input type="checkbox"/>
Hose without connection PVC DN50 15 m	66	9.989-634.0		<input type="checkbox"/>
EVA				
Extension hose EVA el. DN42 3m	67	9.988-088.0		<input type="checkbox"/>
Extension hose EVA el. DN42 5m	68	9.988-089.0		<input type="checkbox"/>
Hose without connection EVA DN40 15 m	69	9.989-630.0		<input type="checkbox"/>
Extension hose EVA el. DN52 3m	70	9.988-090.0		<input type="checkbox"/>

☐ Available accessories.



EQUIPMENT FOR IVR 40/15 SC  
9.986-066.0

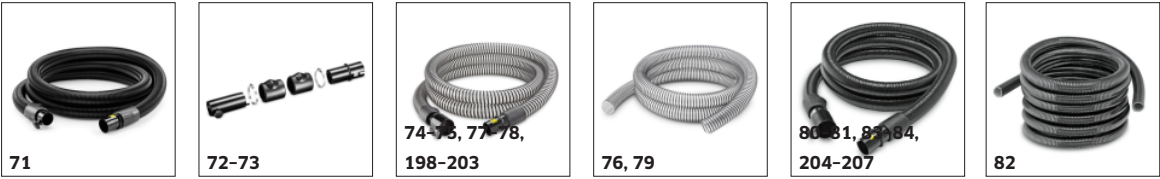

		Order no.	Description	
HOSES				
EVA				
Extension hose EVA el. DN52 5m	71	9.988-091.0		<input type="checkbox"/>
ME				
Hose connection kit DN40	72	9.989-627.0		<input type="checkbox"/>
Hose connection kit DN50	73	9.989-628.0		<input type="checkbox"/>
PU				
Hose PU DN40 3 m	74	9.989-617.0		<input type="checkbox"/>
Hose PU DN40 5 m	75	9.989-618.0		<input type="checkbox"/>
Hose without connection PU DN40 15 m	76	9.989-637.0		<input type="checkbox"/>
Hose PU DN50 3 m	77	9.989-619.0		<input type="checkbox"/>
Hose PU DN50 5 m	78	9.989-620.0		<input type="checkbox"/>
Hose without connection PU DN50 15 m	79	9.989-638.0		<input type="checkbox"/>
ME-PU				
Hose ME-PU DN40 3 m	80	9.989-621.0		<input type="checkbox"/>
	81	9.989-622.0		<input type="checkbox"/>
Hose without connection ME-PU DN40 15 m	82	9.989-640.0		<input type="checkbox"/>
Hose ME-PU DN50 3 m	83	9.989-623.0		<input type="checkbox"/>
Hose ME-PU DN50 5 m	84	9.989-625.0		<input type="checkbox"/>

☐ Available accessories.



## EQUIPMENT FOR IVR 40/15 SC

### 9.986-066.0



		Order no.	Description	
<b>HOSES</b>				
<b>ME-PU</b>				
Hose without connection ME-PU DN50 15 m	85	9.989-641.0		<input type="checkbox"/>
<b>HANDLES</b>				
Elbow aluminium 45° DN40	86	9.989-544.0		<input type="checkbox"/>
Elbow aluminium 45° DN50	87	9.989-547.0		<input type="checkbox"/>
Hand grip curved 45°, DN 42	88	9.977-679.0		<input type="checkbox"/>
Hand grip 45°, DN 52 ohne Sterngriff	89	9.977-678.0		<input type="checkbox"/>
Hand grip curved stainless steel 45°IK D	90	9.989-036.0		<input type="checkbox"/>
Hand grip curved stainless steel 45°, IK	91	9.988-111.0		<input type="checkbox"/>
<b>SUCTION TUBES</b>				
Suction tube carbon 1500mm DN40	92	9.989-552.0		<input type="checkbox"/>
Suction tube carbon 1500mm DN50	93	9.989-553.0		<input type="checkbox"/>
Suction tube 750 mm DN40	94	9.977-525.0		<input type="checkbox"/>
Extension pipe 850mm DN 50, SBG	95	9.977-531.0		<input type="checkbox"/>
Extension pipe stainless steel DN50 US	96	9.989-038.0		<input type="checkbox"/>
Hand grip curved stainless steel 45°IK D	97	9.989-035.0		<input type="checkbox"/>
Extension pipe stainless steel DN40 US	98	9.989-039.0		<input type="checkbox"/>

☐ Available accessories.

## EQUIPMENT FOR IVR 40/15 SC

### 9.986-066.0



		Order no.	Description	
<b>SUCTION TUBES</b>				
Extension pipe stainless steel DN50 IK,	99	9.988-114.0		<input type="checkbox"/>
<b>ADAPTERS / REDUCERS / DISTRIBUTORS</b>				
<b>Adapter Accessory</b>				
Adapter DN50/DN51	100	9.989-603.0		<input type="checkbox"/>
Adapter DN51/DN50	101	9.989-601.0		<input type="checkbox"/>
Adapter DN50/DN61	102	9.989-602.0		<input type="checkbox"/>
Adapter DN61/DN50	103	9.989-604.0		<input type="checkbox"/>
<b>Reducers</b>				
Reducer DN 70/DN 50 (SBG)	104	9.977-772.0		<input type="checkbox"/>
Reducer DN70/DN40	105	9.989-690.0		<input type="checkbox"/>
Reduction DN50 to DN40	106	9.981-231.0	Reducer from DN 50 to DN 40. Material: Steel. Electroconductive.	<input type="checkbox"/>
Reducer V2A DN72 auf DN52	107	9.989-712.0		<input type="checkbox"/>
Reducer V2A DN70/DN40	108	9.989-713.0		<input type="checkbox"/>
<b>Expanders</b>				
Expansion DN50 to DN70	109	9.981-921.0	Reducer from external cone DN 50 to internal cone DN 70. Material: Steel. Electroconductive.	<input type="checkbox"/>
<b>Distributors</b>				
Distributor DN70/DN50/DN50	110	9.989-611.0		<input type="checkbox"/>
Y-adapter ID 52 to 2 × ID 42	111	9.981-149.0		<input type="checkbox"/>
<b>EMPTYING SUPPORTS</b>				
<b>Disposal bag holders</b>				
Blank holder for round bottom bag 30L	112	9.980-126.0		<input type="checkbox"/>

☐ Available accessories.

## EQUIPMENT FOR IVR 40/15 SC

### 9.986-066.0

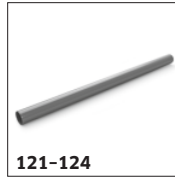

		Order no.	Description	
PRE-SEPARATORS				
Pre-separators				
Pre-separator station	113	9.982-238.0	Mobile pre-separator station with 110 l volume and emptying flap.	<input type="checkbox"/>
Pre-separator tank dust 60 l DN40	114	9.989-687.0		<input type="checkbox"/>
Pre-separator tank dust 60 l DN50	115	9.989-688.0		<input type="checkbox"/>
Pre-separator tank 200 l	116	9.989-685.0		<input type="checkbox"/>
Pre-separator covers				
Pre-separator cover Op liquids ø 517 mm DN70	117	9.981-666.0	Pre-separator cover DN 70. Suitable for containers with 517 mm diameter.	<input type="checkbox"/>
Pre-separator cover Op liquids ø 575 mm DN70	118	9.981-662.0	Pre-separator cover DN 70 for 200 litre standard drum (9.989-685.0).	<input type="checkbox"/>
Pre-separator cover solid materials ø 517 mm DN70	119	9.981-665.0	Pre-separator cover DN 70. Suitable for containers with 517 mm diameter.	<input type="checkbox"/>
Pre-separator cover solid materials ø 575 mm DN70	120	9.981-661.0	Pre-separator cover DN 70 for 200 litre standard drum (9.989-685.0).	<input type="checkbox"/>
ACCESSORIES STATIONARY				
IV pipes				
IV pipe Ø 42.4 mm	121	9.980-451.0		<input type="checkbox"/>
IV pipe Ø 60 mm	122	9.980-452.0		<input type="checkbox"/>
IV pipe Ø 75 mm	123	9.980-453.0		<input type="checkbox"/>
IV pipe Ø 100 mm	124	9.980-455.0		<input type="checkbox"/>
IV pipe elbow 30° Ø 60.3 mm	125	9.980-545.0		<input type="checkbox"/>
IV pipe elbow 30° Ø 76.1 mm	126	9.980-546.0		<input type="checkbox"/>

☐ Available accessories.

## EQUIPMENT FOR IVR 40/15 SC 9.986-066.0

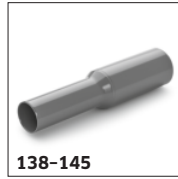
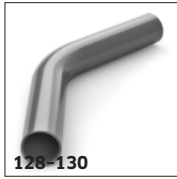

		Order no.	Description	
<b>ACCESSORIES STATIONARY</b>				
<b>IV pipes</b>				
IV pipe elbow 30° Ø 101.6 mm	127	9.980-547.0		<input type="checkbox"/>
IV pipe elbow 45° Ø 60.3 mm	128	9.980-548.0		<input type="checkbox"/>
IV pipe elbow 45° Ø 76.1 mm	129	9.980-549.0		<input type="checkbox"/>
IV pipe elbow 45° Ø 101.6 mm	130	9.980-550.0		<input type="checkbox"/>
IV pipe elbow 60° Ø 60.3 mm	131	9.980-551.0		<input type="checkbox"/>
IV pipe elbow 60° Ø 76.1 mm	132	9.980-552.0		<input type="checkbox"/>
IV pipe elbow 60° Ø 60.3 mm	133	9.980-553.0		<input type="checkbox"/>
IV pipe elbow 90° Ø 42.4 mm	134	9.985-373.0	Pipe elbow, hardened, made from coated steel with 2.6 mm wall thickness and 90° bend.	<input type="checkbox"/>
IV pipe elbow 90° Ø 60.3 mm	135	9.980-554.0		<input type="checkbox"/>
IV pipe elbow 90° Ø 76.1 mm	136	9.980-555.0		<input type="checkbox"/>
IV pipe elbow 90° Ø 101.6 mm	137	9.980-556.0		<input type="checkbox"/>
IV pipe reduction Ø 120 mm to 100 mm	138	9.981-335.0	Reducer, painted, made from steel with 2 mm wall thickness. For reduction from 120 to 100 mm diameter. Length: 350 mm.	<input type="checkbox"/>
IV pipe reduction Ø 120 mm to 60 mm	139	9.981-337.0	Reducer, painted, made from steel with 2 mm wall thickness. For reduction from DN 120 to DN 70. Length: 350 mm.	<input type="checkbox"/>
IV pipe reduction Ø 100 mm to 75 mm	140	9.981-334.0	Steel reducer with 2 mm wall thickness for reduction from 100 to 75 mm diameter. Length: 350 mm.	<input type="checkbox"/>

☐ Available accessories.

## EQUIPMENT FOR IVR 40/15 SC

### 9.986-066.0



		Order no.	Description	
<b>ACCESSORIES STATIONARY</b>				
<b>IV pipes</b>				
IV pipe reduction Ø 100 mm to 60 mm	141	9.981-336.0	Steel reducer with 2 mm wall thickness for reduction from 100 to 60 mm diameter. Length: 350 mm.	<input type="checkbox"/>
IV pipe reduction Ø 80 mm to 75 mm	142	9.980-494.0		<input type="checkbox"/>
IV pipe reduction Ø 80 mm to 60 mm	143	9.980-493.0		<input type="checkbox"/>
IV pipe reduction Ø 75 mm to 60 mm	144	9.981-333.0	Reducer, painted, made from steel with 2 mm wall thickness. For reduction from 75 to 60 mm diameter. Length: 350 mm.	<input type="checkbox"/>
IV pipe reduction Ø 60 mm to 42.2 mm	145	9.981-228.0		<input type="checkbox"/>
IV pipe manifold 30° branch Ø 120 mm to 100 mm	146	9.981-129.0		<input type="checkbox"/>
IV pipe manifold 30° branch Ø 120 mm to 75 mm	147	9.981-127.0		<input type="checkbox"/>
IV pipe manifold 30° branch Ø 100 mm to 75 mm	148	9.981-126.0		<input type="checkbox"/>
IV pipe manifold 30° branch Ø 100 mm to 60 mm	149	9.981-124.0		<input type="checkbox"/>
IV pipe manifold 30° branch Ø 75 mm to 60 mm	150	9.981-123.0		<input type="checkbox"/>
IV pipe manifold 30° branch Ø 60 mm to 42.4 mm	151	9.981-258.0	Pipe branch, 600 mm long, made from steel with 30° bend and 2 mm wall thickness. Diameter: 60/60/42.4 mm.	<input type="checkbox"/>
IV pipe manifold 30° branch Ø 120 mm	152	9.981-130.0		<input type="checkbox"/>
IV pipe manifold 30° branch Ø 100 mm	153	9.981-128.0		<input type="checkbox"/>
IV pipe manifold 30° branch Ø 75 mm	154	9.981-125.0		<input type="checkbox"/>

☐ Available accessories.

## EQUIPMENT FOR IVR 40/15 SC

### 9.986-066.0



		Order no.	Description	
<b>ACCESSORIES STATIONARY</b>				
<b>IV pipes</b>				
IV pipe manifold 30° branch Ø 60 mm	155	9.981-122.0		<input type="checkbox"/>
IV pipe manifold 30° branch Ø 42.4 mm	156	9.981-259.0	Pipe branch, 600 mm long, made from steel with 30° bend and 2 mm wall thickness. Diameter: 42.4/42.4/42.4 mm.	<input type="checkbox"/>
IV pipe manifold Y-piece Ø 120 mm to 100 mm	157	9.981-135.0		<input type="checkbox"/>
IV pipe manifold Y-piece Ø 100 mm to 75 mm	158	9.981-134.0		<input type="checkbox"/>
IV pipe manifold Y-piece Ø 80 mm to 60 mm	159	9.981-133.0		<input type="checkbox"/>
IV pipe manifold Y-piece Ø 75 mm to 60 mm	160	9.981-132.0		<input type="checkbox"/>
IV pipe manifold Y-piece Ø 60 mm to 42 mm	161	9.981-131.0		<input type="checkbox"/>
<b>IV pipe connections / clamps</b>				
IV pipe coupling Ø 42.4 mm	162	9.980-445.0		<input type="checkbox"/>
IV pipe coupling Ø 60 mm	163	9.980-446.0		<input type="checkbox"/>
IV pipe coupling Ø 75 mm	164	9.980-447.0		<input type="checkbox"/>
IV pipe coupling Ø 100 mm	165	9.980-449.0		<input type="checkbox"/>
IV pipe clamp Ø 41 - 44 mm	166	9.980-463.0		<input type="checkbox"/>
IV pipe clamp Ø 60 - 63 mm	167	9.980-464.0		<input type="checkbox"/>
IV pipe clamp Ø 74 - 78 mm	168	9.980-465.0		<input type="checkbox"/>

☐ Available accessories.

## EQUIPMENT FOR IVR 40/15 SC

### 9.986-066.0



		Order no.	Description	
<b>ACCESSORIES STATIONARY</b>				
<b>IV pipe connections / clamps</b>				
IV pipe clamp Ø 99 - 103 mm	169	9.980-466.0		<input type="checkbox"/>
IV pipe clamp Ø 116 - 120 mm	170	9.980-467.0		<input type="checkbox"/>
IV pipe floor support	171	9.981-118.0		<input type="checkbox"/>
End piece internal cone DN40-ø42,4x2,0	172	9.981-256.0		<input type="checkbox"/>
IV pipe on hose adapter, female Ø 60 to DN50	173	9.981-166.0		<input type="checkbox"/>
IV pipe on hose adapter, female Ø 75 to DN70	174	9.981-170.0		<input type="checkbox"/>
IV pipe on hose adapter, male Ø 42.2 to DN40	175	9.981-257.0	Steel adapter with 2 mm wall thickness. For connecting pipe and hose, DN 40, to diameter 42.4 × 2.0 mm.	<input type="checkbox"/>
IV pipe on hose adapter, male Ø 60 to DN50	176	9.981-332.0	Steel reducer with 2 mm wall thickness. End piece with external cone DN 50 to diameter 60.0 × 2.0 mm.	<input type="checkbox"/>
IV pipe on hose adapter, male Ø 75 to DN70	177	9.981-195.0		<input type="checkbox"/>
<b>Suction point accessories</b>				
Suction point standard PVC nozzle DN40	178	9.981-454.0	Elastic nozzle DN 40 for jet cookers.	<input type="checkbox"/>
Suction point standard PVC nozzle DN50	179	9.981-455.0	Elastic nozzle DN 50 for jet cookers.	<input type="checkbox"/>
Suction point, standard brush DN40	180	9.981-436.0	Steel brush nozzle with 2.6 mm wall thickness for jet cookers, DN 40.	<input type="checkbox"/>
Suction point nozzle holder	181	9.981-520.0	For mounting intended nozzle holders made from steel to a wall. Suitable for nozzles with DN 40, DN 50 and DN 70.	<input type="checkbox"/>
Suction point nozzle holder with limit switch	182	9.982-111.0	Jet cookers with sensor, for wall mounting. Suitable for nozzles DN 40, DN 50 and DN 70.	<input type="checkbox"/>

☐ Available accessories.



## EQUIPMENT FOR IVR 40/15 SC

### 9.986-066.0

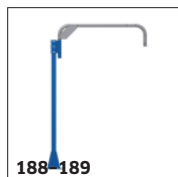
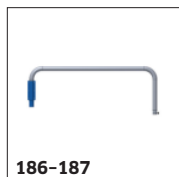

		Order no.	Description	
<b>ACCESSORIES STATIONARY</b>				
<b>Suction point accessories</b>				
Suction point hose hanger with limit switch ø 60 mm	183	9.982-083.0	Hose holder with limit switch for fastening to pipelines with 60 mm diameter.	<input type="checkbox"/>
Suction point hose hanger with limit switch ø 75 mm	184	9.982-092.0	Hose holder with limit switch for fastening to pipelines with 75 mm diameter.	<input type="checkbox"/>
Suction point hose hanger with limit switch	185	9.982-093.0	Hose holder with limit switch for wall mounting.	<input type="checkbox"/>
Suction point suction arm DN50 without hose	186	9.981-776.0	Swivel arm DN 50 with relevant wall mounting. Arm length: 2 m.	<input type="checkbox"/>
Suction point suction arm DN70 without hose	187	9.981-775.0	Swivel arm DN 70 with relevant wall mounting. Arm length: 2 m.	<input type="checkbox"/>
Suction point suction arm DN50 without hose	188	9.981-781.0	Swivel arm DN 50 with floor support (100 × 100 mm), arm length: 2 m.	<input type="checkbox"/>
Suction point suction arm DN70 without hose	189	9.981-780.0	Swivel arm DN 70 with floor support (100 × 100 mm), arm length: 2 m.	<input type="checkbox"/>
Suction point suction arm DN70	190	9.981-920.0	Suction arm DN 70 to DN 100, arm length: 2.5 m.	<input type="checkbox"/>
Suction point suction arm DN100	191	9.983-121.0	Suction arm DN 100, arm length: 2.5 m. Suction head with 150 mm diameter.	<input type="checkbox"/>
Suction point hose PVC DN40 3m	192	9.989-701.0		<input type="checkbox"/>
Suction point hose PVC DN40 5m	193	9.989-702.0		<input type="checkbox"/>
Suction point hose PVC DN50 3m	194	9.989-693.0		<input type="checkbox"/>
Suction point hose PVC DN50 5m	195	9.989-694.0		<input type="checkbox"/>
Suction point hose PVC DN70 3m	196	9.989-703.0		<input type="checkbox"/>

☐ Available accessories.

EQUIPMENT FOR IVR 40/15 SC  
9.986-066.0



		Order no.	Description	
ACCESSORIES STATIONARY				
Suction point accessories				
Suction point hose PVC DN70 5m	197	9.989-704.0		<input type="checkbox"/>
Suction point hose PU DN40 3m	198	9.989-705.0		<input type="checkbox"/>
Suction point hose PU DN40 5m	199	9.989-706.0		<input type="checkbox"/>
Suction point hose PU DN50 3m	200	9.989-695.0		<input type="checkbox"/>
Suction point hose PU DN50 5m	201	9.989-696.0		<input type="checkbox"/>
Suction point hose PU DN70 3m	202	9.989-707.0		<input type="checkbox"/>
Suction point hose PU DN70 5m	203	9.989-708.0		<input type="checkbox"/>
Suction point hose ME-PU DN40 3m	204	9.989-697.0		<input type="checkbox"/>
Suction point hose ME-PU DN40 5m	205	9.989-698.0		<input type="checkbox"/>
Suction point hose ME-PU DN50 3m	206	9.989-699.0		<input type="checkbox"/>
Suction point hose ME-PU DN50 5m	207	9.989-700.0		<input type="checkbox"/>
Hose connection rotatable DN40	208	9.989-654.0		<input type="checkbox"/>
Hose connection rotatable DN50	209	9.989-653.0		<input type="checkbox"/>
Hose connection rotatable DN70	210	9.989-652.0		<input type="checkbox"/>

☐ Available accessories.

## EQUIPMENT FOR IVR 40/15 SC

### 9.986-066.0



		Order no.	Description	
<b>ACCESSORIES STATIONARY</b>				
<b>Suction point accessories</b>				
Hose end piece, male DN40	211	9.981-142.0	Steel hose connection piece with 2 mm wall thickness and DN 40 external cone.	<input type="checkbox"/>
Hose end piece, male DN50	212	9.980-472.0		<input type="checkbox"/>
Hose end piece, male DN70	213	9.981-144.0	Steel hose connection piece with 2 mm wall thickness and DN 70 external cone.	<input type="checkbox"/>
Hose connection rotatable DN40 V2A	214	9.989-716.0		<input type="checkbox"/>
Tube rotatable ø54 V2A	215	9.989-714.0		<input type="checkbox"/>
Hose connection piece AK DN40 V2A	216	9.989-717.0		<input type="checkbox"/>
Hose connection outside cone DN50, V2A	217	9.989-715.0		<input type="checkbox"/>
Hose installation kit DN40 without end pieces	218	9.981-563.0	Installation kit for hose connections NW 40. Comprising 2 hose sleeves and pipe clamps.	<input type="checkbox"/>
Hose installation kit DN50 without end pieces	219	9.981-561.0	Installation kit for hose connections NW 50. Comprising 2 hose sleeves and pipe clamps.	<input type="checkbox"/>
Hose installation kit DN70 without end pieces	220	9.981-562.0	Installation kit for hose connections NW 70. Comprising 2 hose sleeves and pipe clamps.	<input type="checkbox"/>

☐ Available accessories.