

HG 43

Thanks to the efficient and low-emission burner technology with 43 kW heat output, our HG 43 hot water generator can convert all high-pressure cleaners into effective hot water machines.



RECORD HOLDER



Order no.

1.030-500.0

- Very efficient and low-emission burner technology
- Robust frame protects even in the toughest working conditions

Technical data

EAN code		4054278262611
Heating output	kW	43
Temperature (for supply 12 °C)	°C	max. 80
55 °C Δ T @	l/h	600
Weight without accessories	kg	88.1
Weight incl. packaging	kg	100.5
Dimensions (L × W × H)	mm	1000 × 850 × 1080



Durable and robust

- Highly efficient, tried-and-tested "Made in Germany" burner technology.
- Tried-and-tested Kärcher safety technology guarantees optimal protection of the machine and user.
- The sturdy pipe frame provides protection in continuous heavy-duty use.



Increased cleaning performance thanks to hot water

- Shorter cleaning times and reduction of labour costs.
- More effective removal of oils, greases and lubricants.
- Germ-killing effect and protection of sensitive surfaces.



Especially easy to maintain

- Easy access to all service and maintenance components.
- Integrated fuel filter and removable fuel tank for cleaning.

ACCESSORIES FOR HG 43

1.030-500.0

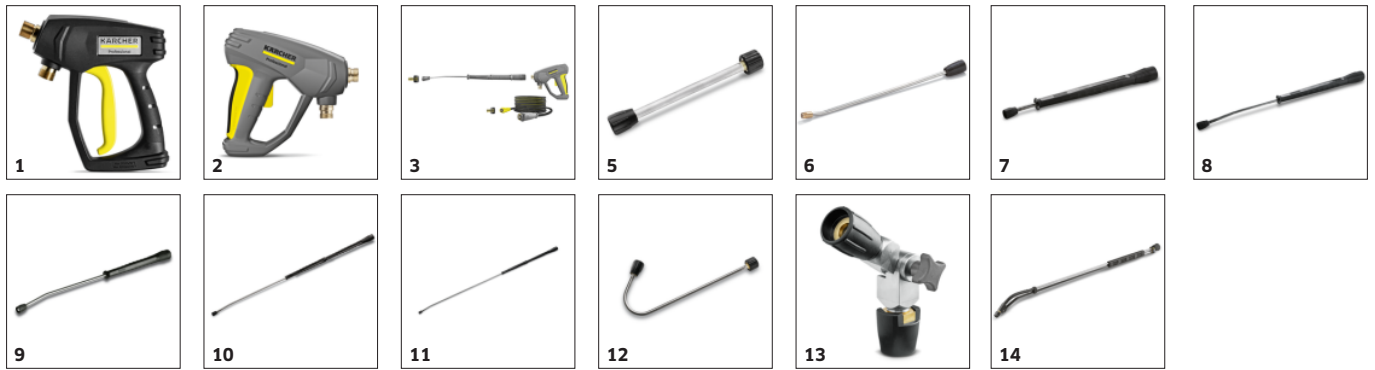

		Order no.	Description	
TRIGGER GUNS				
Spray guns				
Standard trigger gun	1	9.751-139.0	High-pressure gun for machines of the HD Classic range. With adapter for high-pressure hoses M 22 × 1.5.	■
EASY!Force Advanced	2	4.118-005.0	Effortless, not energy-sapping: the EASY!Force high-pressure gun uses the recoil force of the high-pressure jet to reduce the holding force for the operator to zero.	□
EASY!Force conversion kit 2 - from machine	3	4.111-051.0	Developed for retrofitting existing high-pressure cleaners from Kärcher: EASY!Force conversion kit 2 with EASY!Force high-pressure gun, spray lance, high-pressure hose and necessary adapters.	□
SPRAY LANCES				
Spray lance				
Spray lance 850 mm	4	9.751-044.0	The 600-mm long galvanised spray lance with hand screw connection is suitable for machines in the HD Classic range. The spray lance is not rotatable.	■
250 mm lance, non-rotatable	5	4.760-667.0	250 mm stainless steel lance. With manual coupling. Non-rotatable.	□
550 mm lance, non-rotatable	6	4.760-665.0	550 mm stainless steel lance. With manual coupling. Non-rotatable.	□
Rotating spray lances				
Spray lance, 600 mm, rotatable	7	4.760-664.0	600 mm stainless steel lance (manual coupling) with ergonomic handle for ease of use and protection. Rotatable 360° under pressure.	□
Spray lance, 840 mm, rotatable	8	4.760-663.0	850 mm stainless steel lance (manual coupling) with ergonomic handle for ease of use and protection. Rotatable 360° under pressure.	□
Spray lance, 1050 mm, rotatable	9	4.760-660.0	1050 mm stainless steel lance (manual coupling) with ergonomic handle for ease of use and protection. Rotatable 360° under pressure.	□
Spray lance, 1550 mm, rotatable	10	4.760-661.0	1550 mm stainless steel lance (manual coupling) with ergonomic handle for ease of use and protection. Rotatable 360° under pressure.	□
Spray lance, 2050 mm, rotatable	11	4.760-662.0	2050 mm stainless steel lance (manual coupling) with ergonomic handle for ease of use and protection. Rotatable 360° under pressure.	□
Angular spray lance				
Spray lance for toilets and rain gutters	12	4.760-073.0	Stainless steel lance WC and gutter with nozzle insert. Specially shaped for effective and hygienic cleaning of gutters and toilets.	□
Flexible spray lance				
High pressure articulated joint	13	4.481-039.0	High-pressure articulated joint: Thanks to infinite angle adjustment up to 120°, this tool is ideal to effortlessly clean hard-to-reach areas. Simply attach to the spray lance of the pressure washer.	□
Flexible lance, 1050 mm	14	6.394-654.0	1050 mm flexible lance with variable bend from 20° to 140°, ideal for cleaning difficult to reach areas, e.g. gutters.	□

■ Included in the scope of supply. □ Available accessories.

ACCESSORIES FOR HG 43

1.030-500.0



		Order no.	Description	
SPRAY LANCES				
Undercarriage spray lance				
Underbody lance	15	4.760-245.0	Stainless steel lance for effective and easy underbody and wheel arch cleaning. Without high-pressure nozzle.	<input type="checkbox"/>
WEED CONTROL				
WR 50	16	2.643-758.0	In combination with a hot water high-pressure cleaner from Kärcher, the 50 cm wide weed remover WR 50 is ideal for removing weeds. It comes with an adaptive chassis and nozzle adapter.	<input type="checkbox"/>
WR 20	17	2.643-760.0	For thorough weed removal: The WR 20 weed remover for use with a hot water high-pressure cleaner from Kärcher. Equipped with a 20 cm wide nozzle bar and nozzle adapter.	<input type="checkbox"/>
QUICK CONNECT				
Quick coupling	18	6.401-458.0	For fast changes between different spray lances/accessories. Perfect for Kärcher spray unit, suitable for trigger gun/spray lance interface. With M 22 × 1.5 internal thread.	<input type="checkbox"/>
Male coupling	19	6.401-459.0	Hardened stainless steel male coupling for quick coupling 6.401-458. With M 22 × 1.5 external thread.	<input type="checkbox"/>
DRUM AND TANK CLEANING				
Add-on kit mud sucker	20	2.641-798.0	For connection to the high-pressure hose of Kärcher high-pressure cleaners: Powerful sludge suction cleaner for the retrofitting of high-pressure cleaners to dirt pumps.	<input type="checkbox"/>
OTHER HP ACCESSORIES				
Starting current limiter	21	2.637-495.0	Reduces starting current in single-phase supply and protects line fuse.	<input type="checkbox"/>
DICHTUNGEN FÜR TR-GEWINDE				
Gasket set with 9x O-rings for TR thread	22	2.880-001.0		<input type="checkbox"/>
STEAM JET NOZZLE / NOZZLE PROTECTOR / ROLLOVER NOZZLE				
Rollover nozzle holder				
Owner of jets double brass	23	4.764-012.0	Rollover nozzle holder for contactless changeover from pencil jet to fan jet as well as low-pressure detergent injection via knurled nut. Without nozzle insert. (Additional type-specific power nozzle).	<input type="checkbox"/>
HIGH-PRESSURE HOSES				
Standard with unions on both sides				
High-pressure hose, 30 m, ID 8, 315 bar, 2 × M22 × 1.5	24	6.390-293.0	To extend the operating radius with the high-pressure cleaner. Connection on both sides M22 × 1.5.	<input type="checkbox"/>
High-pressure hose, 15 m, ID 10, 220 bar, 2 × M22 × 1.5	25	6.390-023.0	Connectors at both ends, M 22 × 1.5, with kink protection.	<input type="checkbox"/>
High-pressure hose, 20 m, ID 10, 220 bar, 2 × M22 × 1.5	26	6.390-726.0	with union on both sides, M 22 × 1.5 with anti-kink protection. NW 10/155°C/220 bar	<input type="checkbox"/>
High-pressure hose, 25 m, ID 10, 220 bar, 2 × M22 × 1.5	27	6.391-513.0		<input type="checkbox"/>
High-pressure hose, 15 m, ID 12, 210 bar, 2 × M22 × 1.5	28	6.391-849.0	High-pressure hose for water volumes greater than 1,800 l / h. With union on both sides. 2x M 22 × 1.5 with anti-kink protection.	<input type="checkbox"/>

■ Included in the scope of supply. □ Available accessories.

ACCESSORIES FOR HG 43

1.030-500.0



		Order no.	Description	
HIGH-PRESSURE HOSES				
Standard with unions on both sides				
High-pressure hose, 40 m, ID 12, 210 bar, 2 × M22 × 1.5	29	6.391-865.0	High-pressure hose for water volumes greater than 1,800 l / h. With union on both sides. 2x M 22 × 1.5 with anti-kink protection.	<input type="checkbox"/>
Longlife 400				
High-pressure hose Longlife, 20 m, ID 8, 400 bar, 1 × M22 × 1.5 / 1 × AVS-hose reel connection	30	6.390-208.0	20 m high-pressure hose Longlife 400 (DN 8) with patented (rotating) AVS trigger gun connector and manual coupling. Two layer high-strength steel wire reinforced.	<input type="checkbox"/>
Longlife 400 with unions on both sides				
High-pressure hose Longlife, 10 m, ID 8, 400 bar, 2 × M22 × 1.5	31	6.388-083.0	10 m high-pressure hose Longlife 400 (DN 8) with rotary coupling, two layer high-strength steel wire reinforced. Connectors at both ends. M 22 × 1.5, with kink protection.	<input type="checkbox"/>
High-pressure hose Longlife, 15 m, ID 8, 400 bar, 2 × M22 × 1.5	32	6.389-709.0	With rotary coupling, 2 × M 22 × 1.5	<input type="checkbox"/>
High-pressure hose Longlife, 20 m, ID 8, 400 bar, 2 × M22 × 1.5	33	6.390-027.0	with rotary coupling, 2 × M 22 × 1.5	<input type="checkbox"/>
High-pressure hose Longlife, 30 m, ID 8, 400 bar, 2 × M22 × 1.5	34	6.390-294.0	With rotary coupling, 2 × M 22 × 1.5	<input type="checkbox"/>
Longlife food design with screw connections at both ends				
High-pressure hose food grade, 10 m, ID 8, 400 bar, 2 × M22 × 1.5	35	6.391-864.0	Longlife HP hose for use in the food industry. Außendecke## animal-grease-resistant, non-colour-bleeding material. With rotary coupling, 2 × M 22 × 1,5	<input type="checkbox"/>
Special hoses				
High-pressure hose curved, 1.5 m, ID 8, 400 bar, 1 × M22 × 1.5 / 1 × AVS-hose reel connection	36	6.388-886.0	Connection hose in longlife quality with 2x M22 × 1.5, with angled connection on one side.	<input type="checkbox"/>
FLOOR AND HARD SURFACE CLEANER				
FR 30 Me surface cleaner				
Hard surface cleaner FR 30 Me	37	2.640-355.0	Hot water resistant stainless steel surface cleaner with double ceramic bearings, non-marking swivel castors and suction hose connection. Ideal for indoor cleaning, e.g. food industry.	<input type="checkbox"/>
FRV 30 Me surface cleaner				
FRV 30 Me	38	2.642-911.0	Thanks to automatic suction of the dirty water, the stainless steel FRV 30 Me Surface Cleaner makes surface cleaning more efficient in both inside and outside areas. Hot water cleaning up to 85°C.	<input type="checkbox"/>
Extension hose FRV 30 Me and FRV 50 Me	39	4.441-040.0	5 m extension hose for FRV 30 Me. Includes connecting adapter.	<input type="checkbox"/>
FOAM SYSTEMS				
Inno Foam Kit				
Inno Foam Set with detergent injector	40	2.640-151.0	High-pressure foam system with double lance (foam nozzle and high-pressure jet for rinsing). For use with mobile and stationary high-pressure and HDS pressure cleaners for cleaning or disinfection.	<input type="checkbox"/>
Inno Foam Set	41	2.640-692.0		<input type="checkbox"/>
Easy Foam Set				
Easy Foam Set with RM injector	42	2.640-691.0	HP foam system for use with. HD/HDS units for cleaning and disinfecting. Foam nozzle for connection to lance and HP chemical injector with precision 0-5% metering valve. The machine specific nozzle kit has to be ordered separately.	<input type="checkbox"/>

Available accessories.

ACCESSORIES FOR HG 43 1.030-500.0

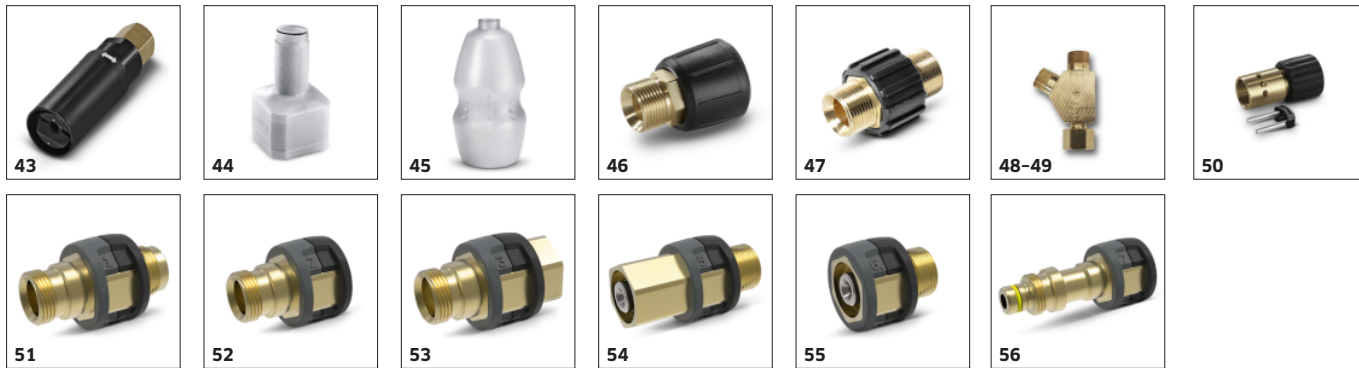

	Order no.	Description	
FOAM SYSTEMS			
Easy Foam Set			
Easy Foam Set	43	2.640-693.0 HP foam system for use with. HD/HDS units for cleaning and disinfecting. Foam nozzle for connection to lance and HP chemical injector with precision 0-5% metering valve. The machine specific nozzle kit has to be ordered separately.	<input type="checkbox"/>
Cup foam lance			
1-litre cleaning agent container for cup foam lance basic	44	5.071-414.0 For the quick change of the cleaning agent: Additional 1 litre cleaning agent container for basic foam lance (2.112-053.0, 2.112-054.0 and 2.112-055.0).	<input type="checkbox"/>
1-litre cleaning agent container for cup foam lance advanced	45	6.414-050.0 Additional 1-litre cleaning agent container for quick replacement of the cleaning agent (for foam lance 2.112-017.0 and 2.112-018.0).	<input type="checkbox"/>
COUPLING PARTS			
Rotary coupling			
Rotary coupling	46	4.401-091.0 Reliably prevents twisting of HP hoses. Connection M 22 × 1.5 m. Handle protection	<input type="checkbox"/>
Coupling			
Coupler -2 × M22 × 1,5	47	4.403-002.0 For connecting and extending high-pressure hoses. Connection 2 × M 22 × 1.5.	<input type="checkbox"/>
Connector			
Y distributor	48	4.405-048.0 Offers the option to connect two spray units to the machine. Installation on the high pressure outlet.	<input type="checkbox"/>
	49		4.111-024.0
Adapters			
Sealing cone complete	50	4.424-004.0 In order to install high-pressure hose with male coupling on thread with M22 × 1.5 Alternative:4.111-032.0 Adapter 4 - Device new / Hose old Swivel	<input type="checkbox"/>
EASY!Lock adapter			
Adapter 1 M22AG-TR22AG	51	4.111-029.0 Adapter 1 to connect the old hose with the new hose	<input type="checkbox"/>
Adapter 2 M22IG-TR22AG	52	4.111-030.0 Adapter 2 to connect the old device with the new hose and the old gun with the new hose	<input type="checkbox"/>
Adapter 3 M22IG-TR22AG	53	4.111-031.0 Adapter 3 to connect the old gun with the new spray lance and new servo regulator	<input type="checkbox"/>
Adapter 5 TR22IG-M22AG	54	4.111-033.0 Adapter 5 to connect the new gun with the old spray lance and new servo regulator with the old spray lance	<input type="checkbox"/>
Adapter 6 TR22IG-M22AG	55	4.111-034.0 Adapter 6 to connect the new device with the old hose and the old hose with the new gun	<input type="checkbox"/>
Adapter 7 M18IG-TR20AG	56	4.111-035.0 Adapter 7 to connect the old spray lance with the new nozzle	<input type="checkbox"/>

Available accessories.

ACCESSORIES FOR HG 43

1.030-500.0



		Order no.	Description	
COUPLING PARTS				
EASY!Lock adapter				
Adapter 8 TR20IG-M18AG	57	4.111-036.0	Adapter 8 to connect the new spray lance with the old nozzle	<input type="checkbox"/>
Adapter 12 rotary coupling EASY!Lock 22 IG - M22 x 1.8 AG	58	4.111-046.0	Rotatable adapter for connecting EASY!Force high-pressure gun and high-pressure hoses with M 22x1.5 connection	<input type="checkbox"/>
HOSE REELS				
Automatic, self-winding hose reels for wall mounting				
Automatic stainless steel hose reel, 20 m	59	6.391-520.0		<input type="checkbox"/>
Automatic stainless steel hose reel, 40 m	60	6.392-442.0	Automatic hose reels provide the highest level of safety and convenience for winding and unwinding HP hoses. Compatible high-pressure hose, e.g. order no. 6.110-076.0 (ID 8, 40 m, 400 bar, 1x hose reel connection attachment kit).	<input type="checkbox"/>
Zinc-coated swivel holder	61	2.639-931.0	Swivel holder for automatic hose reel wall mounting. For maximum action radius and flexibility of high-pressure hose. Rotatable 120°. Galvanised steel.	<input type="checkbox"/>
Stainless steel swivel holder	62	2.641-867.0	Swivelling wall bracket made of high-grade steel (for 2.641-866). This makes maximum flexibility and convenience possible when working with the HP hose.	<input type="checkbox"/>
Automatic plastic hose reel incl. high-pressure hose, 15 m	63	2.639-257.0	Spring-mounted and ready-to-use automatic hose reel for wall mounting. Simplifies handling of the high-pressure hose, shortens set-up times and increases occupational safety.	<input type="checkbox"/>
Automatic hose reel, powder-coated steel / plastic, 20 m	64	6.392-074.0	Automatic hose reel for 20 m high-pressure hose. The console is made from powder-coated steel, the drum is made from plastic.	<input type="checkbox"/>
Automatic stainless steel / synthetic material hose drum, 20 m	65	6.392-083.0	Automatic hose reel for 20 m high-pressure hose. The console consists of stainless steel, the drum is made from plastic.	<input type="checkbox"/>
Automatic hose reel, coated, 20 m	66	6.392-106.0	Automatic hose reel of durable plastic. Painted steel bracket. Suitable for 20 m high-pressure hose.	<input type="checkbox"/>
Hose reel, automatic, basalt grey-coated, 20 m	67	6.392-105.0	Automatic hose reels provide the highest level of safety and convenience for winding and unwinding HP hoses. For example: order no. 6.110-011.0 (ID 8, 20 m, 315 bar) or order no. 6.110-028.0 (ID 8, 20 m, 400 bar Longlife).	<input type="checkbox"/>
Automatic hose reel, stainless steel, includes swivel holder, 20 m	68	6.392-076.0	Automatic stainless steel hose reel. With swivel holder. Suitable for 20 m high-pressure hose.	<input type="checkbox"/>
WATER CONNECTION				
Geka coupling				
Geka connector with hose barb, R 3/4"	69	6.388-455.0	with hose liner	<input type="checkbox"/>
Geka connector with hose barb, R 1"	70	6.388-465.0	with hose barb	<input type="checkbox"/>

Available accessories.

ACCESSORIES FOR HG 43

1.030-500.0



71



72



73



75



76



77



78-79



80-81

		Order no.	Description	
WATER CONNECTION				
Geka coupling				
Geka connector with internal thread, R 1"	71	6.388-458.0	with female thread	<input type="checkbox"/>
Suction filter				
Water suction filter	72	6.414-956.0	Suitable for ponds, storage tanks or similar, polyamide filter casing, stainless steel strainer, 800 µm mesh, R 3/4" and R 1" connection, without non-return valve	<input type="checkbox"/>
Suction filter with check valve	73	4.730-012.0	Brass suction filter suitable for ponds, storage tanks, etc. With check valve.	<input type="checkbox"/>
Water fine filter				
Universal water fine filter, 25 µm	74	2.637-020.0	Water fine filter, mesh size 25 µm, max. temperature 50 °C. Protects the machine from small dirt particles in the water. Water volume up to 1200 l/h. 3/4" connection, with 1" adapter.	<input type="checkbox"/>
Water fine filter, with adapter	75	4.730-102.0	Fine-mesh water filter, 125 µm, max. temperature 50°C. Protects the high-pressure cleaner from dirt particles contained in the water. Water flow rate up to 1200 l/h. Connection 3/4", with adapter, 1".	<input type="checkbox"/>
Water fine filter, 100 µm, R 1"	76	2.638-270.0	Fine-mesh water filter, 100 µm, max. temperature 60°C. Connects to high-pressure cleaner. Protects the high-pressure cleaner from dirt particles contained in the water. Water flow rate up to 1200 l/h. Connector 1".	<input type="checkbox"/>
WASHING BRUSHES				
Push-on washing brush				
Push-on wash brush	77	4.762-016.0	For general-purpose cleaning of all surfaces. Clamps directly onto the spray lance. Connection M 18 x 1.5	<input type="checkbox"/>
Rotating washing brush				
Rotating wash brush for < 800 l/h machines, nylon bristles	78	4.762-561.0	The rotating wash brush gently removes fine dust and traffic film from all surfaces. Temperature resistant up to 60°C. (M 18 x 1.5, replaceable brush insert).	<input type="checkbox"/>
Rotating wash brush for > 800 l/h machines	79	4.762-559.0	Driven by water stream. Gently removes fine dust and traffic film from any surface. Temperature resistant up to 60°C, M 18 x 1.5 (replaceable brush insert).	<input type="checkbox"/>
Rotating wash brush for < 800 l/h machines, natural bristles	80	4.762-560.0		<input type="checkbox"/>
Rotating wash brush for > 800 l/h machines	81	4.762-562.0		<input type="checkbox"/>

Available accessories.