

IVR 50/24-2 SC

For safe vacuuming of solids such as combustible and hazardous dust and swarf: The mobile, robust IVR 50/24-2 Sc for operation in non-explosive areas.



Order no. 9.989-410.0

- Cyclone-like pre-separation system
- Ergonomic container control

Technical data

| | | |
|-----------------------------|-------------|-------------------------|
| EAN code | | 4054278695006 |
| Supply voltage | Ph / V / Hz | 1 / 220 - 240 / 50 - 60 |
| Air flow | l/s / m³/h | 148 / 532 |
| Vacuum | mbar / kPa | 230 / 23 |
| Container content | l | 50 |
| Rated input power | kW | 2.4 |
| Vacuuming type | | Electric |
| Connection nominal diameter | | ID 50 |
| Accessory nominal diameter | | ID 50 / ID 40 |
| Sound pressure level | dB(A) | 68 |
| Main filter dust class | | M |
| Filter area for main filter | m² | 1.75 |
| Weight without accessories | kg | 90 |
| Weight incl. packaging | kg | 90 |
| Dimensions (L × W × H) | mm | 855 × 760 × 1290 |

Users must receive training on this device.

Equipment

| | |
|------------------------------------|------------------|
| Container emptying | Set-down trolley |
| ■ Included in the scope of supply. | |

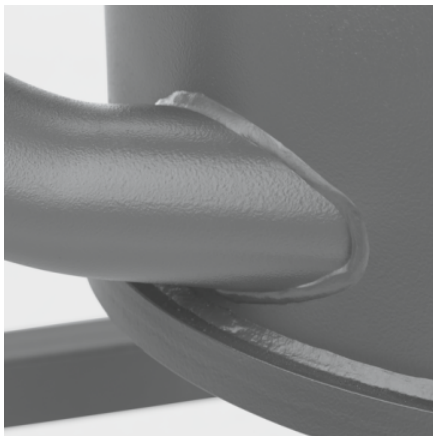

Particularly robust, particularly flexible

- With practical, movable suction hose port/pipe bend.
- Despite its very compact design, it features numerous options for carrying accessories.
- Machine and chassis very robust and equipped with high wall thicknesses.



Fitted with two very quiet fan motors

- For powerful suction power and optimum cleaning performance.
- Fans can be switched on separately for individual suction power as required.
- Very quiet drive head ensures that the cooling air is blown out evenly.



Convenient, manual filter cleaning

- Effortless operation by means of an ergonomically placed lever if required.
- Extends the life of the filter and thus reduces the maintenance effort.
- Identical cleaning results, regardless of the amount of force used.

ACCESSORIES FOR IVR 50/24-2 SC

9.989-410.0



| | | Order no. | Description | |
|---|----|-------------|---|--------------------------|
| EMPTYING SUPPORTS | | | | |
| Emptying bags | | | | |
| PE emptying bag dia. 540 mm 50 l | 1 | 9.977-885.0 | | ■ |
| ACCESSORY SETS | | | | |
| Accessory kit for solids/dust | | | | |
| Accessory kit for solids/dust Expert DN 40 | 2 | 9.989-659.0 | Accessory kit DN 40 for industrial vacuum cleaners (solids and dust): EVA hose (9.988-088.0), handle (9.977-679.0), standard nozzle (9.988-401.0), reducer (9.989-690.0). | <input type="checkbox"/> |
| Accessory kit for solids/dust Expert DN 50 | 3 | 9.989-662.0 | Accessory kit DN 50 for industrial vacuum cleaners (solids and dust): EVA hose (9.988-090.0), handle (9.977-678.0), standard nozzle (9.988-402.0), reducer (9.977-772.0). | <input type="checkbox"/> |
| NOZZLES | | | | |
| Standard nozzles | | | | |
| Standard PVC nozzle DN40 | 4 | 9.989-674.0 | Electroconductive standard PVC nozzle. DN 40. | <input type="checkbox"/> |
| Standard PVC nozzle DN50 | 5 | 9.989-673.0 | Electroconductive standard PVC nozzle. DN 50. | <input type="checkbox"/> |
| Standard nozzle silicone DN40 | 6 | 9.988-401.0 | Stretchy standard nozzle made from silicone, inner cone DN 40. | <input type="checkbox"/> |
| Standard nozzle silicone DN50 | 7 | 9.988-402.0 | | <input type="checkbox"/> |
| Standard nozzle cuttable rubber DN40 | 8 | 9.989-677.0 | Standard nozzle, electroconductive, made from cuttable rubber. DN 40. | <input type="checkbox"/> |
| Standard nozzle cuttable rubber DN50 | 9 | 9.989-675.0 | Standard nozzle, electroconductive, made from cuttable rubber. DN 50. | <input type="checkbox"/> |
| Standard aluminium nozzle DN40 | 10 | 9.980-748.0 | Diagonal nozzle made from anodised aluminium, electroconductive, DN 40. | <input type="checkbox"/> |
| Standard aluminium nozzle DN50 | 11 | 9.980-749.0 | Diagonal nozzle made from anodised aluminium, electroconductive, DN 50. | <input type="checkbox"/> |
| Flexible standard nozzles | | | | |
| Standard nozzle flexible PVC DN40 | 12 | 9.981-420.0 | Electroconductive, flexible round nozzle made from galvanised steel, with rubber mouthpiece DN 30. | <input type="checkbox"/> |
| Standard nozzle flexible PVC DN50 | 13 | 9.981-421.0 | Electroconductive, flexible round nozzle made from galvanised steel, DN 50, with rubber mouthpiece DN 30. | <input type="checkbox"/> |
| Standard nozzle, flexible, angled 90° PP DN40 | 14 | 9.981-429.0 | Flexible, electroconductive angled nozzle, DN 40, length: 800 mm. | <input type="checkbox"/> |

■ Included in the scope of supply. □ Available accessories.

ACCESSORIES FOR IVR 50/24-2 SC

9.989-410.0



| | | Order no. | Description | |
|---|----|-------------|---|--------------------------|
| NOZZLES | | | | |
| Flexible standard nozzles | | | | |
| Standard nozzle, flexible, angled 90° PP DN50 | 15 | 9.981-430.0 | Flexible, electroconductive angled nozzle, DN 50, length: 800 mm. | <input type="checkbox"/> |
| Floor nozzles | | | | |
| Aluminium floor nozzle 370 mm DN40 | 16 | 9.989-683.0 | Floor nozzle, 370 mm, made from aluminium. DN 40. | <input type="checkbox"/> |
| Aluminium floor nozzle, el, 370 mm, DN40 | 17 | 9.989-682.0 | Floor nozzle, 370 mm, made from aluminium. Electroconductive. DN 40. | <input type="checkbox"/> |
| Aluminium floor nozzle 200 mm DN50 | 18 | 9.981-426.0 | Floor nozzle, DN 50, with 200 mm suction width. | <input type="checkbox"/> |
| Aluminium floor nozzle 370 mm DN50 | 19 | 9.989-664.0 | Floor nozzle. 370 mm, made from aluminium. Electroconductive. DN 50. | <input type="checkbox"/> |
| Aluminium floor nozzle, el, 370 mm, DN50 | 20 | 9.987-612.0 | Electroconductive multi-purpose floor nozzle. 370 mm wide, DN 50. | <input type="checkbox"/> |
| Aluminium floor nozzle 500 mm DN50 | 21 | 9.989-684.0 | Floor nozzle, 500 mm, made from aluminium. Electroconductive. DN 50. | <input type="checkbox"/> |
| Aluminium floor nozzle, el, 500 mm, DN50 | 22 | 9.981-925.0 | Floor nozzle with 500 mm suction width and hinge. DN 50, electroconductive. | <input type="checkbox"/> |
| Stainless steel floor nozzle el 370 mm DN40 | 23 | 9.989-558.0 | Multi-purpose floor nozzle (370 mm), electroconductive, DN 40. | <input type="checkbox"/> |
| Stainless steel floor nozzle el 370 mm DN50 | 24 | 9.988-115.0 | Floor nozzle (370 mm) made from stainless steel, electroconductive, DN 50. | <input type="checkbox"/> |
| Floor nozzle rubber strip oil-resistant. 220 mm | 25 | 9.981-923.0 | Squeegee with plastic strip for floor nozzle, 220 mm wide. | <input type="checkbox"/> |
| Floor nozzle rubber strip 370 mm | 26 | 9.981-914.0 | Squeegee with profiled strip for floor nozzle, 370 mm wide. | <input type="checkbox"/> |
| Floor nozzle rubber strip 500 mm | 27 | 9.981-915.0 | Oil-resistant squeegee with profiled strip for floor nozzle, 500 mm wide. | <input type="checkbox"/> |
| Floor nozzle brush strip el. 370 mm | 28 | 9.984-939.0 | Electroconductive squeegee for floor nozzle, 370 mm wide. | <input type="checkbox"/> |

■ Included in the scope of supply. □ Available accessories.

ACCESSORIES FOR IVR 50/24-2 SC

9.989-410.0



| | | Order no. | Description | |
|---|----|-------------|--|--------------------------|
| NOZZLES | | | | |
| Floor nozzles | | | | |
| Floor nozzle brush strip 500 mm | 29 | 9.980-764.0 | Brush strip set for floor nozzle 500 mm, with profiled strip. | <input type="checkbox"/> |
| Crevice nozzles | | | | |
| Crevice nozzle PP 15 mm × 145 mm DN50 | 30 | 9.988-117.0 | Electroconductive, flat multi-purpose crevice nozzle made from plastic, DN 52. | <input type="checkbox"/> |
| Crevice nozzle PU 22 mm × 175 mm DN50 | 31 | 9.981-482.0 | Crevice nozzle made from PU, DN 50. | <input type="checkbox"/> |
| Crevice nozzle 18 mm × 120 mm DN50 | 32 | 9.981-442.0 | Electroconductive crevice nozzle made from sheet steel, DN 50, with 17 mm slot width. | <input type="checkbox"/> |
| Crevice nozzle 25 mm × 120 mm DN50 | 33 | 9.981-465.0 | Electroconductive crevice nozzle made from sheet steel, DN 50, with 25 mm slot width. | <input type="checkbox"/> |
| Flexible crevice nozzles | | | | |
| Flexible crevice nozzle silicone 65 mm DN50 | 34 | 9.988-403.0 | Flexible crevice nozzle made from silicone, DN 50. | <input type="checkbox"/> |
| Flexible crevice nozzle 11 mm × 58 mm DN40 | 35 | 9.989-681.0 | Electroconductive and flexible crevice nozzle, 11 × 58 mm. | <input type="checkbox"/> |
| Flexible crevice nozzle 20 mm × 45 mm DN40 | 36 | 9.981-423.0 | Flexible and electroconductive crevice nozzle made from galvanised steel with 20 mm slot width, DN 40. | <input type="checkbox"/> |
| Flexible crevice nozzle 12 mm × 45 mm DN50 | 37 | 9.981-424.0 | Flexible, electroconductive galvanised crevice nozzle, DN 50, with 13 mm slot width. | <input type="checkbox"/> |
| Flexible crevice nozzle 20 mm × 45 mm DN50 | 38 | 9.981-425.0 | Flexible and electroconductive crevice nozzle made from galvanised steel with 20 mm slot width, DN 50. | <input type="checkbox"/> |
| Surface nozzles | | | | |
| Silicone surface nozzle 120 mm DN40 | 39 | 9.988-118.0 | Electroconductive rubber nozzle, angled, DN 40, suitable for use with foods. | <input type="checkbox"/> |
| Silicone surface nozzle 120 mm DN50 | 40 | 9.988-119.0 | Electroconductive rubber nozzle, angled, DN 50, suitable for use with foods. | <input type="checkbox"/> |
| Aluminium surface nozzle, 150 mm, DN 40 | 41 | 9.989-666.0 | Surface nozzle, 150 mm, made from aluminium. DN 40. | <input type="checkbox"/> |
| Aluminium surface nozzle 150 mm DN50 | 42 | 9.989-665.0 | Surface nozzle, 150 mm, made from aluminium. DN 50. | <input type="checkbox"/> |

■ Included in the scope of supply. □ Available accessories.

ACCESSORIES FOR IVR 50/24-2 SC

9.989-410.0



| | | Order no. | Description | |
|--|----|-------------|--|--------------------------|
| NOZZLES | | | | |
| Liquid nozzles | | | | |
| Liquid nozzle 900 mm DN50 | 43 | 9.981-427.0 | Bypass nozzle, DN 50, overall length: 1000 mm. | <input type="checkbox"/> |
| Borehole nozzles | | | | |
| Blind hole nozzle DN40 | 44 | 9.989-671.0 | 90° curved blind hole nozzle with 60 mm diameter. | <input type="checkbox"/> |
| Blind hose nozzle angled 60° DN40 | 45 | 9.989-669.0 | 90° curved blind hole nozzle with 48 mm diameter. DN 40. | <input type="checkbox"/> |
| Blind hose nozzle angled 90° DN40 | 46 | 9.989-667.0 | 90° curved blind hole nozzle with 60 mm diameter. DN 40. | <input type="checkbox"/> |
| Blind hose nozzle angled 90° 200 mm extension DN40 | 47 | 9.989-670.0 | 90° curved blind hole nozzle with 48 mm diameter. DN 40. | <input type="checkbox"/> |
| BRUSHES | | | | |
| Standard brushes | | | | |
| Standard brush 40 mm DN40 | 48 | 9.981-431.0 | Flat brush nozzle DN 40. | <input type="checkbox"/> |
| Standard brush 40 mm DN50 | 49 | 9.981-432.0 | Flat brush nozzle DN 50. | <input type="checkbox"/> |
| End brushes | | | | |
| End brush Ø 82 mm DN40 | 50 | 9.989-609.0 | Electroconductive end brush with 82 mm diameter. DN 40. | <input type="checkbox"/> |
| End brush Ø 82 mm DN50 | 51 | 9.989-608.0 | Electroconductive end brush with 82 mm diameter. DN 50. | <input type="checkbox"/> |
| Surface brushes | | | | |
| Surface brush PP 24 mm DN40 | 52 | 9.989-610.0 | Electroconductive surface brush. DN 40. | <input type="checkbox"/> |
| Surface brush 300 mm DN40 | 53 | 9.981-911.0 | Vacuum brush, 300 mm, with 45° connection, with star screw, horsehair bristles. | <input type="checkbox"/> |
| Surface brush 300 mm DN50 | 54 | 9.981-912.0 | | <input type="checkbox"/> |
| HOSES | | | | |
| PVC | | | | |
| Hose PVC DN50 3 m | 55 | 9.989-615.0 | Electroconductive PVC hose, DN 50. Temperature-resistant up to 85 °C. Length: 3 m. | <input type="checkbox"/> |
| Hose PVC DN50 5 m | 56 | 9.989-616.0 | Electroconductive PVC hose, DN 50. Temperature-resistant up to 85 °C. Length: 5 m. | <input type="checkbox"/> |

☐ Available accessories.

ACCESSORIES FOR IVR 50/24-2 SC

9.989-410.0



| | | Order no. | Description | |
|---|----|-------------|---|--------------------------|
| HOSES | | | | |
| PVC | | | | |
| PVC hose DN50 15 m without connectors | 57 | 9.989-634.0 | PVC hose without tap adapter, DN 50. Electroconductive and temperature-resistant up to 85 °C. Length: 15 m. | <input type="checkbox"/> |
| EVA hoses | | | | |
| Hose EVA NW50 3 m | 58 | 9.988-090.0 | Electroconductive hose with NW50. Suitable for temperatures up to 65°C. Length: 3 m. | <input type="checkbox"/> |
| Hose EVA NW50 5 m | 59 | 9.988-091.0 | | <input type="checkbox"/> |
| EVA hose DN50 15 m without connectors | 60 | 9.989-631.0 | EVA hose without tap adapter, DN 50. Electroconductive and temperature-resistant up to 65 °C. Length: 15 m. | <input type="checkbox"/> |
| Hose installation sets | | | | |
| Hose installation kit DN50 | 61 | 9.989-628.0 | Multipiece hose connection kit, DN 50. | <input type="checkbox"/> |
| PU hoses | | | | |
| Hose PU DN50 3 m | 62 | 9.989-619.0 | Oil-resistant, electroconductive PU hose, DN 50. Suitable for abrasive suction media and temperature-resistant up to 80 °C. Length: 3 m. | <input type="checkbox"/> |
| Hose PU DN50 5 m | 63 | 9.989-620.0 | Oil-resistant, electroconductive PU hose, DN 50. Suitable for abrasive suction media and temperature-resistant up to 80 °C. Length: 5 m. | <input type="checkbox"/> |
| PU hose DN50 15 m without connectors | 64 | 9.989-638.0 | PU hose without tap adapter, DN 50. Electroconductive and temperature-resistant up to 80 °C. Length: 15 m. | <input type="checkbox"/> |
| ME-PU-hoses | | | | |
| Hose ME-PU DN50 3 m | 65 | 9.989-623.0 | Electroconductive, oil-resistant ME-PU hose, DN 50. Suitable for abrasive suction media and temperature-resistant up to 110 °C. Length: 3 m. | <input type="checkbox"/> |
| Hose ME-PU DN50 5 m | 66 | 9.989-625.0 | Electroconductive, oil-resistant ME-PU hose, DN 50. Suitable for abrasive suction media and temperature-resistant up to 110 °C. Length: 5 m. | <input type="checkbox"/> |
| ME-PU hose DN50 15 m without connectors | 67 | 9.989-641.0 | Electroconductive, oil-resistant ME-PU hose without tap adapter, DN 50. Suitable for abrasive suction media and temperature-resistant up to 110 °C. Length: 15 m. | <input type="checkbox"/> |
| HANDLES | | | | |
| Elbow aluminium 45° DN40 | 68 | 9.989-544.0 | 45° curved handle made from aluminium, DN 40. | <input type="checkbox"/> |
| Elbow aluminium 45° DN50 | 69 | 9.989-547.0 | Handle with 45° bend. Made from aluminium, DN 50. | <input type="checkbox"/> |
| Handle DN 40 | 70 | 9.977-679.0 | 45° curved and electroconductive handle made from stainless steel. Inner cone DN 40. | <input type="checkbox"/> |

☐ Available accessories.

ACCESSORIES FOR IVR 50/24-2 SC

9.989-410.0



| | | Order no. | Description | |
|---|----|-------------|---|--------------------------|
| HANDLES | | | | |
| Handle DN50, curved | 71 | 9.977-678.0 | Electroconductive and 45° curved handle made from stainless steel. Inner cone DN 50. | <input type="checkbox"/> |
| Stainless steel handle NW40 | 72 | 9.989-036.0 | Curved and electroconductive handle made from stainless steel. Angle 45°, inner cone NW 40. | <input type="checkbox"/> |
| Stainless steel handle NW50 | 73 | 9.988-111.0 | Curved and electroconductive handle made from stainless steel. Angle 45°, inner cone NW 50. | <input type="checkbox"/> |
| SUCTION TUBES | | | | |
| Carbon suction tube 1500 mm DN40 | 74 | 9.989-552.0 | Very light carbon extension tube, electroconductive, DN 40. Length: 1500 mm. | <input type="checkbox"/> |
| Carbon suction tube 1500 mm DN50 | 75 | 9.989-553.0 | Electroconductive, very light carbon extension tube. Inner cone DN 50, 1500 mm long. | <input type="checkbox"/> |
| Suction tube 850 mm DN 40 | 76 | 9.977-525.0 | Steel extension tube, electroconductive, DN 40. Length: 850 mm. | <input type="checkbox"/> |
| Suction tube 850 mm DN 50 | 77 | 9.977-531.0 | 850 mm long extension tube made from steel. Electroconductive and with inner cone DN 50. | <input type="checkbox"/> |
| Aluminium suction tube 1500 mm NW40 | 78 | 9.989-038.0 | Aluminium extension tube, electroconductive, NW 40. Length: 1500 mm. | <input type="checkbox"/> |
| Aluminium suction tube 1500 mm NW50 | 79 | 9.989-035.0 | Electrically conductive suction tube (1500 mm) made of aluminium with 50 mm diameter. | <input type="checkbox"/> |
| Stainless steel suction tube 850 mm NW40 | 80 | 9.989-039.0 | Stainless steel extension tube, electroconductive, NW 40. Length: 850 mm. | <input type="checkbox"/> |
| Stainless steel suction tube 850 mm NW50 | 81 | 9.988-114.0 | Electroconductive extension tube made from stainless steel. Inner cone NW 50. | <input type="checkbox"/> |
| ADAPTERS / REDUCERS / DISTRIBUTORS | | | | |
| Accessories adapter | | | | |
| Adapter accessories DN 50 to DN 51 | 82 | 9.989-603.0 | Steel adapter for connection of DN 50 to DN 51. Electroconductive. | <input type="checkbox"/> |
| Adapter accessories DN 51 to DN 50 | 83 | 9.989-601.0 | Steel adapter for connection of DN 51 to DN 50. Electroconductive. | <input type="checkbox"/> |
| Adapter accessories DN50 to DN61 | 84 | 9.989-602.0 | Steel adapter for connection of DN 50 to DN 61. Electroconductive. | <input type="checkbox"/> |

☐ Available accessories.

ACCESSORIES FOR IVR 50/24-2 SC

9.989-410.0



| | | Order no. | Description | |
|---|----|-------------|--|--------------------------|
| ADAPTERS / REDUCERS / DISTRIBUTORS | | | | |
| Accessories adapter | | | | |
| Adapter accessories DN 61 to DN 50 | 85 | 9.989-604.0 | Steel adapter for connection of DN 61 to DN 50. Electroconductive. | <input type="checkbox"/> |
| Reducers/expanders | | | | |
| Reduction DN50 to DN40 | 86 | 9.981-231.0 | Reducer from DN 50 to DN 40. Material: Steel. Electroconductive. | <input type="checkbox"/> |
| Expander | | | | |
| Expansion DN50 to DN70 | 87 | 9.981-921.0 | Reducer from external cone DN 50 to internal cone DN 70. Material: Steel. Electroconductive. | <input type="checkbox"/> |
| Distributor | | | | |
| Y-piece fitting DN50 to DN40 | 88 | 9.981-149.0 | Manifold, electroconductive, steel, DN 50/40/40. | <input type="checkbox"/> |
| PRE-SEPARATORS | | | | |
| Pre-separator | | | | |
| Pre-separator Ef solid materials 100 l DN70 | 89 | 9.982-238.0 | Mobile pre-separator station with 100 l volume and discharge flap. | <input type="checkbox"/> |
| Pre-separator dust 40 l DN40 | 90 | 9.989-687.0 | | <input type="checkbox"/> |
| Pre-separator dust 60 l DN50 | 91 | 9.989-688.0 | | <input type="checkbox"/> |
| Pre-separator drum 200 l | 92 | 9.989-685.0 | Standard drum which complies with the ISO 15750-2 standard. | <input type="checkbox"/> |
| Pre-separator lid | | | | |
| Pre-separator cover Op liquids ø 517 mm DN70 | 93 | 9.981-666.0 | Pre-separator cover DN 70. Suitable for containers with 517 mm diameter. | <input type="checkbox"/> |
| Pre-separator cover Op liquids ø 575 mm DN70 | 94 | 9.981-662.0 | Pre-separator cover DN 70 for 200 litre standard drum (9.989-685.0). | <input type="checkbox"/> |
| Pre-separator cover solid materials ø 517 mm DN70 | 95 | 9.981-665.0 | Pre-separator cover DN 70. Suitable for containers with 517 mm diameter. | <input type="checkbox"/> |
| Pre-separator cover solid materials ø 575 mm DN70 | 96 | 9.981-661.0 | Pre-separator cover DN 70 for 200 litre standard drum (9.989-685.0). | <input type="checkbox"/> |

☐ Available accessories.