

Foot valve with mechanical safety latch and inductive proximity switch

FV 1500-S-V-E

The FV 1500-S-V-E is a foot valve with mechanical valve and additional electrical switching contact. This robust and reliable foot valve to close / open a high pressure line (basic position "closed") is operated by a foot lever with mechanical safety latch. The safety latch releases the movement of the actuating lever and, upon release of the lever, automatically returns to the safe position. The proximity switch detects the foot lever position and triggers the control signal. With this foot valve, additional valve units as well as complex control units can be remote-controlled, thus enhancing work safety and work comfort.

The foot valve is available with various hose connections for pressurized water inlet (P) and pressurized water outlet (A). All parts that come into contact with the medium consist of stainless and acid-resistant CrNi steels.



Special advantages

- Compact and robust due to a solid construction
- All functional components are protected against the penetration of dirt and splash water
- Suitable for sea water and demineralized water
- Large nominal flow
- Low pressure drop
- Turnable pressure housing and bypass connection
- Large protective hood and mechanical safety catch against unintentional actuation of the foot lever
- Large ribbed tread for safe operation
- Low operating forces due to servo valve technology

| Technical specifications | | |
|------------------------------|---------|-------------|
| Material no. 24V | | 9.871-211.0 |
| Material no. EXI | | 9.871-210.0 |
| Operating pressure | max. | 1,500 bar |
| Nominal flow rate | approx. | 85 l/min |
| Medium temperature | max. | +95 °C |
| Weight | approx. | 10.5 kg |
| Length | | 500 mm |
| Width | | 185 mm |
| Height | | 200 mm |
| High pressure connection (P) | | iM22x1.5 |
| High pressure connection (A) | | iM26x1.5 |

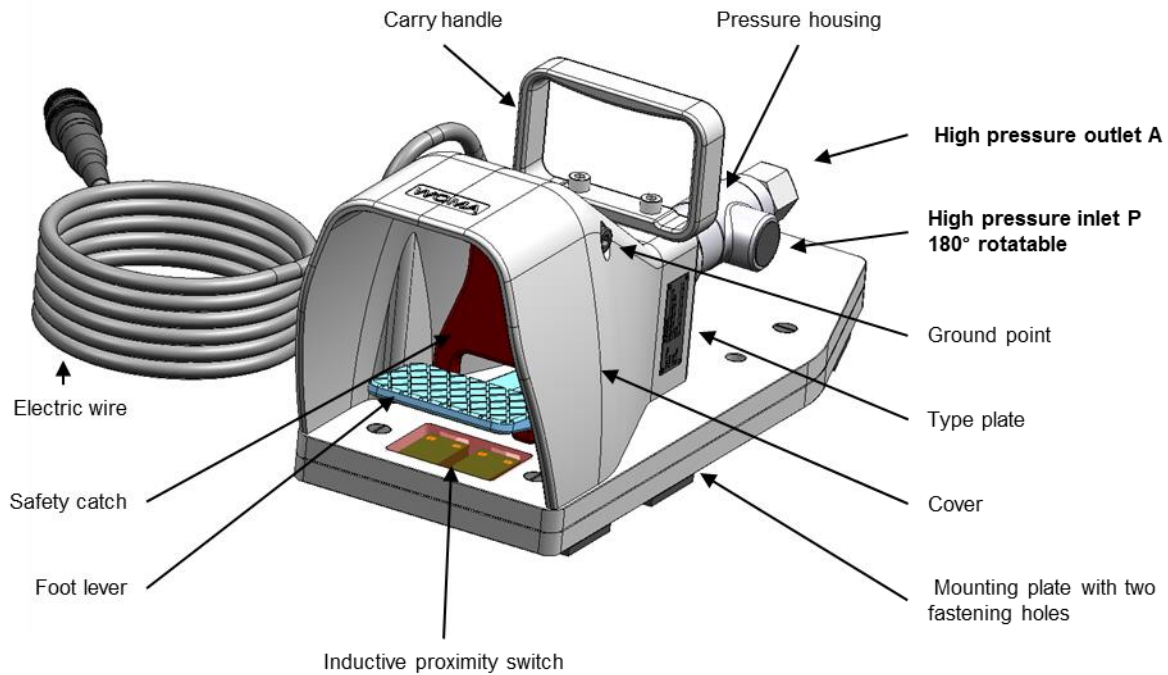

Accessories

Thread M according to DIN 13/ISO 261
Thread G according to DIN ISO 228/1

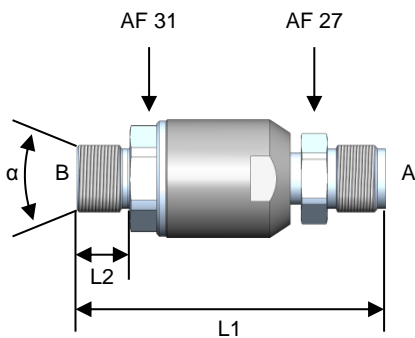

| Rotatable hose connection for A* | | | |
|----------------------------------|----------------|----------------|--------------|
| Hose connection B (α) | Length L1 [mm] | Length L2 [mm] | Material no. |
| M22x1.5 (60°) | 117 | 20 | 9.872-621.0 |
| M22x1.5 (24°) | 117 | 20 | 9.872-620.0 |
| M24x1.5 (24°) | 117 | 20 | 9.872-622.0 |
| G1/2 (60°) | 117 | 20 | 9.894-987.0 |

*max. 1,500 bar

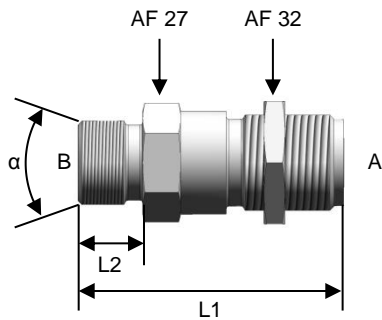

High pressure hose connection for A*

| Hose connection B (α) | Length L1 [mm] | Length L2 [mm] | Material no. |
|-----------------------|----------------|----------------|--------------|
| M22x1.5 (60°) | 70 | 20 | 9.872-536.0 |
| M22x1.5 (24°) | 67 | 17 | 9.872-537.0 |
| M24x1.5 (24°) | 70 | 20 | 9.872-538.0 |
| G1/2 (60°) | 70 | 20 | 9.872-623.0 |
| G3/4 (60°) | 70 | 20 | 9.872-940.0 |

*max. 1,500 bar; Includes adapter, lock nut, sealing ring and protection plug

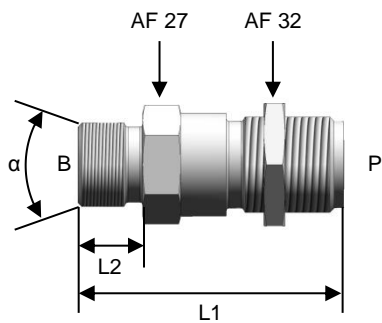

High pressure hose connection for P*

| Hose connection B (α) | Length L1 [mm] | Length L2 [mm] | Material no. |
|-----------------------|----------------|----------------|--------------|
| M22x1.5 (60°) | 79 | 17 | 9.871-968.0 |
| M22x1.5 (24°) | 76 | 20 | 9.871-967.0 |
| M24x1.5 (24°) | 79 | 20 | 9.871-969.0 |
| G1/2 (60°) | 79 | 20 | 9.871-970.0 |
| G3/4 (60°) | 79 | 19 | 9.871-971.0 |

*max. 1,500 bar; Includes adapters, lock nuts and protection plugs