

Pneumatically driven rotary lead through Speedy 3000

The Speedy 3000 is a pneumatically driven rotary lead through with integrated air motor, suitable for a wide range of application. The composition of HP-Gun, Speedy 3000 and nozzle carrier head represents a highly efficient water tool, which guarantees – depending on the rotation of the nozzle carrier head – a high surface treatment/cleaning rate.

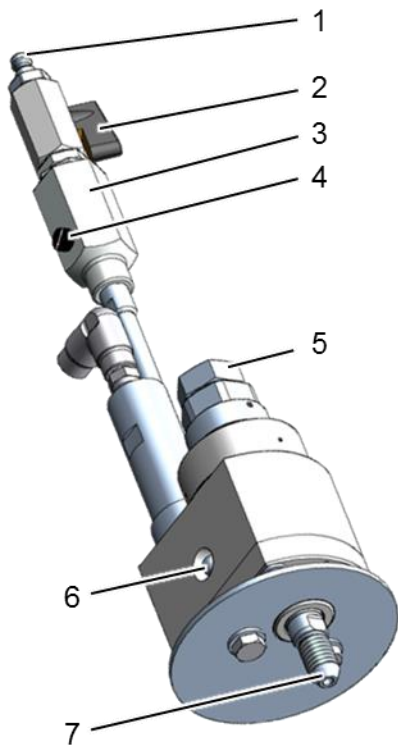

Speedy 3000

- 1 Pressure connection
- 2 Throttle valves
- 3 Air pressure lubricator
- 4 Thumbscrew air pressure lubricator
- 5 High pressure connection
- 6 Lubrication nipples
- 7 Nozzle carrier head connection

Special characteristics

- Rotational speed adjustable by air pressure and quantity
- Low weight
- Compact design with small dimensions
- Optimum running qualities
- Pressure conducting parts made of high-tensile stainless steel

Technical Data		
Material no.		9.871-342.0
Operating pressure	max.	3,000 bar
Flow rate	max.	25 l/min
Medium temperature	max.	60 °C
Weight without grease gun approx.		2.50 kg
Working pressure of the air motor		6.5 bar
Working rpm		2,500 1/min
Performance at working rpm		0.16 kW
Air consumption at 6,3 bar		0.35 - 0.40 m ³ /min
Sense of rotation in jet direction		clockwise
Length	approx.	339 mm
Width	approx.	100 mm
Pressure connection		KS ¼"
High pressure connection		9/16"-18 UNF-LH
Nozzle carrier head connection		M14x1,5

Operating information

- The air motor is only to be used with dry, clean and lubricated air.
- Only fill up with pneumatic oil (WOMA material no. 9.890-539.0) viscosity class ISO VG 22.
- The max. permitted air pressure of 6.3 bar has not to be exceeded.

Accessories

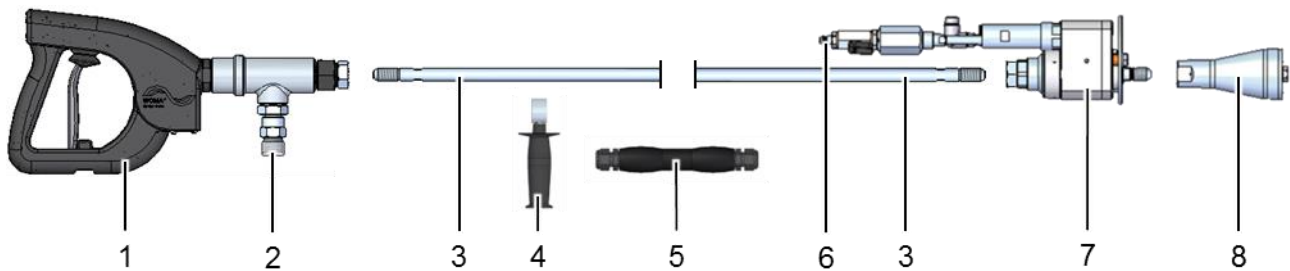

Sample configuration high pressure gun HP-V 1500

	Description	Material no.
1	HP-V 1500	9.919-180.0
2	Hose connector 1,500 bar	9.871-969.0
3	Lance tube* 1,500 bar	see WOMA product catalogue
4	Handle grip	9.871-675.0
5	Handle grip	6.025-300.0
6	Pressure connection KS ¼"	see table 2
7	Speedy 3000	9.871-342.0
8	Nozzle carrier head	see table 1

* For lance tube connection M14x1.5 LH use only pressure ring (material no.9.883-493).

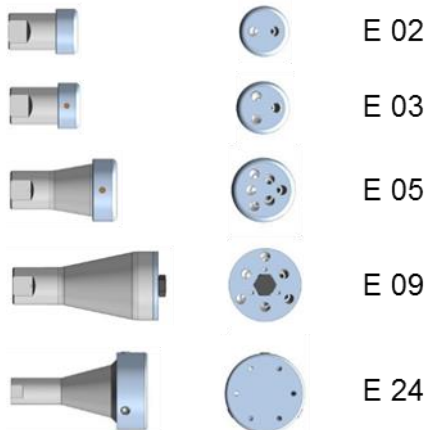

Nozzle carrier head up to 3,000 bar – Table 1

Type	Number of nozzles Form 21 LL / Form 21 S	Blasting angle	Weight [kg]	Material no.
E 02	2	20°	0.45	9.886-774.0
E 03	3	30°	0.45	9.886-775.0
E 05	3 or 6	20°, 24°	0.47	9.886-772.0
E 09	3 or 6	20°, 24°	0.85	9.886-773.0
E 24	3 or 6	30°	0.85	9.886-645.0

Air pressure hose – Table 2

Length [m]	Weight [kg]	Material no.
10	2.6	9.887-259.0
20	5.0	6.025-249.0
40	9.6	6.025-250.0