

# KÄRCHER

## FC 7 Cordless



**Register  
your product**  
[www.kaercher.com/welcome](http://www.kaercher.com/welcome)



59698620 (05/23)

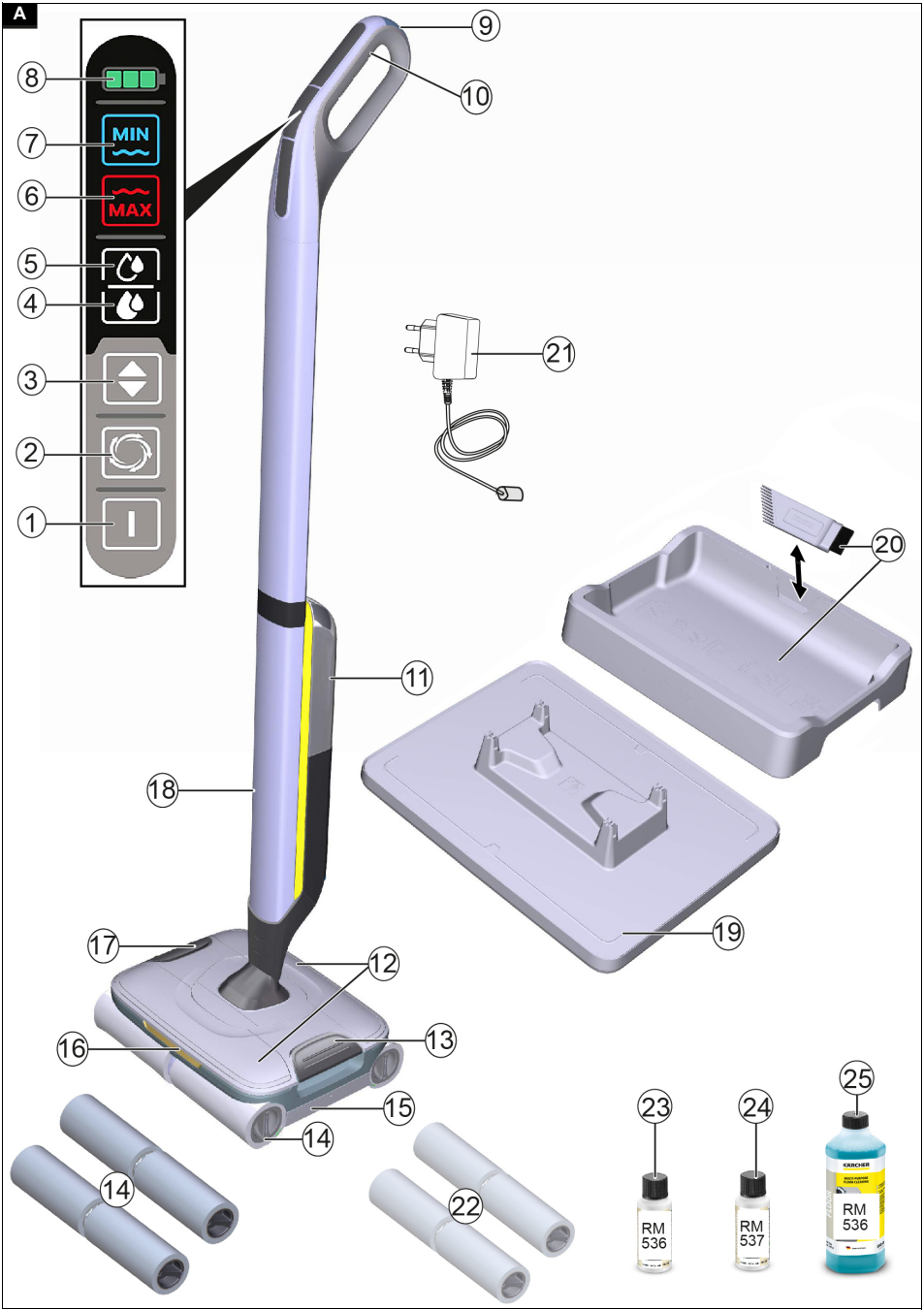

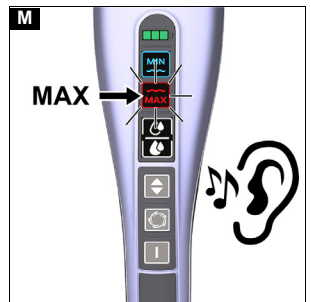
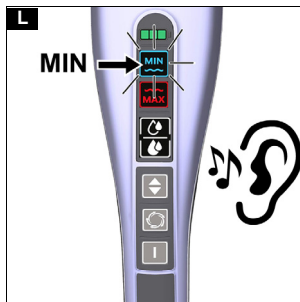
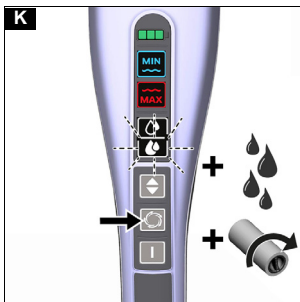
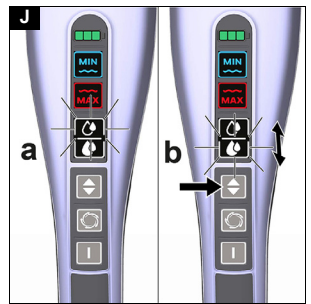
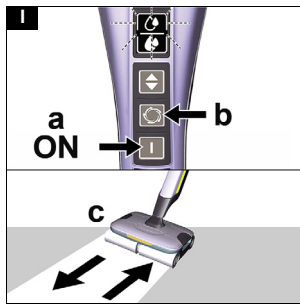
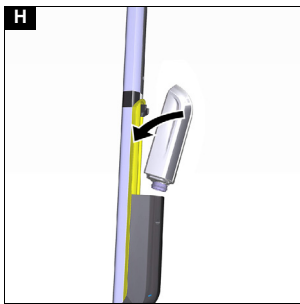
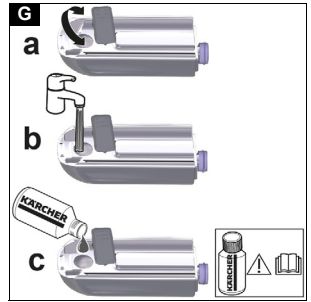
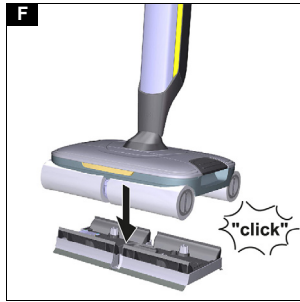
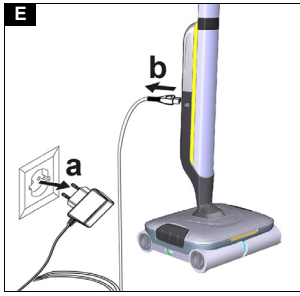
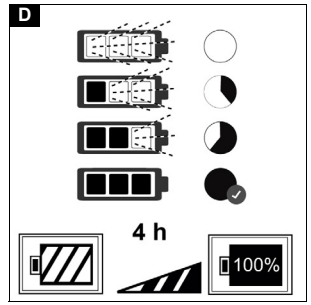
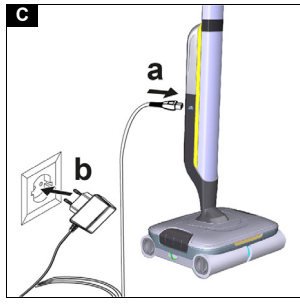
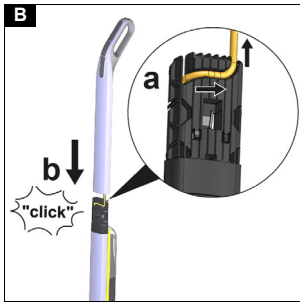

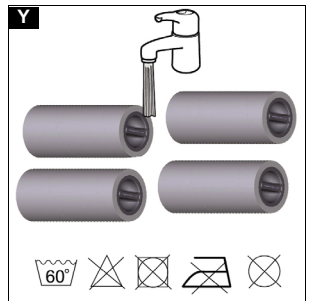
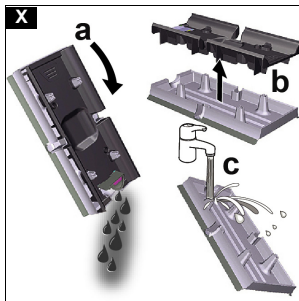
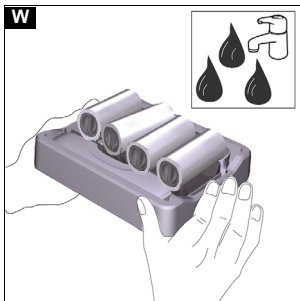
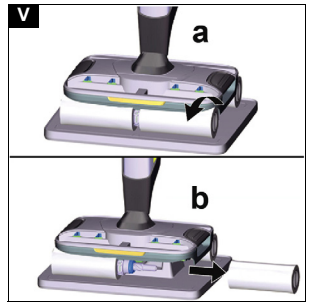
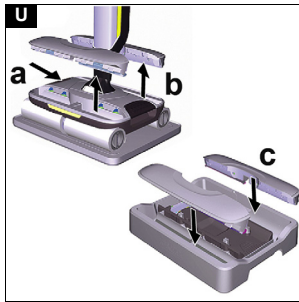
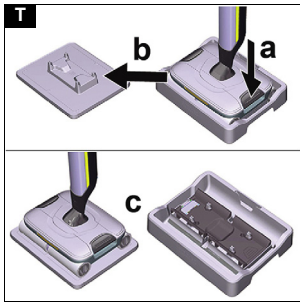
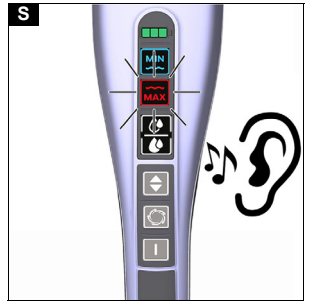
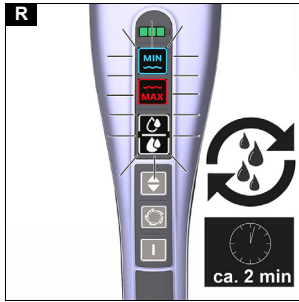
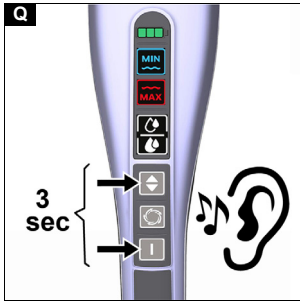
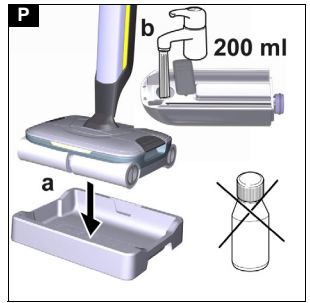
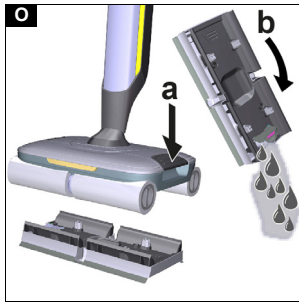
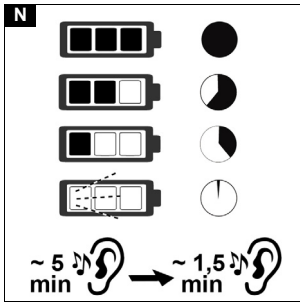

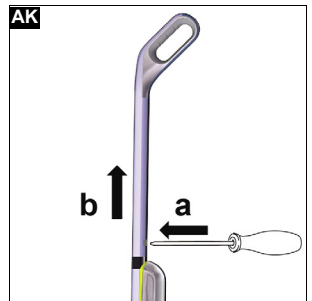
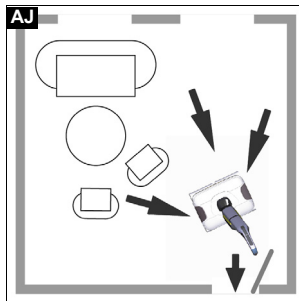
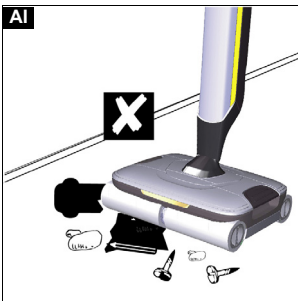
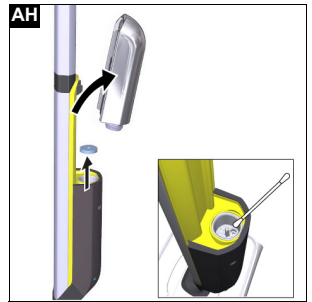
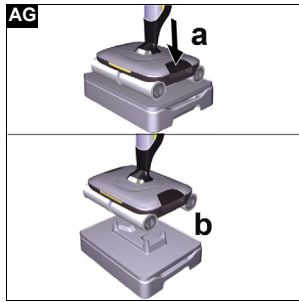
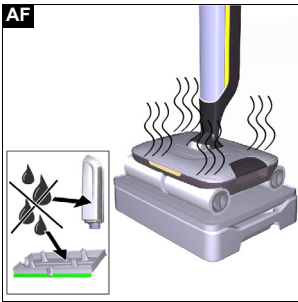
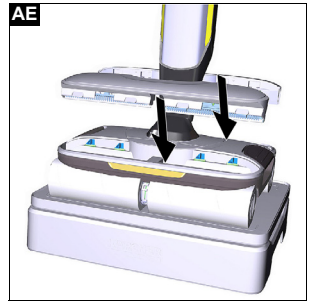
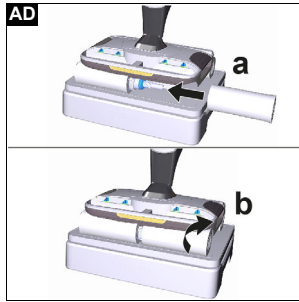
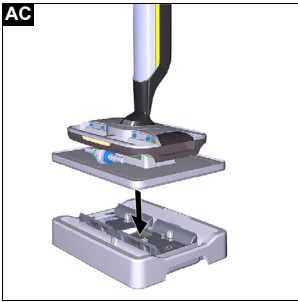
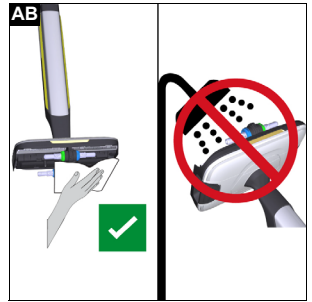
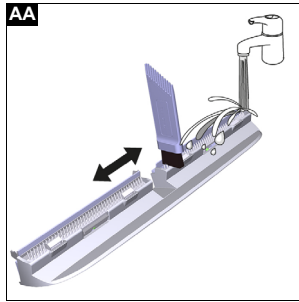
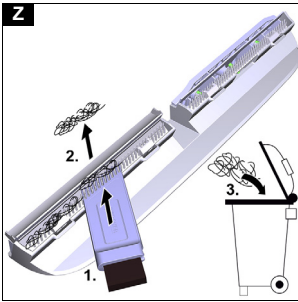

## Contents

Intended use.....	6
Environmental protection.....	6
Accessories and spare parts.....	6
Scope of delivery.....	6
Warranty.....	6
Safety instructions.....	6
Symbols on the device.....	7
Description of the device.....	7
Installation.....	8
Initial startup.....	8
Operation.....	8
Care and service.....	10
Troubleshooting guide.....	12
Technical data.....	13

## Intended use

Use the floor cleaner exclusively for cleaning hard floors in your private household and only on waterproof hard floors.

Do not clean water-sensitive floor coverings such as e.g. untreated cork floors, since the moisture can penetrate and damage the floor.

The device is suitable for cleaning PVC, linoleum, tiled, stone, oiled and waxed parquet, laminate and all water-resistant floor coverings.

## Environmental protection



The packing materials can be recycled. Please dispose of packaging in accordance with the environmental regulations.



Electrical and electronic devices contain valuable, recyclable materials and often components such as batteries, rechargeable batteries or oil, which - if handled or disposed of incorrectly - can pose a potential danger to human health and the environment. However, these components are required for the correct operation of the device. Devices marked by this symbol are not allowed to be disposed of together with the household rubbish.

### Notes on the content materials (REACH)

Current information on content materials can be found at: [www.kaercher.de/REACH](http://www.kaercher.de/REACH)

## Accessories and spare parts

Only use original accessories and original spare parts. They ensure that the appliance will run fault-free and safely.

Information on accessories and spare parts can be found at [www.kaercher.com](http://www.kaercher.com).

## Scope of delivery

The scope of delivery for the appliance is shown on the packaging. Check the contents for completeness when unpacking. If any accessories are missing or in the event of any shipping damage, please notify your dealer.

## Warranty

The warranty conditions issued by our sales company responsible apply in all countries. We shall remedy possible malfunctions on your device within the warranty period free of cost, provided that a material or manufacturing defect is the cause. In a warranty case, please

contact your dealer (with the purchase receipt) or the next authorised customer service site.  
(See overleaf for the address)

## Safety instructions

Read this safety chapter and these original instructions before using the device for the first time. Act in accordance with them. Keep the original instructions for future reference or for future owners.

- In addition to the notes in the operating instructions, you also need to take into consideration the general safety regulations and accident prevention guidelines applicable by law.
- Warnings and information notices attached to the device provide important information for hazard-free operation.

## Hazard levels

### ⚠ DANGER

- Indication of an imminent threat of danger that will lead to severe injuries or even death.

### ⚠ WARNING

- Indication of a potentially dangerous situation that may lead to severe injuries or even death.

### ⚠ CAUTION

- Indication of a potentially dangerous situation that may lead to minor injuries.

### ATTENTION

- Indication of a potentially dangerous situation that may lead to damage to property.

## Electrical components

⚠ **DANGER** • Do not immerse the device in water. • Never insert conductive objects, e.g. screwdrivers or similar, into the charging socket on the appliance. • Never touch contacts or lines. • Do not damage the mains connection cable by running it over, crushing it or pulling it across sharp edges. • Only connect the device to alternating current. The voltage indicated on the type plate must match the voltage of the power source. • Only operate the device via a fault current protection switch (maximum 30 mA).

⚠ **WARNING** • Immediately replace a damaged charger together with charging cable with an original part. • Switch off the device immediately and remove the mains plug before performing any care and service work. • The device contains electrical components. Do not clean the device or the top or bottom of the floor head under running water or under a shower spray, otherwise water may enter. • Only connect the device to an electrical connection which has been set up by a qualified electrician as per IEC 60364-1.

⚠ **CAUTION** • Have repair work carried out by the authorised customer service only. • Check the device and the accessories each time before operation, in particular the mains connection and extension cable, to make sure it is safe and working correctly. Pull out the mains plug in case of any damage and do not use the device.

## Charger

⚠ **DANGER** • Never touch the mains plug and socket with wet hands. • Do not charge the battery pack in an explosion-hazard environment.

**⚠ WARNING** • Protect the power cable from heat, sharp edges, oil and moving parts. • Do not cover the battery pack during the charging process and ensure that the ventilation slits remain clear. • Do not open the charger. Repairs are only to be carried out by qualified personnel. • Only charge the battery pack with the approved chargers. • Immediately replace a damaged charger together with charging cable with an original part.

**⚠ CAUTION** • Do not use the battery pack when dirty or wet. • Do not carry the charger by the power cable. • Do not operate the device together with other devices on an extension cable with multiple power sockets. • Do not pull the mains plug out the socket using the power supply cable.

**ATTENTION** • Only use and store the charger in dry rooms.

### Battery

**⚠ DANGER** • Do not expose the battery to strong sunlight, heat or fire.

**⚠ WARNING** • Only charge the appliance using the original charger enclosed or with a charger approved by KÄRCHER.

Use the following adapter:



**WARNING** • Short circuit hazard. Do not open the battery. Irritating vapours or corrosive liquids can also escape.

**ATTENTION** • This device contains non-replaceable batteries. Does not apply to appliances with a replaceable battery pack

### Safe handling

**⚠ DANGER** • Risk of asphyxiation. Keep packaging film out of the reach of children.

**⚠ WARNING** • Only use the device for its proper use. Take into account the local conditions and beware of third parties, in particular children, when working with the device. • Adhere to the respective safety regulations in hazard zones (e.g. service stations). Never operate the device in explosive spaces. • Children and persons unfamiliar with these instructions are not allowed to operate the device. The age of the operator may be limited by local restrictions. • The device is not intended for use by children, persons with restricted physical, sensory or mental abilities or persons unfamiliar with these instructions. • Persons with reduced physical, sensory or mental capabilities and persons lacking experience and knowledge may only use the appliance if they are properly supervised, have been instructed on use of the appliance safely by a person responsible for their safety, and understand the resultant hazards involved. • Children must not play with the appliance. • Children must be supervised to prevent them from playing with the appliance. • Keep the device out of the reach of children when it is connected to the mains or when it is cooling down. • Children may only perform cleaning work and user maintenance under supervision. • Protect the connection cable against heat, sharp edges, oil and moving unit parts. • Keep all parts your body (e.g. fingers, hair) away from the rotating

cleaning rollers • Risk of injury from sharp objects (e.g. splinters). Protect your hands while cleaning the floor head.

**⚠ CAUTION** • Do not use the appliance if it has been dropped beforehand, is visibly damaged or if it is leaking. • Only operate or store the device in accordance with the description or figure. • Accidents or damage due to the device falling over. Before all actions with or on the device, you must make sure that it is stable. • Never leave the device unsupervised while it is in operation.

**ATTENTION** • Device damage. Never fill the water reservoir with solvents, liquids containing solvents or undiluted acids (e.g. detergents, petrol, paint thinners and acetone). • Only switch on the device when the fresh water tank and waste water tank are installed.

• Do not pick up sharp or larger objects with the device, such as e.g. glass shards, gravel or toy parts. • Do not fill the fresh water container with vinegar, decalcification agents, essential oils or similar substances. Avoid taking up these substances with the device. • Use the device only on hard floors with a watertight coating, such as e.g. varnished parquet, enamelled tiles or linoleum. • Do not use the device for cleaning carpets or carpeted floors. • Do not guide the device over the floor grilles of convection heating systems. The device cannot vacuum up the escaping water when it is guided over a floor grille. • In case of longer breaks in operation and after use, switch off the device at the main switch / device switch and pull out the charged mains plug. • Do not operate the device at temperatures below 0 °C. • Protect the device from rain. Do not store the device outdoors.

### Symbols on the device



- The warning for not cleaning the floor head under running water is located:
  - on the bottom of the floor head.

- Symbols for unit cleaning mode after finishing work are located:

- engraved in the bowl of the cleaning station,
- as a label on the back of the fresh water tank.
- Symbols for unlocking the waste water tank/parking station are located:
  - as a label on the unlocking button for the waste water tank/parking station.

The application and description of the symbols (see chapter *Floor head cleaning by means of rinsing process*).

### Description of the device

The maximum amount of equipment is described in these operating instructions. Depending on the model used, there are differences in the scope of delivery (see packaging).

**For the illustrations, refer to the graphics page.**

#### Illustration A

- ① ON/OFF switch
- ② Boost function button  
Increased roller speed and additional water quantity for stubborn dirt

- ③ Button for adjusting the cleaning level  
Switching between cleaning level 1 and 2
- ④ "Cleaning level 2" indicator  
Increased roller speed and amount of water
- ⑤ "Cleaning level 1" indicator  
Normal roller speed and amount of water
- ⑥ "MAX" indicator (red)  
The waste water tank is full
- ⑦ "MIN" indicator (blue)  
The fresh water tank is empty
- ⑧ "Battery" indicator (green)  
Indicates the charging state of the battery
- ⑨ Wall anti-slip handle
- ⑩ Handle
- ⑪ Fresh water tank
- ⑫ Removable hair filters
- ⑬ Unlocking button for the waste water tank and parking station
- ⑭ Cleaning rollers (4 x)
- ⑮ Waste water tank
- ⑯ \* LED lighting
- ⑰ Unlocking button for hair filters
- ⑱ Charging socket
- ⑲ Parking station
- ⑳ Cleaning station with cleaning brush
- ㉑ Charger with charging cable
- ㉒ \* Cleaning rollers for stone floors (4 x)
- ㉓ Detergent RM 536 (30 ml)
- ㉔ \* Detergent RM 537 (30 ml)
- ㉕ \* Detergent RM 536 (500 ml)

\* optional

## Installation

### Installing the handle bar

1. Hold the basic device firmly.
2. Place the cable in the guide of the plastic connector and fix it.
3. Fit the handle bar all the way to the end stop into the basic device until it audibly latches into place. The handle bar must sit tightly in the device.

#### Illustration B

## Initial startup

### Charging process

#### **⚠ WARNING**

##### **Risk of fire due to defective mains plug**

*A continuously connected charger can overheat and cause a fire if the mains plug is defective.  
Unplug the charger from the mains after a maximum of one day.*

#### **Note**

*Unplug the charger from the mains after a maximum of one day, as a plugged-in charger continuously consumes power.*

1. Plug the charging cable of the charger into the charging socket on the device.

#### **Illustration C**

2. Plug the mains plug of the charger into the socket. The LED indicator lights display the battery's current charging state.

#### **Illustration D**

- All 3 LED indicator lights flash from bottom to top when charging a completely empty battery.
  - The lowermost LED lights up continuously when the battery is 1/3 charged, the two upper LEDs continue to flash.
  - When the battery is 2/3 charged, the two lower LEDs light up continuously, the uppermost LED continues to flash.
  - The battery is fully charged after 4 hours.
  - After the battery has been charged, the 3 LED indicator lights remain on constantly for 60 minutes. After this time, the LED indicator lights go out.
3. Unplug the charger mains plug from the mains socket after charging.

#### **Illustration E**

4. Unplug the charging cable from the device.

### Fitting the waste water tank

1. Place the device in the middle of the waste water tank so that it is positioned between the rollers and then audibly clicks into place. The position of the tank is not important because it can be inserted in both longitudinal directions in the device.

#### **Illustration F**

The waste water tank must sit tightly in the device.

### Fitting the fresh water tank

1. Grasp the fresh water tank by the recessed grips at the side and remove it from the device.
2. Open the tank cap and turn it to the side.

#### **Illustration G**

3. Fill the fresh water tank with cold or lukewarm tap water.
4. Add KÄRCHER detergent or care agent to the fresh water tank as required.

## ATTENTION

### **Overdosing or underdosing of the detergent or care agent**

*Can result in poor cleaning results.*

*Follow the dosage recommendations for the detergent or care agent.*

5. Close the tank cap.
6. Fit the fresh water tank into the device.

#### **Illustration H**

The fresh water tank must sit tightly in the device.

## Operation

### General notes on operation

## ATTENTION

### **Moisture**

*Material damage to sensitive floors*

*Check the surface to be cleaned for water sensitivity at an inconspicuous location before using the device.*

*Do not clean water-sensitive floor coverings such as e.g. untreated cork floors, since the moisture can penetrate and damage the floor.*



## ATTENTION

### Material damage

Damage to the device from pointed, large and/or bulky objects.

The device must not be stored and used on hard coarse dirt and objects, as the parts can get stuck under the waste water tank and cause scratches on the floor and tank.

Before starting work and storing the device, remove objects such as shards, pebbles, screws or toy parts from the floor.

### Illustration AI

#### Note

- To avoid striped patterns, test the device on an inconspicuous area before using on sensitive surfaces, e.g. wood or fine stone.
- Do not allow it to remain in one area, but keep it in motion.
- Observe the instructions for the floor covering manufacturer.

#### Note

Work backwards towards the door so that no footprints are generated on the freshly washed floor.

### Illustration AJ

- Floor cleaning is performed using a to and fro movement at the same speed as when vacuuming.
- Activate the Boost function for heavy soiling. Hold the Boost function button pressed for this. The roller speed and water volume are increased when the boost function is activated. The Boost function can be activated at cleaning level 1 and cleaning level 2. The indicator for the corresponding cleaning level flashes when the Boost function is activated. Allow the device to slide slowly over the floor without exerting any pressure on the device.

### Illustration K

- Various different rollers are available, depending on the scope of delivery. The colour of the rollers indicates the respective special application for which they are suitable.
  - Grey / yellow universal rollers: versatile
  - Rollers with black stripes: For cleaning insensitive hard floors (e.g. stone, ceramic); not suitable for sensitive natural stone floors (e.g. marble, terracotta)

#### Note

For an optimum cleaning result, wash the rollers in the washing machine at 60° C before initial use.

## ATTENTION

### Material damage due to loose rollers

This may damage the washing machine.

Place the rollers in a laundry net and load the washing machine with extra laundry.

### Starting work

## ATTENTION

### Uncontrolled motion

Damage to the device and material damage

The cleaning rollers start rotating as soon as the device is switched on.

Hold the handle tight to prevent the device from moving away independently.

## ATTENTION

Fresh water tank or waste water tank not installed

Material damage

Before starting cleaning work, ensure that the fresh water tank is filled with water and the waste water tank is fitted in the device.

1. Press the ON/OFF switch.

### Illustration I

The device switches on.

The cleaning level 1 indicator for normal roller speed and normal water quantity is lit.

2. Moisten the rollers.

a Hold the Boost function button pressed.

b Move the device back and forth until the rollers are sufficiently moistened.

#### Note

If the rollers block immediately after switching on, remove the rollers, moisten them under the tap and reinsert them.

3. If necessary, switch to cleaning level 2 using the button for adjusting the cleaning level.

### Illustration J

This increases the roller speed and water volume.

The Cleaning level 2 indicator lights up.

#### Note

Selection of cleaning level 1 or cleaning level 2 depends on the type of floor to be cleaned (e.g. wooden or stone floor).

The device is set to cleaning level 1 after initial start-up. The cleaning level setting last used always remains activated after interrupting and resuming work.

4. If necessary, activate the boost function for cleaning stubborn dirt (see also chapter *General notes on operation*).

### Illustration K

### Battery run time

The "Battery" indicator shows the remaining battery run time:

- 3 LEDs illuminated - 3/3 (full) battery run time
- 2 LEDs illuminated - 2/3 battery run time
- 1 LED illuminated - 1/3 battery run time

### Illustration N

Acoustic or optical signals warn of a flat battery.

- An acoustic signal sounds 2 times and the lowest LED flashes approx. 5 minutes before the battery is empty.
- An acoustic signal sounds 2 times and the lowest LED continues to flash approx. 1.5 minutes before the battery is empty.
- The last LED flashes quicker for 60 seconds when the battery is empty and the device has switched off.

### Emptying the waste water tank

- The "MAX" indicator (red) lights up and an acoustic signal sounds when the waste water tank is full.

### Illustration M

- After 60 seconds, an acoustic signal sounds again and the device switches off.
- The "MAX" indicator (red) flashes for 10 seconds once the device is switched off.
- As long as the waste water tank is full and the (red) "MAX" display lights up, the process restarts and the following two steps are repeated:
  - a The device can be switched on again.
  - b The device runs for another 60 seconds and then switches off again.

1. Press the ON/OFF switch.

The device switches off.

2. Press the unlocking button for the waste water tank with your foot and lift the device.

#### **Illustration O**

The waste water tank releases from the device.

3. For draining, do not transport the waste water tank by the top cover, but horizontally with both hands at the narrow sides.
4. Empty the waste water tank through the opening in the cap. In the case of adhering dirt deposits, remove the cover of the waste water tank and rinse the waste water tank with tap water.
5. Fit the waste water tank (see Chapter *Fitting the waste water tank*).

#### **Refilling with detergent**

- The "MIN" indicator (blue) lights up and an acoustic signal sounds when the fresh water tank is empty.

#### **Illustration L**

- The acoustic signal sounds once a minute as a reminder.
1. Fill the fresh water tank (see Chapter *Filling the fresh water tank*).

#### **Interrupting operation**

### **ATTENTION**

#### **Damp rollers**

*Moisture damage to sensitive floors*

*To prevent damage to sensitive floors through wet rollers, place the device in the parking station during longer work breaks.*

1. Press the ON/OFF switch.  
The device switches off.

2. Place the device in the parking station.

#### **Note**

*If the device is placed on the parking station without a waste water tank, the unlocking button must be pressed to remove the device.*

#### **Illustration AG**

#### **Ending operation**

1. Press the ON/OFF switch.  
The device switches off.
2. Place the device in the parking station.

#### **Illustration AC**

### **ATTENTION**

#### **Adhering dirt deposits**

*Adhering dirt deposits can damage the device in the long term.*

*It is recommended to clean the device completely after each application.*

3. Clean the device (see Chapter *Care and service*).

#### **Storing the device**

### **ATTENTION**

#### **Liquids/moist dirt**

*Unpleasant odours can develop if the device contains liquids/moist dirt when stored.*

*Completely empty the fresh water tank and waste water tank before storing the device.*

*Use the cleaning brush to remove hair and dirt particles from the hair filters in the floor head cover.*

*Allow the cleaned rollers to dry in the air, e.g. mounted in the device on the parking station. Do not place the wet rollers in an enclosed cupboard to dry.*

1. Put the empty waste water tank in the cleaning station to dry.
  - a Place the device on the parking station and let it snap into place.

- b Then place the device with the parking station on the cleaning station.

#### **Illustration AC**

2. Fit the cleaned rollers on the device for drying.

#### **Illustration AD**

3. Charge the battery (see Chapter *Charging process*).

4. Store the device in a dry room.

#### **Illustration AF**

## **Care and service**

### **Floor head cleaning by means of rinsing process**

### **ATTENTION**

#### **Dirt or detergent residues**

*The waste water tank and the hair filters must be cleaned regularly to ensure that dirt does not accumulate in the tank and hair filters. Dirt particles can clog the hair filters and slots if the device is not cleaned after use. The accumulation of dirt and bacteria can also result in the development of unpleasant odours in the device.*

*On completion of work, place the device in the cleaning station and start the rinsing process.*

*Clean the floor head in the cleaning station only by using the automatic rinsing process and not by pouring water into the station separately. Make sure that the waste water tank is attached.*

*Do not clean the device or the top or bottom of the floor head under running water or under a shower spray, otherwise water may enter.*

#### **Note**

*The rinsing process cannot be started while the "MAX" indicator (red) is lit and the waste water tank has not been emptied.*

#### **Note**

*The LED lighting on the floor head remains switched off during the rinsing process.*

1. Press the ON/OFF switch.  
The device switches off.
2. Empty the waste water tank and reinsert it (see chapter *Emptying the waste water tank*).
3. Place the device with an empty waste water tank in the parking station.
4. Fill the fresh water tank with at least 200 ml of fresh water without a detergent or care agent (see chapter *Filling the fresh water tank*).

#### **Illustration P**

#### **Note**

*It is not necessary to add detergent for the rinsing process.*

5. Hold the ON/OFF switch and the cleaning level adjustment button simultaneously pressed for 3 seconds.

An acoustic signal sounds.

#### **Illustration Q**

6. The indicators light up repeatedly from top to bottom.  
The rinsing process starts and takes approx. 2 minutes.

#### **Illustration R**

#### **Note**

*At the start of the rinsing process, the water runs from the fresh water tank onto the rollers for approx. 80 seconds. During this time the device is silent. Only at the end of the rinsing process do the rollers start to turn for approx. 30 seconds.*

- When the rinsing process is finished, a signal tone sounds and the (red) "MAX" display lights up.

#### **Illustration S**

- Press the unlocking button for the waste water tank and place the device on the parking station. The waste water tank remains in the cleaning station.

#### **Note**

The (red) "MAX" display flashes for 10 seconds if an attempt is made to switch the device on again with a full waste water tank.

Cleaning work cannot be continued.

- Press the unlocking button for the hair filters inwards.

The hair filters are released.

- Place the hair filters in the cleaning station.

#### **Illustration U**

- Remove the rollers and place them in the cleaning station.

#### **Illustration V**

- Transport the cleaning station with waste water tank, hair filters and rollers to the toilet, sink or waste container as required.

#### **Illustration W**

- Clean the waste water tank (see chapter *Cleaning the waste water tank*).

- Clean the rollers (see chapter *Cleaning the rollers*).

- Clean the hair filters (see chapter *Cleaning the hair filters*).

- Clean the underside of the floor head and the roller drive with a moist cloth.

#### **Illustration AB**

#### **Note**

Do not clean the device or the top or bottom of the floor head under running water or under a shower spray, otherwise water may enter.

- Empty and dry the cleaning station.

- If water is still present in the fresh water tank, remove and drain the fresh water tank.

### **Cleaning the waste water tank**

#### **ATTENTION**

##### **Adhering dirt deposits**

Adhering dirt deposits can damage the device in the long term.

Clean the waste water tank regularly.

For information on the waste water tank indicator and the procedure for cleaning the waste water tank, see Chapter *Emptying the waste water tank*.

- Remove the waste water tank cap.

#### **Illustration X**

- Clean the waste water tank and cap with tap water.

- Alternatively, the waste water tank can be cleaned in a dishwasher.

#### **Note**

The rubber inlays of the waste water tank flap can become sticky when cleaned in a dishwasher. This does not affect their sealing ability.

### **Cleaning the rollers**

#### **ATTENTION**

##### **Detergent residue in the rollers**

##### **Foaming**

Wash the rollers under running water or clean them in a washing machine each time after using the device.

#### **ATTENTION**

##### **Damage due cleaning the rollers with fabric softener or using a clothes dryer**

Damage to the microfibrres

Do not use fabric softener when cleaning in a washing machine.

Do not dry the rollers in a clothes dryer.

#### **ATTENTION**

##### **Material damage due to loose rollers**

This may damage the washing machine.

Place the rollers in a laundry net and load the washing machine with extra laundry.

- Press the ON/OFF switch.

The device switches off.

- Place the device in the parking station.

#### **Illustration AC**

- Unscrew the cleaning rollers via the recessed grip.

#### **Illustration V**

- Clean the cleaning rollers under running water on in a washing machine at max. 60 °C.

#### **Illustration Y**

- Twist the cleaning rollers as far as they will go onto the roller holder. Pay attention to the colour coding on the inner side of the roller and on the roller holder (e.g. blue to blue).

#### **Illustration AD**

- Allow the rollers to dry on the device and on the parking station.

#### **Illustration AF**

### **Cleaning the hair filters**

#### **ATTENTION**

##### **Adhering dirt deposits**

Adhering dirt deposits can damage the device in the long term.

It is recommended to clean the device completely after each application.

#### **ATTENTION**

##### **Adhering dirt deposits**

Adhering dirt deposits can damage the device in the long term.

Clean both hair filters regularly with the cleaning brush.

#### **ATTENTION**

##### **Damage due to cleaning the hair filters in a dishwasher**

The washing process can distort the scraper edge and it will no longer press on the rollers correctly. This worsens the cleaning result.

Do not clean the hair filters in a dishwasher but rather under running water.

- Press the ON/OFF switch.

The device switches off.

- Place the device in the parking station.

#### **Illustration AC**

- Press the unlocking button for the hair filters inwards.

#### **Illustration U**

The hair filters are released and can be removed.

- Clean both hair filters under running water.

- Remove adhering dirt deposits, e.g. in the filter comb, using the cleaning brush.

#### **Illustration AA**

#### **Illustration Z**

6. Insert the hair filters into the floor head and allow them to latch into place. Both hair filters must sit tightly in the device.

#### Illustration AE

### Cleaning and care agents

## ATTENTION

### Use of unsuitable detergents and care agents

The use of unsuitable detergents and care agents can damage the device and loss of eligibility for warranty claims.

Use only KÄRCHER detergents.

Take care to ensure the correct dosage.

#### Note

Use KÄRCHER detergent or care agents for floor cleaning as necessary.

- Observe the manufacturer's dosing quantity recommendations when dosing with detergent or care agents.
- To prevent foaming, fill the fresh water tank with water first and then add the detergent or care agent.
- To prevent the tank from overflowing, be sure to leave enough space for the detergent or care agent when filling with water.

## Troubleshooting guide

Malfunctions often have simple causes that you can remedy yourself using the following overview. When in doubt, or in the case of malfunctions not mentioned here, please contact your authorised Customer Service.

#### Note

The device is disabled for 3 seconds when a fault occurs.

The device cannot be switched on again until the fault has been corrected.

#### The battery is not charging

The charging plug/mains plug is not connected correctly.

- Connect the charging plug/mains plug correctly.

#### The error LED ("Battery" indicator) flashes when the device is switched on and the device does not start

The battery is discharged.

- Charge the battery (see Chapter *Charging process*).

An incorrect or faulty charger was used.

- Use the original charger.
- Replace the faulty charger.

#### The device switches off and the LED fault display ("Battery" display) flashes.

The device overheats (e.g. at high ambient temperatures, when used with dry rollers or when used on carpet).

- Allow the device to cool down for approx. 2.5 hours. The device can only be switched on again once it has cooled down enough. The device may be charged while it is cooling down.

#### The cleaning level 1 and cleaning level 2 indicators flash simultaneously and the rollers do not rotate

The device has a motor blockage, e.g. due to excessive pressure on the rollers or through movement into a wall/corner.

- Switch the device off and back on again.

The rollers are blocked.

- Remove the rollers and check if an object has become stuck in the rollers.
- Check that the rollers are screwed in as far as they will go onto the roller holder.

- Check if dirt has accumulated in the hair filters in the floor head and remove any dirt present.
- Check that the hair filters are fitted correctly. For this, remove the hair filters and then fit them back in place.

The hair filters are blocking the rollers. The rollers are not being sufficiently moistened.

- Press the ON/OFF switch. The device switches off.
- Press the unlocking button for the hair filters inwards and remove the hair filters.
- Press the ON/OFF switch. The device switches on.
- Moisten the rollers.
  - a Hold the Boost function button pressed.
  - b Move the device back and forth until the rollers are sufficiently moistened.

#### Note

If the rollers are not sufficiently moistened, remove the rollers, moisten them under the tap and reinsert them.

- Fit the hair filters.

#### The display lights up repeatedly from top to bottom

The device is in the 2-minute rinsing process for cleaning the floor head

- Wait for about 2 minutes, then rinsing is finished and the display no longer lights up (see Chapter *Floor head cleaning by means of rinsing process*).

#### The display indicator "Fill fresh water tank" lights up although the fresh water tank is filled.

The sensor of the fresh water tank holder is dirty.

- Remove the fresh water tank and clean the sensor of the fresh water tank holder, e.g. with a cotton swab.

#### Illustration AH

The water in the tank is too soft.

- Do not use distilled water for cleaning.

#### The device cannot be switched on

The battery is discharged.

- Charge the battery.
- The charging cable is still plugged into the device.
- Unplug the charging cable, operation is not possible while the charging cable is plugged in.

#### The device rattles loudly when switched on

The rollers are not being sufficiently moistened.

- Moisten the rollers.
  - a Hold the Boost function button pressed.
  - b Move the device back and forth until the rollers are sufficiently moistened.

#### Note

If the rollers are not sufficiently moistened, remove the rollers, moisten them under the tap and reinsert them.

The rollers have deformed.

- Only store the device on the parking station and not on the floor, as the rollers may deform due to the contact pressure.

#### The device does not absorb dirt

There is no water in the fresh water tank. The "MIN" (blue) indicator lights up and an acoustic signal sounds.

- Refill the fresh water tank with water.
- The fresh water tank is not sitting properly in the device.
- Insert the fresh water tank so that it is firmly seated in the device.

The waste water tank is missing or not sitting properly in the device.

- Insert the waste water tank in the device so that it audibly latches into place.

- Check whether the lid of the waste water tank is correctly fitted (filler tab must be placed in the recess provided).

The hair filters are missing or are not sitting correctly in the device.

- Fit the hair filters correctly in the device.
- The rollers are missing or not sitting properly in the device.

- Fit the rollers or twist the rollers as far as they will go onto the roller holder.

The rollers are dirty or worn out.

- Clean the rollers or replace if necessary.

#### The rollers are too dry

The rollers are not being sufficiently moistened.

- Moisten the rollers.
  - a Hold the Boost function button pressed.
  - b Move the device back and forth until the rollers are sufficiently moistened.

#### Note

If the rollers are not sufficiently moistened, remove the rollers, moisten them under the tap and reinsert them.

The fresh water filter is dirty.

- Clean the fresh water filter.
  - a Remove the fresh water tank and take out the fresh water filter.

#### Illustration AH

- b Clean the fresh water filter under running water.
- c Reinsert the fresh water filter.

#### Poor cleaning result

Rollers were not washed before initial use.

- Wash the rollers in a washing machine at 60°C.

The rollers are dirty.

- Clean the rollers.

The rollers are not being sufficiently moistened.

- Moisten the rollers.
  - a Hold the Boost function button pressed.
  - b Move the device back and forth until the rollers are sufficiently moistened.

Incorrect detergent or incorrect dosage.

- Use only KÄRCHER detergent and be sure to use the correct dosage.

Foreign detergents are present on the floor.

- Thoroughly remove all detergent residues from the rollers using water.
  - Clean the floor several times using the device and clean rollers, without using detergent.
- This removes all detergent residues from the floor.

#### The water absorption is not optimal

The hair filters are not sitting correctly in the device.

- Fit the hair filters correctly in the device.

The rollers are worn out.

- Replace the rollers.

#### The device is losing waste water

The waste water tank is full.

- Empty the waste water tank immediately.

The waste water tank is not sitting properly in the device.

- Insert the waste water tank in the device so that it audibly latches into place. The waste water tank must sit tightly in the device.

The hair filters are not sitting correctly in the device.

- Check that the hair filters are fitted correctly.

The waste water tank is damaged.

- Contact the authorised Customer Service.

#### The device switches on

As soon as the waste water tank has exceeded a volume of 200 ml, automatic device shutdown is activated.

If detergents from other manufacturers are used, excessive foaming can occur and the device shutdown is activated before the 200 ml level is reached.

- Empty the waste water tank.
- Use only KÄRCHER detergent and be sure to use the correct dosage.

#### The device engages in joints when used

The knobs on the underside of the waste water tank are damaged or worn.

- Contact the authorised Customer Service.

### Removing the handle

#### ATTENTION

##### Frequent removal of the handle

The handle components can be damaged by repeated removal.

Do not remove the handle from the basic device after assembly.

The handle may only be removed from the basic device when the device is sent out for service purposes.

#### ATTENTION

##### Incorrect removal of the handle

Device damage

Take care to ensure that the connection cable between the basic unit and the handle is not damaged.

- Insert a screwdriver at a 90° angle in the small opening at the rear side of the handle and remove the handle.

#### Illustration AK

### Technical data

	FC 7	
<b>Electrical connection</b>		
Voltage	V	100 - 240
Phase	~	1
Frequency	Hz	50 - 60
Degree of protection		IPX4
Device protection class		III
Charger protection class		II
Nominal power of device	W	80
Nominal voltage of battery	V	25.20 - 25.55
Battery type		Li-Ion
Operating time when battery is fully charged	min	45
Charging time for an empty battery	h	4
Output voltage of charger	V	30
Output current of charger	A	0.6
<b>Device performance data</b>		
Roller rotations per minute at cleaning level 1	rpm	450
Roller rotations per minute at cleaning level 2	rpm	490
Roller rotations per minute with Boost function	rpm	530
<b>Filling quantity</b>		
Fresh water tank capacity	ml	400

<b>FC 7</b>		
Waste water tank capacity	ml	200
<b>Dimensions and weights</b>		
Weight (without accessories and cleaning fluids)	kg	4.3
Length	mm	310
Width	mm	230
Height	mm	1210

Subject to technical modifications.





**THANK YOU!**  
**MERCI! DANKE! ¡GRACIAS!**



Registrieren Sie Ihr Produkt und profitieren Sie von vielen Vorteilen.

Register your product and benefit from many advantages.

Enregistrez votre produit et bénéficiez de nombreux avantages.

Registre su producto y aproveche de muchas ventajas.

**[www.kaercher.com/welcome](http://www.kaercher.com/welcome)**



Bewerten Sie Ihr Produkt und sagen Sie uns Ihre Meinung.

Rate your product and tell us your opinion.

Évaluer votre produit et dites-nous votre opinion.

Reseñe su producto y díganos su opinión.



**[www.kaercher.com/dealersearch](http://www.kaercher.com/dealersearch)**

**Alfred Kärcher SE & Co. KG**

Alfred-Kärcher-Str. 28-40

71364 Winnenden (Germany)

