

KÄRCHER

FC 2-4



**Register
your product**
www.kaercher.com/welcome



59800920 (08/23)

A

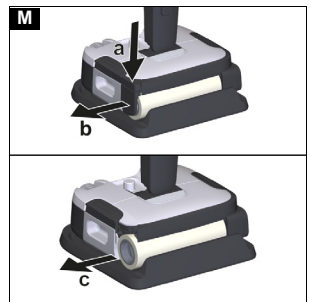
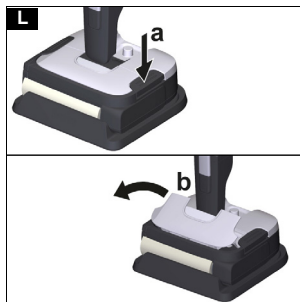
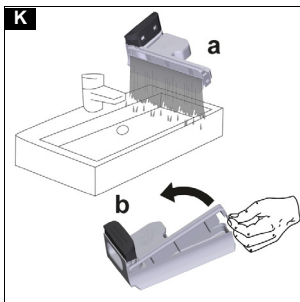
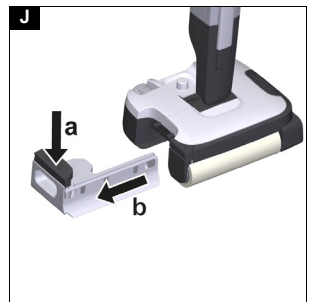
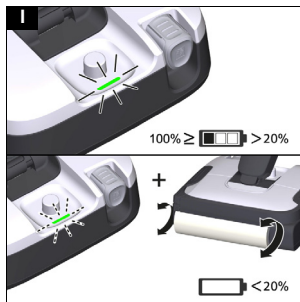
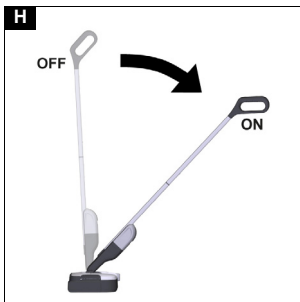
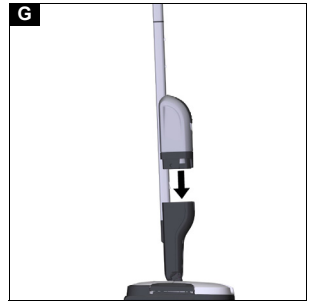
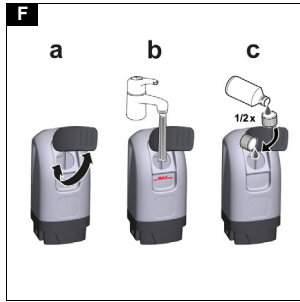
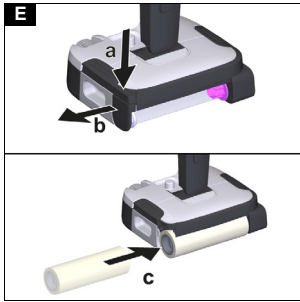
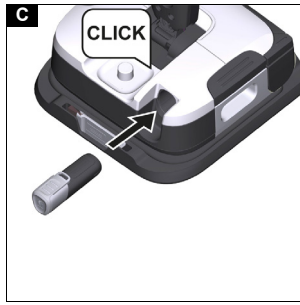
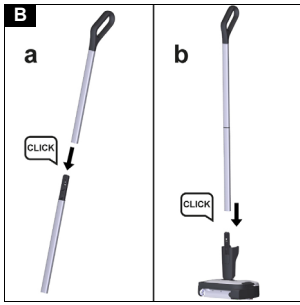

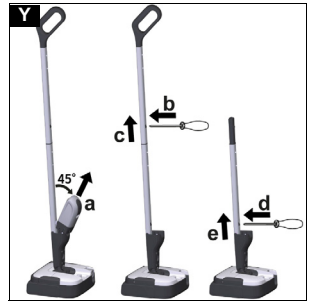
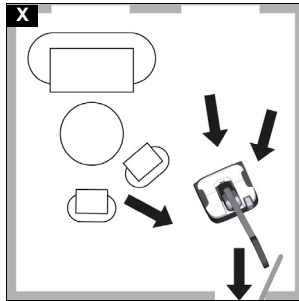
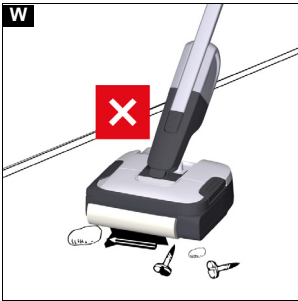
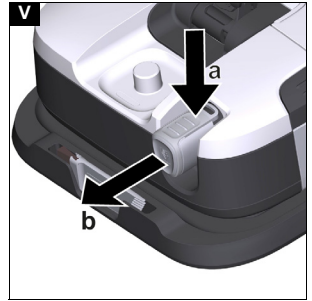
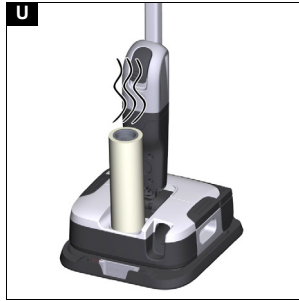
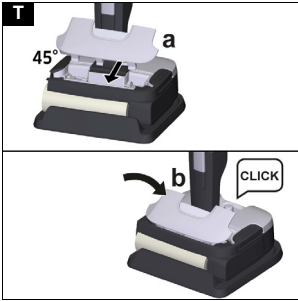
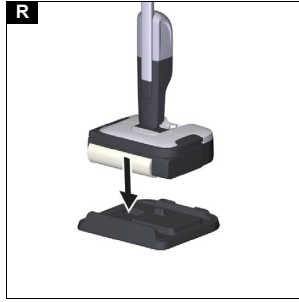
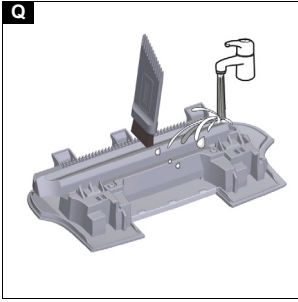
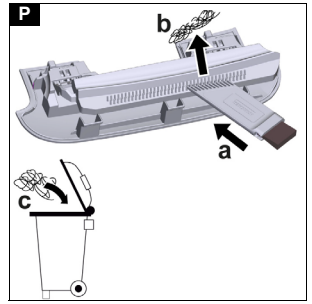
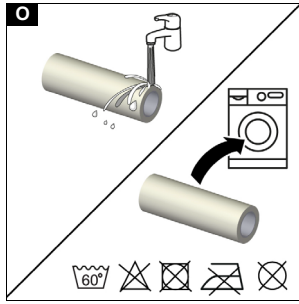
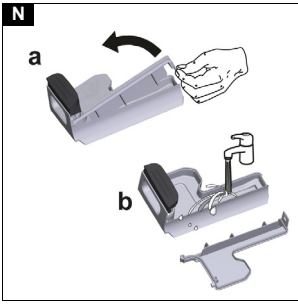

Contents

Intended use.....	5
Environmental protection.....	5
Accessories and spare parts.....	5
Scope of delivery.....	5
Warranty.....	5
Safety instructions.....	5
Symbols on the device.....	6
Description of the unit.....	6
Installation.....	6
Initial startup.....	6
Operation.....	7
Care and service.....	8
Disassembly.....	9
Troubleshooting guide.....	10
Technical data.....	10

Intended use

Use the device exclusively with battery packs and chargers from the KÄRCHER Battery Power 4 V system.

BP 4V

Suitable battery packs are marked with the BP 4 V symbol.



Only charge the battery pack with the chargers approved for charging.

Use the floor cleaner exclusively for hard floor cleaning in your private household and only on waterproof hard floors.

Do not clean water-sensitive floor coverings such as e.g. untreated cork floors, since the moisture can penetrate and damage the floor.

The device is suitable for cleaning PVC, linoleum, tiled, stone, oiled and waxed parquet, laminate and all water-resistant floor coverings.

Environmental protection



The packing materials can be recycled. Please dispose of packaging in accordance with the environmental regulations.



Electrical and electronic devices contain valuable, recyclable materials and often components such as batteries, rechargeable batteries or oil, which - if handled or disposed of incorrectly - can pose a potential danger to human health and the environment. However, these components are required for the correct operation of the device. Devices marked by this symbol are not allowed to be disposed of together with the household rubbish.

Notes on the content materials (REACH)

Current information on content materials can be found at: www.kaercher.de/REACH

Accessories and spare parts

Only use original accessories and original spare parts. They ensure that the appliance will run fault-free and safely.

Information on accessories and spare parts can be found at www.kaercher.com.

Scope of delivery

The scope of delivery for the appliance is shown on the packaging. Check the contents for completeness when unpacking. If any accessories are missing or in the

event of any shipping damage, please notify your dealer.

Warranty

The warranty conditions issued by our relevant sales company apply in all countries. We shall remedy possible malfunctions on your appliance within the warranty period free of cost, provided that a material or manufacturing defect is the cause. In a warranty case, please contact your dealer (with the purchase receipt) or the next authorised customer service site. (See overleaf for the address)

Safety instructions

Read these safety instructions, these original instructions, the safety instructions provided with the battery pack and the original instructions for the battery pack/standard charger supplied before using the device for the first time. Act in accordance with them. Keep the booklets for future reference or for future owners. In addition to the notes in the operating instructions, you also need to take into consideration the general safety regulations and accident prevention guidelines applicable by law.

Hazard levels

⚠ DANGER

- Indication of an imminent threat of danger that will lead to severe injuries or even death.

⚠ WARNING

- Indication of a potentially dangerous situation that may lead to severe injuries or even death.

⚠ CAUTION

- Indication of a potentially dangerous situation that may lead to minor injuries.

ATTENTION

- Indication of a potentially dangerous situation that may lead to damage to property.

Electrical components

⚠ DANGER • Do not immerse the device in water. • Never touch contacts or lines. • Do not expose the device with the battery pack to strong sunlight, heat or fire.

⚠ WARNING • Switch off the device before all care and maintenance work. • The appliance contains electrical components - do not clean the appliance under running water.

⚠ CAUTION • Have repair work carried out by the authorised customer service only. • Check the device and accessories for proper condition and operational safety before each use. Do not use the device if it is damaged.

ATTENTION • Do not insert any objects into the battery mount except for battery packs of the KÄRCHER Battery Power 4 V system.

Safe handling

⚠ DANGER • Risk of asphyxiation. Keep packaging film out of the reach of children.

⚠ WARNING • Only use the device for its proper use. Take into account the local conditions and beware of third parties, in particular children, when working with the device. • Adhere to the respective safety regulations in hazard zones (e.g. service stations). Never op-

erate the device in explosive spaces. ● Children and persons unfamiliar with these instructions are not allowed to operate the device. The age of the operator may be limited by local restrictions. ● The device is not intended for use by children, persons with restricted physical, sensory or mental abilities or persons unfamiliar with these instructions. ● Persons with reduced physical, sensory or mental capabilities and persons lacking experience and knowledge may only use the appliance if they are properly supervised, have been instructed on use of the appliance safely by a person responsible for their safety, and understand the resultant hazards involved. ● Children must not play with the appliance. ● Children must be supervised to prevent them from playing with the appliance. ● Keep the device out of the reach of children when it cools down. ● Children may only perform cleaning work and user maintenance under supervision. ● Keep all parts your body (e.g. fingers, hair) away from the rotating cleaning roller. ● Risk of injury from sharp objects (e.g. splinters). Protect your hands while cleaning the floor head.

⚠ CAUTION ● Do not use the appliance if it has been dropped beforehand, is visibly damaged or if it is leaking. ● Only operate or store the device in accordance with the description or figure. ● Accidents or damage due to the device falling over. Before all actions with or on the device, you must make sure that it is stable. ● Never leave the device unsupervised while it is in operation.

ATTENTION ● Device damage. Never fill the water reservoir with solvents, liquids containing solvents or undiluted acids (e.g. detergents, petrol, paint thinners and acetone). ● Only switch on the device when the fresh water tank and waste water tank are installed. ● Do not pick up sharp or larger objects with the device, such as e.g. glass shards, gravel or toy parts. ● Do not fill the fresh water container with vinegar, decalcification agents, essential oils or similar substances. Avoid taking up these substances with the device. ● Use the device only on hard floors with a watertight coating, such as e.g. varnished parquet, enamelled tiles or linoleum. ● Do not use the device for cleaning carpets or carpeted floors. ● Do not guide the device over the floor grilles of convection heating systems. The device cannot vacuum up the escaping water when it is guided over a floor grille. ● Switch off the device at the main switch/power switch during longer breaks and after use. ● Do not operate the device at temperatures below 0 °C. ● Protect the device from rain. Do not store the device outdoors.

Symbols on the device



⚠ DANGER

Risk of electric shock

The device contains electrical components.
Never clean the device under running water. Do not immerse the device in water.

Description of the unit

The maximum amount of equipment is described in these operating instructions. Depending on the model used, there are differences in the scope of delivery (see packaging).

For the illustrations, refer to the graphics page.

Illustration A

- ① Handle
- ② Fresh water tank
- ③ Unlocking button for hair filter
- ④ Removable hair filter
- ⑤ Unlocking button for device handle
- ⑥ Floor head
- ⑦ Battery pack holder
- ⑧ Battery run time LED display
- ⑨ Battery Pack (KÄRCHER Battery Power 4 V)
- ⑩ Charger (KÄRCHER Battery Power 4 V)
- ⑪ * Quick charger Duo (KÄRCHER Battery Power 4 V)
- ⑫ Cleaning brush
- ⑬ Universal cleaning roller
- ⑭ * Cleaning roller for stone floors
- ⑮ Parking station
- ⑯ Detergent RM 536 (30 ml)
- ⑰ * Detergent RM 536 (500 ml)
- ⑱ * Detergent RM 537 (30 ml)
- ⑲ Raised element for storing the cleaning roller
- ⑳ Waste water tank
- ㉑ Side cover for removing the cleaning roller

* optional

Installation

Installing the device handle

1. Fit the upper part of the device handle into the lower part of the device handle until it audibly latches into place.
2. Hold the basic device firmly.
3. Fit the device handle all the way to the end stop into the basic device until it audibly latches into place. The device handle must sit tightly in the device.

Illustration B

Initial startup

Battery pack charging

1. Charge the battery pack (see operating instructions and safety instructions for the battery pack and the charger).

Fitting the battery pack

1. Press the battery pack into the battery pack holder on the device until it you feel it latch into place.

Illustration C

Fitting the waste water tank

1. Place the device on the floor.
2. Grasp the waste water tank by the recessed grip and insert it into the rail of the floor head.

Illustration D

Installing the roller

1. Press the unlocking button for the side cover and remove the cover.
2. Pay attention to the colour coding on the inner side of the roller and on the roller holder on the device (e.g. purple to purple).
3. Fit the cleaning roller onto the roller holder all the way to the end stop.
Illustration E
4. Install the side cover on the device.

Filling the fresh water tank

1. Grasp the fresh water tank by the recessed grips at the side and remove it from the device (45°).
2. Open the tank cap and turn it to the side.
Illustration F
3. Fill the fresh water tank with cold or lukewarm fresh water.
4. Add KÄRCHER detergent or care agent to the fresh water tank as required.

ATTENTION

Overdosing or underdosing of the detergent or care agent

Can result in poor cleaning results.

Follow the dosage recommendations for the detergent or care agent.

5. Close the tank cap.
6. Fit the fresh water tank into the device.

Illustration G

The fresh water tank must sit tightly in the device.

Operation

General instructions on operation

ATTENTION

Moisture

Material damage to sensitive floors

Check the surface to be cleaned for water sensitivity at an inconspicuous location before using the device.

Do not clean water-sensitive floor coverings such as e.g. untreated cork floors, since the moisture can penetrate and damage the floor.

ATTENTION

Material damage

Damage to the device from pointed, large and/or bulky objects.

The device must not be stored and used on hard coarse dirt and objects, as the parts can get stuck under the waste water tank and cause scratches on the floor and tank.

Before starting work and storing the device, remove objects such as shards, pebbles, screws or toy parts from the floor.

Illustration W

Note

- To avoid striped patterns, test the device on an inconspicuous area before using on sensitive surfaces, e.g. wood or fine stone.
- Do not allow it to remain in one area, but keep it in motion.
- Observe the instructions for the floor covering manufacturer.

Note

Work backwards towards the door so that no footprints are generated on the freshly washed floor.

Illustration X

- Floor cleaning is performed using a to and fro movement at the same speed as when vacuuming.

Note

For an optimum cleaning result, wash the roller in the washing machine at 60 °C before initial use.

ATTENTION

Material damage due to loose roller

This may damage the washing machine.

Place the roller in a laundry net and load the washing machine with extra laundry.

ATTENTION

Damage caused by washing the cleaning roller with fabric softener or using a tumble dryer

Damage to the microfibrres

Do not use fabric softener when cleaning in a washing machine.

Do not dry the roller in a tumble dryer.

Starting work

ATTENTION

Uncontrolled motion

Damage to the device and material damage

The cleaning roller starts rotating as soon as the device is switched on.

Hold the handle tight to prevent the device from moving away independently.

ATTENTION

Fresh water tank or waste water tank not installed

Material damage

Before starting cleaning work, ensure that the fresh water tank is filled with water and the waste water tank is fitted in the device.

1. Pull the handle backwards.

Illustration H

The device switches on.

2. Move the device back and forth until the roller is sufficiently moistened.

Battery run time

The LED on the floor head indicates the battery run time:

- LED lights up when the battery is fully charged and up to a remaining battery run time of 20 %.
- Approx. 4 minutes before the battery is depleted (20% battery life), the LED flashes and the rollers rotate three times in the form of a quick start-stop motion.

Illustration I

Emptying the waste water tank

1. Bring the device handle into a vertical position. The device switches off.
2. Press the waste water tank unlocking button and remove the waste water tank by the recessed grip.
Illustration J

3. Empty the waste water tank through the opening. In the case of stubborn dirt, open and remove the lid of the waste water tank via the side tab and rinse out the waste water tank with fresh water.
Illustration K

4. Fit the waste water tank (see chapter *Fitting the waste water tank*).

Refilling with cleaning fluid

1. Fill the fresh water tank (see chapter *Filling the fresh water tank*).

ATTENTION

Danger from escaping water

Risk of damage

Empty the waste water tank every time the fresh water tank is empty and before filling the fresh water tank to prevent the waste water tank from overflowing.

Interrupting operation

ATTENTION

Damp roller

Moisture damage to sensitive floors

Place the device in the parking station during longer work breaks to prevent damage to sensitive floors through a wet roller.

1. Bring the device handle into a vertical position. The device switches off.
2. Place the device in the parking station.

Illustration R

Finishing operation

1. Bring the device handle into a vertical position. The device switches off.
2. Place the device in the parking station.

Illustration R

ATTENTION

Adhering dirt deposits

Adhering dirt deposits can damage the device in the long term.

It is recommended to clean the device completely after each application.

3. Clean the device (see chapter *Cleaning the device*).

Storing the device

ATTENTION

Liquids/moist dirt

Unpleasant odours can develop if the device contains liquids/moist dirt when stored.

Completely empty the fresh water tank and waste water tank before storing the device.

Use the cleaning brush to remove hair and dirt particles from the hair filter in the floor head cover.

Allow the cleaned roller to dry in the air, e.g. on the floor head pedestal. Do not place the wet roller in an closed cupboard to dry.

1. Allow the empty waste water tank to dry before fitting it into the device.
 2. Place the device in the parking station.
- #### **Illustration R**
3. Remove the roller and clean if necessary (see chapter *Cleaning the roller*).

Place the wet roller to dry on the floor head pedestal.

Illustration S

5. Remove the battery pack (see chapter *Removing the battery pack*).
6. Charge the battery pack, see operating instructions and safety instructions for the battery pack and the charger.
7. Store the device in a dry room.

Illustration U

Removing the battery pack

Note

During longer work breaks, remove the battery pack from the device and secure it against unauthorised use.

1. Bring the device handle into a vertical position. The device switches off.
2. Press the battery pack unlocking button, and pull the battery pack out of the battery pack holder.

Illustration V

Care and service

General instructions

⚠ WARNING

Danger due to the device inadvertently starting up

Risk of injury

Remove the battery pack prior to all work on the device.

Cleaning the device

ATTENTION

Dirt or detergent residues

The waste water tank and hair filter must be cleaned regularly to ensure that dirt does not accumulate in the tank and hair filter. Dirt particles can clog the hair filter and slot if the device is not cleaned after finishing operation. The accumulation of dirt and bacteria can also result in the development of unpleasant odours in the device.

Do not hold the underside of the floor head under water.

1. Bring the device handle into a vertical position. The device switches off.
 2. Empty and clean the waste water tank (see chapter *Cleaning the waste water tank*).
 3. Press the hair filter unlocking button. The hair filter releases.
 4. Remove and clean the hair filter (see chapter *Cleaning the hair filter*).
- #### **Illustration L**
5. Remove and clean the roller (see chapter *Cleaning the roller*).
- #### **Illustration M**
6. If water is still present in the fresh water tank, remove and empty the fresh water tank.
 7. Wipe off dirt and detergent residues on the housing with a damp cloth.

Cleaning the waste water tank

ATTENTION

Adhering dirt deposits

Adhering dirt deposits can damage the device in the long term.

Clean the waste water tank regularly.

For information the waste water tank removal procedure, see chapter *Emptying the waste water tank*.

1. Open the lid of the waste water tank via the side tab and remove it.
2. Clean the waste water tank and cap with fresh water.

Illustration N

3. Alternatively, the waste water tank can be cleaned in a dishwasher.

Cleaning the roller

ATTENTION

Detergent residue in the roller

Foaming

Wash the roller under running water or clean the roller in a washing machine each time after using the device.

ATTENTION

Damage caused by washing the cleaning roller with fabric softener or using a tumble dryer

Damage to the microfibrines

Do not use fabric softener when cleaning in a washing machine.

Do not dry the roller in a tumble dryer.

ATTENTION

Material damage due to loose roller

This may damage the washing machine.

Place the roller in a laundry net and load the washing machine with extra laundry.

1. Bring the device handle into a vertical position.

The device switches off.

2. Place the device in the parking station.

Illustration R

3. Press the unlocking button for the side cover and remove the cover.

4. Pull the cleaning roller out via the recessed grip.

Illustration M

5. Clean the cleaning roller under running water or wash it in the washing machine at max. 60 °C.

Illustration O

6. Clean the roller drive with a moist cloth.

7. To dry, place the wet roller on the pedestal of the floor head.

Illustration S

8. Store the device in a dry room.

Illustration U

Cleaning the hair filter

ATTENTION

Adhering dirt deposits

Adhering dirt deposits can damage the device in the long term.

It is recommended to clean the device completely after each application.

ATTENTION

Adhering dirt deposits

Adhering dirt deposits can damage the device in the long term.

Clean hair filter regularly with the cleaning brush.

ATTENTION

Damage due to cleaning the hair filter in a dishwasher

The washing process can distort the scraper edge and it will no longer press on the roller correctly. This worsens the cleaning result.

Do not clean the hair filter in a dishwasher but rather under running water.

1. Bring the device handle into a vertical position.

The device switches off.

2. Place the device in the parking station.

Illustration R

3. Press the hair filter unlocking button.

Illustration L

The hair filter is released and can be removed.

4. Clean the hair filter under running water.

5. Remove adhering dirt deposits, e.g. in the filter comb, using the cleaning brush.

Illustration P

Illustration Q

6. Fit the hair filter into the floor head at a 45° angle and then press it down until it audibly latches into place. The hair filter must sit tightly in the device.

Illustration T

Cleaning and care agents

ATTENTION

Use of unsuitable detergents and care agents

The use of unsuitable detergents and care agents can damage the device and loss of eligibility for warranty claims.

Use only KÄRCHER detergents.

Take care to ensure the correct dosage.

Note

Use KÄRCHER detergent or care agents for floor cleaning as necessary.

- Observe the manufacturer's dosing quantity recommendations when dosing with detergent or care agents.
- To prevent foaming, fill the fresh water tank with water first and then add the detergent or care agent.
- To prevent the tank from overflowing, be sure to leave enough space for the detergent or care agent when filling with water. To do this, observe the Max marking on the fresh water tank.

Disassembly

Removing the device handle

ATTENTION

Frequent removal of the handle

The handle components can be damaged by repeated removal.

Do not remove the handle from the basic device after assembly.

The handle may only be removed from the basic device when the device is sent out for service purposes.

⚠ CAUTION

Risk of injury

Using a screwdriver on a lock poses the danger of slipping and causing an incision injury.

Use the screwdriver carefully on the lock.

1. Removing the fresh water tank.
2. Using a screwdriver at a 90° angle, press the unlocking button on the upper part of the device handle and remove the upper part of the device handle.

Note: When pressing the unlocking button with the screwdriver, only apply pressure carefully to avoid damage to the device.

Illustration Y

3. Using a screwdriver at a 90° angle, press the unlocking button on the lower part of the device handle and remove the lower part of the device handle.

Troubleshooting guide

Malfunctions often have simple causes that you can remedy yourself using the following overview. When in doubt, or in the case of malfunctions not mentioned here, please contact your authorised Customer Service.

The LED flashes quickly for 30s

The battery pack is overheated.

- Stop operation and allow the device and battery pack to cool down.

The LED flashes five times in quick succession

The battery pack is not recognised.

- Remove the battery pack and press it back into the battery pack holder on the device.

The battery pack must be charged.

- Charge the battery pack (see operating instructions and safety instructions for the battery pack and the charger).

The device does not work

The battery pack is not sitting properly in the device.

- Push the battery pack into the battery pack holder on the device until it latches into place.

The charging state of the battery pack is too low.

- Charge the battery pack, see chapter *Battery pack charging*.

The battery pack or charger is defective.

- Replace the battery pack or charger, see chapter *Intended use*.

The device does not absorb dirt

There is no water in the fresh water tank.

- Refill water in the fresh water tank, see chapter *Refilling with cleaning fluid*.

The fresh water tank is not sitting properly in the device.

- Insert the fresh water tank so that it is firmly seated in the device.

The waste water tank is missing, cannot be fitted into the device or is jammed.

- Place the device on the floor. Grasp the waste water tank by the recessed grip and insert it into the rail of the floor head.

The hair filter is missing or not sitting properly in the device.

- Fit the hair filter correctly in the device.

The roller is dirty or worn out.

- Clean the roller, see chapter *Cleaning the roller*, or replace it.

The roller is too dry

The roller is not being sufficiently moistened.

- Moisten the roller, see chapter *Starting work*.

Poor cleaning result

The roller was not washed before initial use.

- Wash the roller in a washing machine at 60 °C.

The roller is dirty.

- Clean the roller, see chapter *Cleaning the roller*.

The roller is not being sufficiently moistened.

- Moisten the roller, see chapter *Starting work*.

Incorrect detergent or incorrect dosage.

- Use only KÄRCHER detergent and be sure to use the correct dosage.

Foreign detergent residues are present on the floor.

- Thoroughly remove all detergent residues from the roller using water.

- Clean the floor several times using the device and a clean roller, without using detergent.

This removes all detergent residues from the floor.

The water absorption is not optimal

The hair filter is not sitting correctly in the device.

- Fit the hair filter correctly in the device.

The roller is worn out.

- Replace the roller.

The device is losing waste water

The waste water tank is full.

- Empty the waste water tank immediately, see chapter *Emptying the waste water tank*.

The waste water tank is not sitting properly in the device.

- Insert the waste water tank into the device correctly. The waste water tank must sit tightly in the device.

The hair filter is not sitting correctly in the device.

- Fit the hair filter correctly in the device.

The waste water tank is damaged.

- Contact the authorised Customer Service.

The device engages in joints when used

The knobs on the underside of the waste water tank are damaged or worn.

- Contact the authorised Customer Service.

Technical data

FC 2-4

Electrical connection

Voltage	V	3,6 - 3,7
Degree of protection		IPX4
Device protection class		III
Nominal power of device	W	28
Nominal voltage of battery	V	3,6 - 3,7
Max. operating duration with fully charged battery (2.5 Ah)	min	20

Filling quantity

Fresh water tank capacity	ml	200
Waste water tank capacity	ml	100

Dimensions and weights

Weight (without accessories and cleaning fluids)	kg	2.2
Length	mm	220
Width	mm	240
Height	mm	1220

Subject to technical modifications.



THANK YOU!
MERCI! DANKE! ¡GRACIAS!



Registrieren Sie Ihr Produkt und profitieren Sie von vielen Vorteilen.

Register your product and benefit from many advantages.

Enregistrez votre produit et bénéficiez de nombreux avantages.

Registre su producto y aproveche de muchas ventajas.

www.kaercher.com/welcome



Bewerten Sie Ihr Produkt und sagen Sie uns Ihre Meinung.

Rate your product and tell us your opinion.

Évaluer votre produit et dites-nous votre opinion.

Reseñe su producto y díganos su opinión.



www.kaercher.com/dealersearch

Alfred Kärcher SE & Co. KG

Alfred-Kärcher-Str. 28-40

71364 Winnenden (Germany)

