

KM 120/150 R G
KM 120/150 R D
KM 120/150 R LPG

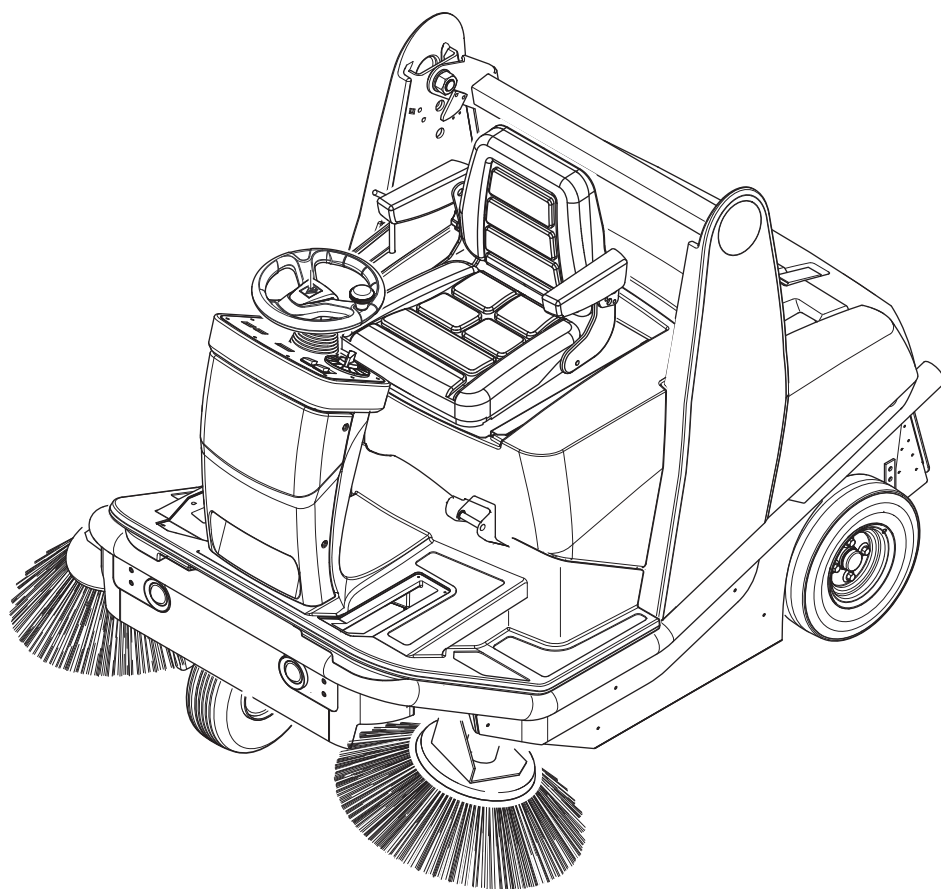

 Register and win!
www.kärcher.com/register-and-win



59637740 09/14



Please read and comply with these original instructions prior to the initial operation of your appliance and store them for later use or subsequent owners.

Before first start-up it is definitely necessary to read the safety indications no. 5.956-250!

Contents

Appliance description	EN . . . 1
Safety instructions	EN . . . 1
General notes	EN . . . 1
Symbols on the machine	EN . . . 2
Symbols in the operating instructions	EN . . . 2
Safety Guidelines for liquified gas vehicles (only KM 120/150 R LPG)	EN . . . 2
Function	EN . . . 3
Proper use	EN . . . 3
Suitable surfaces	EN . . . 3
Environmental protection	EN . . . 3
Operating and Functional Elements	EN . . . 4
Machines without driver cabin	EN . . . 4
Machines with driver cabin	EN . . . 4
Colour coding	EN . . . 4
Opening/closing and securing cover	EN . . . 5
Operator console	EN . . . 6
Before Startup	EN . . . 7
Unloading	EN . . . 7
Moving sweeper without engaging self-propulsion	EN . . . 7
Moving sweeper by engaging self-propulsion	EN . . . 7
Start up	EN . . . 7
General notes	EN . . . 7
Refuelling (only KM 120/150 R G and R D)	EN . . . 7
Connect/ change gas cylinder (only KM 120/150 R LPG)	EN . . . 7
Inspection and maintenance work	EN . . . 8
Operation	EN . . . 8
Adjusting driver's seat	EN . . . 8
Adjusting the external mirror (only KM 120/150 without driver cabin)	EN . . . 8
Switching on/off the wipers (only KM 120/150 without driver cabin)	EN . . . 8
Programme selection	EN . . . 8
Starting the machine	EN . . . 8
Drive the machine	EN . . . 8
Sweeping mode	EN . . . 8
Emptying waste container	EN . . . 9
Turn off the appliance	EN . . . 9
Shutdown	EN . . . 9
Close fuel tap (only KM 120/150 R G and R D)	EN . . . 10
Close gas supply (only KM 120/150 R LPG)	EN . . . 10
Transport	EN . . . 10
Storing the device	EN . . . 10

Maintenance and care	EN . . . 10
General notes	EN . . . 10
Cleaning the inside of the machine	EN . . . 10
External cleaning of the appliance	EN . . . 10
Maintenance intervals	EN . . . 10
Maintenance Works	EN . . . 11
Troubleshooting	EN . . . 16
Technical specifications	EN . . . 17
Accessories	EN . . . 18
Installation set suction hose	EN . . . 18
EC Declaration of Conformity	EN . . . 18
Warranty	EN . . . 18

Appliance description

- KM 120/150 R G = Petrol engine
- KM 120/150 R D = diesel engine
- KM 120/150 R LPG = gas engine

Safety instructions

- The machine (without driver cabin) has been approved for use on surfaces with gradients of up to 18%.
- The machine (with driver cabin) has been approved for use on surfaces with gradients of up to 10%.

General notes

Your sales outlet should be informed about any transit damage noted when unpacking the product.

- Warning and information plates on the machine provide important directions for safe operation.
- In addition to the information contained in the operating instructions, all statutory safety and accident prevention regulations must be observed.

Drive mode

Danger

Risk of injury!

Danger of tipping if gradient is too high.

- Drive up the slopes only with max. 18% gradient (without driver cabin) or 10% (with driver cabin).

Danger of tipping when driving round bends at high speed.

- Drive slowly when cornering.

Danger of tipping on unstable ground.

- Only use the machine on sound surfaces.

Danger of tipping with excessive sideways tilt.

- The gradient perpendicular to the direction of travel should not exceed 10%.
- It is important to follow all safety instructions, rules and regulations applicable for driving motor vehicles.
- The operator must use the appliance properly. He must consider the local conditions and must pay attention to third parties, in particular children, when working with the appliance.
- The appliance may only be used by persons who have been instructed in handling the appliance or have proven qualification and expertise in operating the appliance or have been explicitly assigned the task of handling the appliance.

– The appliance must not be operated by children, young persons or persons who have not been instructed accordingly.

- It is strictly prohibited to take co-passengers.
- Ride-on appliances may only be started after the operator has occupied the driver's seat.

➔ Please remove the ignition key, when not in use, to avoid unauthorised use of the appliance.

➔ Never leave the machine unattended so long as the engine is running. The operator may leave the appliance only when the engine has come to a standstill, the appliance has been protected against accidental movement, if necessary, by applying the immobilization brake and the ignition key has been removed.

➔ Please remove the ignition key, when not in use, to avoid unauthorised use of the appliance.

Appliances with combustion engine

Danger

Risk of injury!

- Do not close the exhaust.
- Do not bend over the exhaust or touch it (risk of burns).
- Do not touch the drive motor (risk of burns).
- Only KM 120/150 R LPG: Ensure that there is adequate ventilation or provision for diverting the exhaust gas while operating the appliance in closed rooms (risk of poisoning).
- Exhaust gases are poisonous and hazardous to health, do not inhale them.
- The engine requires approx. 3-4 seconds to come to a standstill once it has been switched off. During this time, stay well clear of the working area.

Machines with driver cabin

Note

The driver cabin only provides protection against weather; it is not a safety roof or a lock against overrolling!

Danger

The plastic sheet doors of the driver cabin have ventilation slots. Always leave these open to ensure adequate ventilation.



Risk of hearing impairment. Always use proper ear-protection aids while working with the appliance.

Accessories and Spare Parts

- Only use accessories and spare parts which have been approved by the manufacturer. The exclusive use of original accessories and original spare parts

ensures that the appliance can be operated safely and trouble free.

- At the end of the operating instructions you will find a selected list of spare parts that are often required.
- For additional information about spare parts, please go to the Service section at www.kaercher.com.

Symbols on the machine

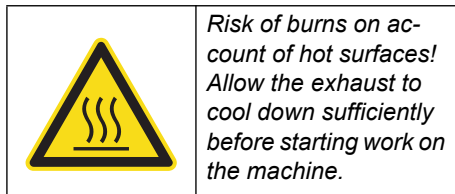

Symbols in the operating instructions

⚠ DANGER

Immediate danger that can cause severe injury or even death.

⚠ WARNING

Possible hazardous situation that could lead to severe injury or even death.

CAUTION

Possible hazardous situation that could lead to mild injury to persons or damage to property.

Safety Guidelines for liquefied gas vehicles (only KM 120/150 R LPG)

Hauptverband der gewerblichen Berufsgenossenschaften e.V. (HVBG / Germany). Liquefied gases (propellants) are butane and propane or a mixture of butane/propane. They are available in special cylinders. The operating pressure of these gases depends on the outside temperature.

⚠ Danger

Risk of explosion! Do not handle liquefied gas like petrol. Petrol evaporates slowly, liquefied gas immediately turns into gas. The risk of gas spreading in the room and getting ignited is thus higher in case of liquefied gas than in petrol.

⚠ Danger

Risk of injury! Use only liquefied gas cylinders with propellant filled according to DIN 51622 of A or B quality, depending on the surrounding temperature.

CAUTION

Use of cooking gas is strictly prohibited. For the gas engine, use only liquid gas mixtures of propane/ butane or their mixtures where the mixing ratio lies between 90/10 to 30/70. On account of better cold start behaviour even at low outside sub-zero temperatures (below 0° C / 32 °F) always prefer a mixture with a higher propane share because evaporation takes place even at low temperatures.

Liabilities of the factory management and the employee

- All persons handling liquid gases are liable to acquaint themselves with the special properties of the liquefied gases for hazard-free handling of operations. The current documentation is always to be kept with the sweeper.

Maintenance by expert

- Propellant-operated units are to be checked at regular intervals, at least once a year, by an expert against leaks (according to BGG 936) and ensure that the unit is functioning properly.
- The inspection must be certified and documented. The inspection guidelines are § 33 and § 37 UVV (occupation accident prevention regulations) "Use of liquid gas" (BGV D34).
- General applicable regulations are the guidelines for inspecting vehicles whose engines are driven by liquefied gases of the Federal Transportation Minister.

Commissioning/Operations

- Gas must always be drawn only from one cylinder. Drawing gas from multiple cylinders simultaneously can cause liquid gas from one cylinder flowing into the other. This causes the over-filled cylinder to be subjected to an unpermitted excess pressure when the cylinder valve is closed later (refer B.1 of these guidelines).

- Ensure the correct positioning of the cylinder with the "top" marking while connecting a full cylinder (the connection screw points vertically upward).

Perform the replacement of the gas cylinder carefully. During assembly and disassembly, the gas outlet nozzle of the cylinder valve must be sealed by means of a cap nut that is tightened using a wrench.

- Discontinue the use of leaky gas cylinders. Such cylinders are to be emptied by slowly letting out the gas in open spaces by conforming to all safety regulations and are to be indicated as leaky. Also inform the issuing company or its representative (the filling-station attendant) in writing about the damage to the cylinder while delivering or receiving the cylinders.
- Before connecting the gas cylinder, check that its connection neck is in a proper state.
- After connecting the cylinder, regularly check that it is not leaky by using a foaming agent.
- Open the valves slowly. Do not use hammers to open and close the cylinders.
- Use only dry fire extinguishers (with carbonic acid gas) in case of fire caused by liquefied gases.
- The entire LPG unit must be continuously checked to ensure that there are no leaks and the unit is functioning properly. Using the vehicle with a leaky gas unit is strictly prohibited.
- First close the cylinder valve before loosening the pipe or tube connection. Unscrew and loosen the connection nut of the gas cylinder slowly because otherwise the gas under pressure in the tube will flow out instantly.
- If the gas is refilled from a larger tank, then ask the sales agent of the LPG about the important regulations to be followed.

⚠ Danger

Risk of injury!

- *LPG in a liquid state can cause frost bites on bare skin.*
- *After disconnecting the cylinder, tighten the closing nut firmly on the connecting threading of the cylinder.*
- *Use soap water or some such foaming agent to check whether the cylinder is leaking. The use of open flames to illuminate the LPG unit is strictly prohibited.*
- *Follow the manufacturer's installation specifications while changing individual parts of the LPG unit. Close all cylinder and locking valves while doing so.*
- *Regularly check the status of the electrical unit of the LPG vehicles. Sparks can cause explosions if the gas-carrying parts of the unit are leaky.*
- *If a LPG-driven vehicle has been idling for a long time, then first ventilate the*

setting room before commissioning the vehicle or its electrical unit.

- Immediately inform the trade association and the concerned trade supervisory authority about accidents with gas cylinders or LPG units. Store the damaged parts carefully until all investigations have been completed.

In the installation and storage rooms as well as the workshops

- Propellants or LPG cylinders must always be stored according to the regulations of TRF 1996 (Technical Regulations for Liquid Gases, refer DA to BGV D34, Appendix 4).
- Always store the gas cylinders in a vertical position. Use of open flames and smoking at the installation site of the cylinders and during repairs is strictly prohibited. Protect the stored cylinders against unauthorised access. Close all empty cylinders properly.
- Close the cylinder and main locking valves immediately when you switch off the vehicle.
- Follow the regulations for garages and the construction guidelines of the respective State about the location and structure of the parking areas for LPG-driven vehicles.
- Gas cylinders are to be stored in separate rooms away from the parking areas (refer DA to BGV D34, Appendix 2).
- The electrical hand-held lamps used in the rooms are to be equipped with closed, sealed case and a strong protection cover.
- Close all cylinder and main valves before working in repair workshops and protect the gas cylinders against effect of external heat.
- A responsible person must check that all valves, especially the cylinder valves, are closed during operational breaks and before closing the factory. Do not carry out any jobs involving fire – such as cutting and welding jobs – in the vicinity of the gas cylinders. Do not store gas cylinders, not even empty ones, in the workshops.
- The parking and storage rooms and the repair workshops must be ventilated properly. Please note that liquefied gases are heavier than atmospheric air. They get collected on the floor, in recesses and other holes in the floors and form a gas-air mixture that can lead to explosions.

Function

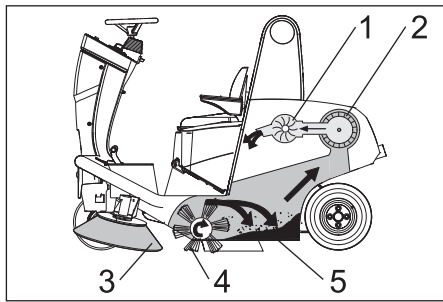

Figure 1

The sweeper operates using the overthrow principle.

- The side brushes (3) clean the corners and edges of the surface, moving dirt and debris into the path of the roller brush.
- The rotating roller brush (4) moves the dirt and debris directly into the waste container (5).
- The dust raised in the container is separated by the dust filter (2) and the filtered clean air is drawn off by the suction fan (1).

Proper use

Use this appliance only as directed in these operating instructions.

- ➔ The machine with working equipment must be checked to ensure that it is in proper working order and is operating safely prior to use. Otherwise, the appliance must not be used.
- This sweeper has been designed to sweep dirt and debris from outdoor surfaces.
- Only KM 120/150 R LPG: This sweeper is also suitable for sweeping dirty floors in closed spaces provided the same are ventilated adequately.
- The machine can only be used on public highways with the StVZO extension kit.
- The machine is not suitable for vacuuming dust which endangers health.
- The machine may not be modified.
- Never vacuum up explosive liquids, combustible gases or undiluted acids and solvents. This includes petrol, paint thinner or heating oil which can generate explosive fumes or mixtures upon contact with the suction air. Acetone, undiluted acids and solvents must also be avoided as they can harm the materials on the machine.
- Do not sweep/vacuum up any burning or glowing objects.
- The machine is only suitable for use on the types of surfaces specified in the operating instructions.
- The machine may only be operated on the surfaces approved by the company or its authorised representatives.
- The machine may not be used or stored in hazardous areas. It is not allowed to

use the appliance in hazardous locations.

- The following applies in general: Keep highly-flammable substances away from the appliance (danger of explosion/fire).

Suitable surfaces

- Asphalt
- Industrial floor
- Screed
- Concrete
- Paving stones

Environmental protection

	The packaging material can be recycled. Please do not throw the packaging material into household waste; please send it for recycling.
	Old appliances contain valuable materials that can be recycled; these should be sent for recycling. Batteries, oil, and similar substances must not enter the environment. Please dispose of your old appliances using appropriate collection systems.

Please do not release engine oil, fuel oil, diesel and petrol into the environment. Protect the ground and dispose of used oil in an environmentally-clean manner.

Notes about the ingredients (REACH)

You will find current information about the ingredients at:

www.kaercher.com/REACH

Operating and Functional Elements

Machines without driver cabin

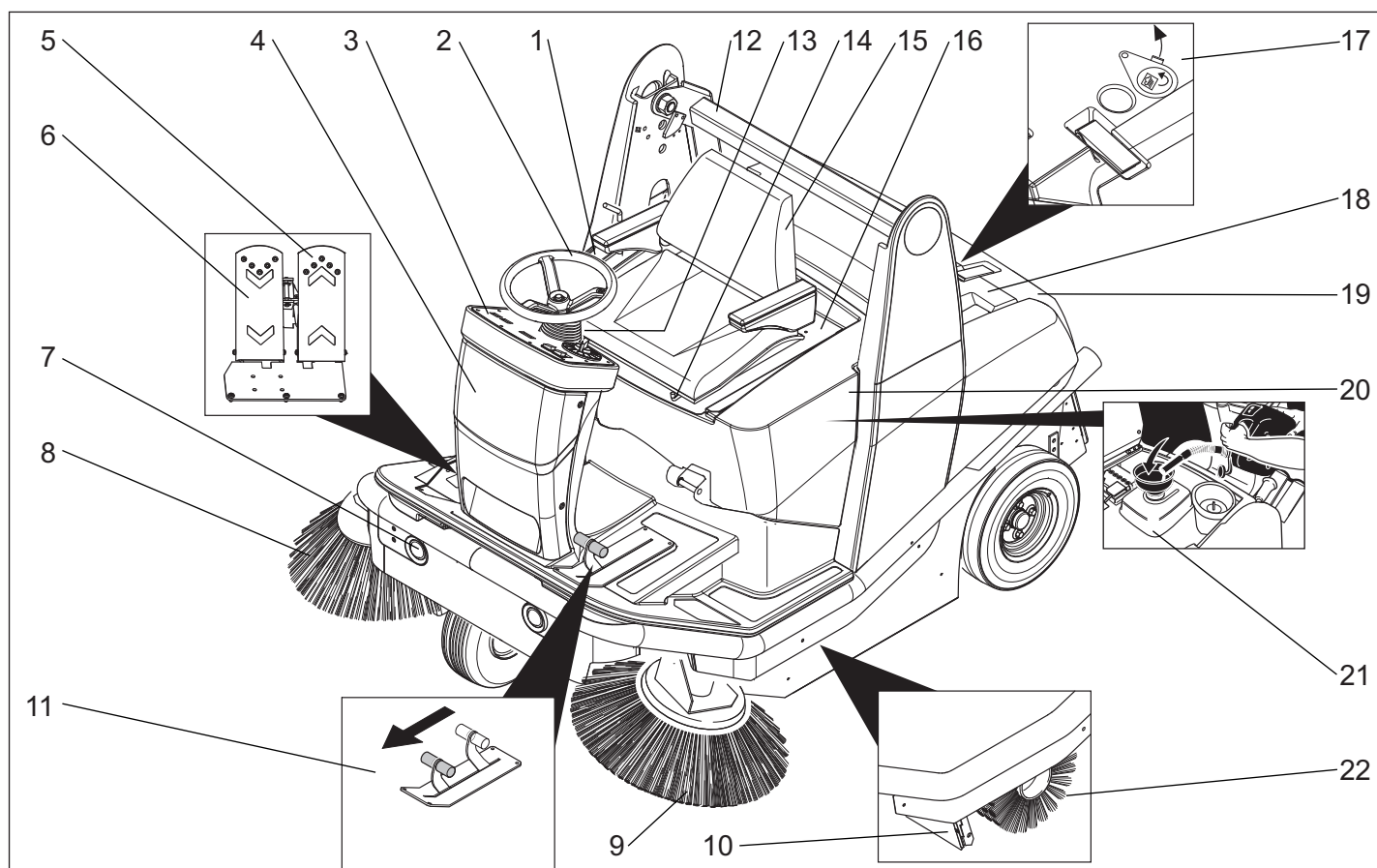

Figure 2a

- 1 Operator control unit for waste container and parking brake
- 2 Steering wheel
- 3 Operator console
- 4 Fuses (behind front panel)
- 5 Accelerator pedal, forwards
- 6 Accelerator pedal, reverse
- 7 Lights
- 8 Right side brush
- 9 Left side brush
- 10 Bulk waste flap
- 11 Pedal for raising/lowering bulk waste flap
- 12 Lift/tilt emptying mechanism
- 13 Lever for steering wheel adjustment
- 14 Lever for seat adjustment
- 15 Seat (with seat contact mat)
- 16 Seat bracket
- 17 Wet/dry flap
- 18 Filter case
- 19 Waste container
- 20 Cover
- 21 Tank
- 22 Roller brush
- 23 Gas cylinder (only KM 120/150 R LPG)
- 24 Installation set suction hose (option)

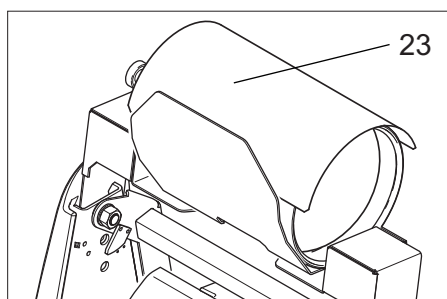

Figure 2b

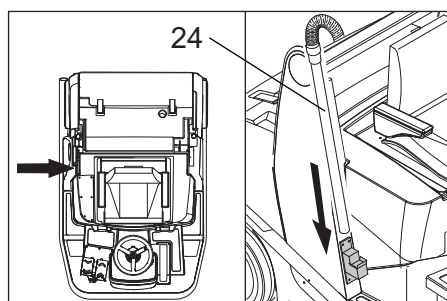

Figure 2c

Machines with driver cabin

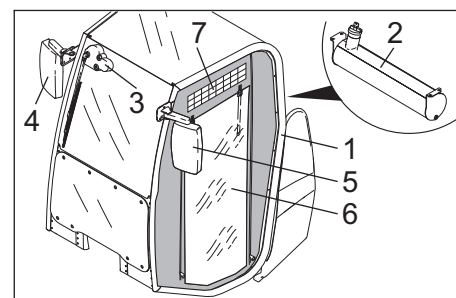

Figure 2d

- 1 Driver cabin (optional)
- 2 Tank
- 3 Turn on/off the wipers
- 4 Right exterior mirror
- 5 Left exterior mirror
- 6 Plastic sheet doors
- 7 Ventilation slots

Colour coding

- The operating elements for the cleaning process are yellow.
- The controls for the maintenance and service are light gray.

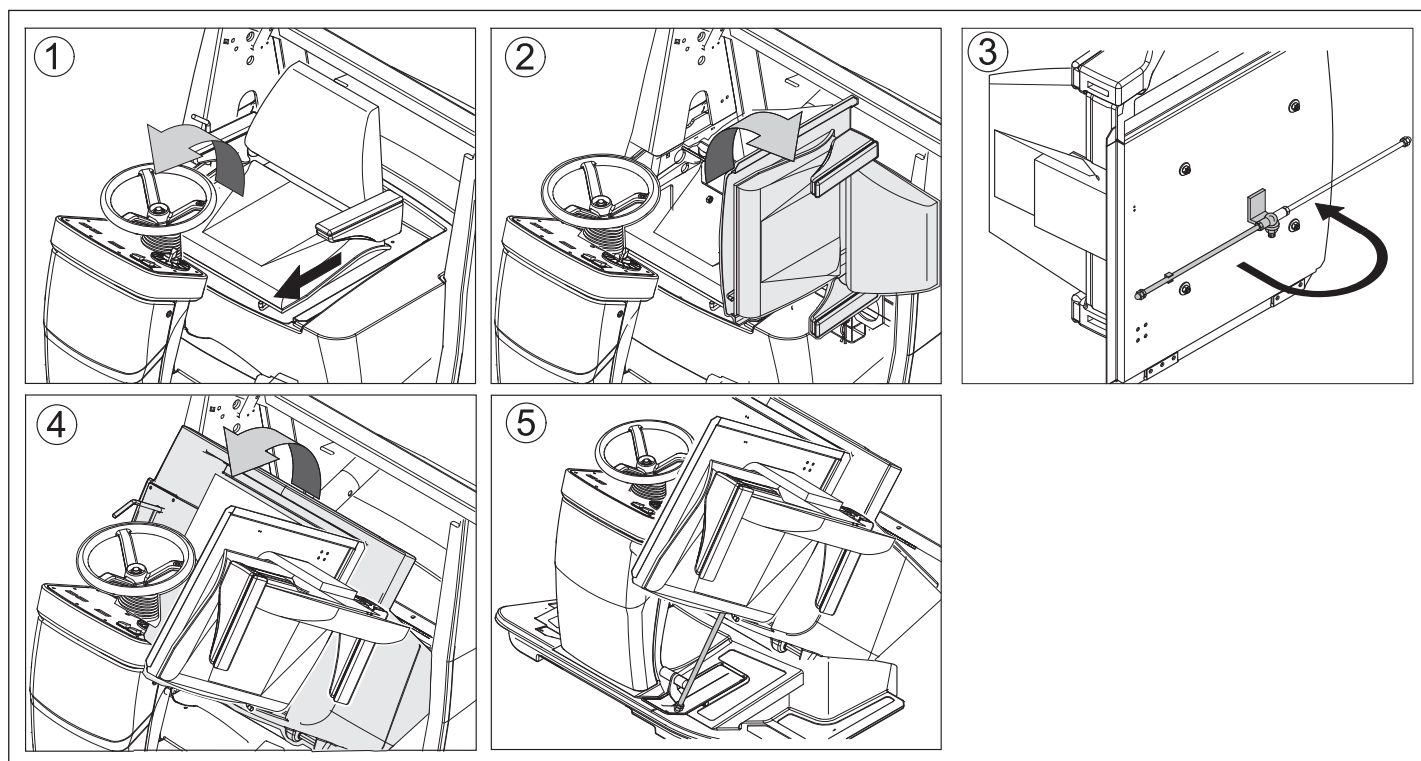

Figure 3

⚠ Danger

Risk of injury! When open, the cover must be propped up using the retaining rod.

Figure 1

- ➔ Operate steering wheel adjustment lever and fold steering wheel forwards.
- ➔ Operate seat adjustment lever and slide seat forwards.

Figure 2

- ➔ Fold seat bracket to the side.

Figure 3

- ➔ Fold out retaining rod.
(only 120/150 KM without driver cabin)

Figure 4

- ➔ Fold cover forwards.

Figure 5

- ➔ Insert retaining rod into the recess next to the bulk waste flap pedal.
(only 120/150 KM without driver cabin)

Follow this sequence in reverse order to close the cover.

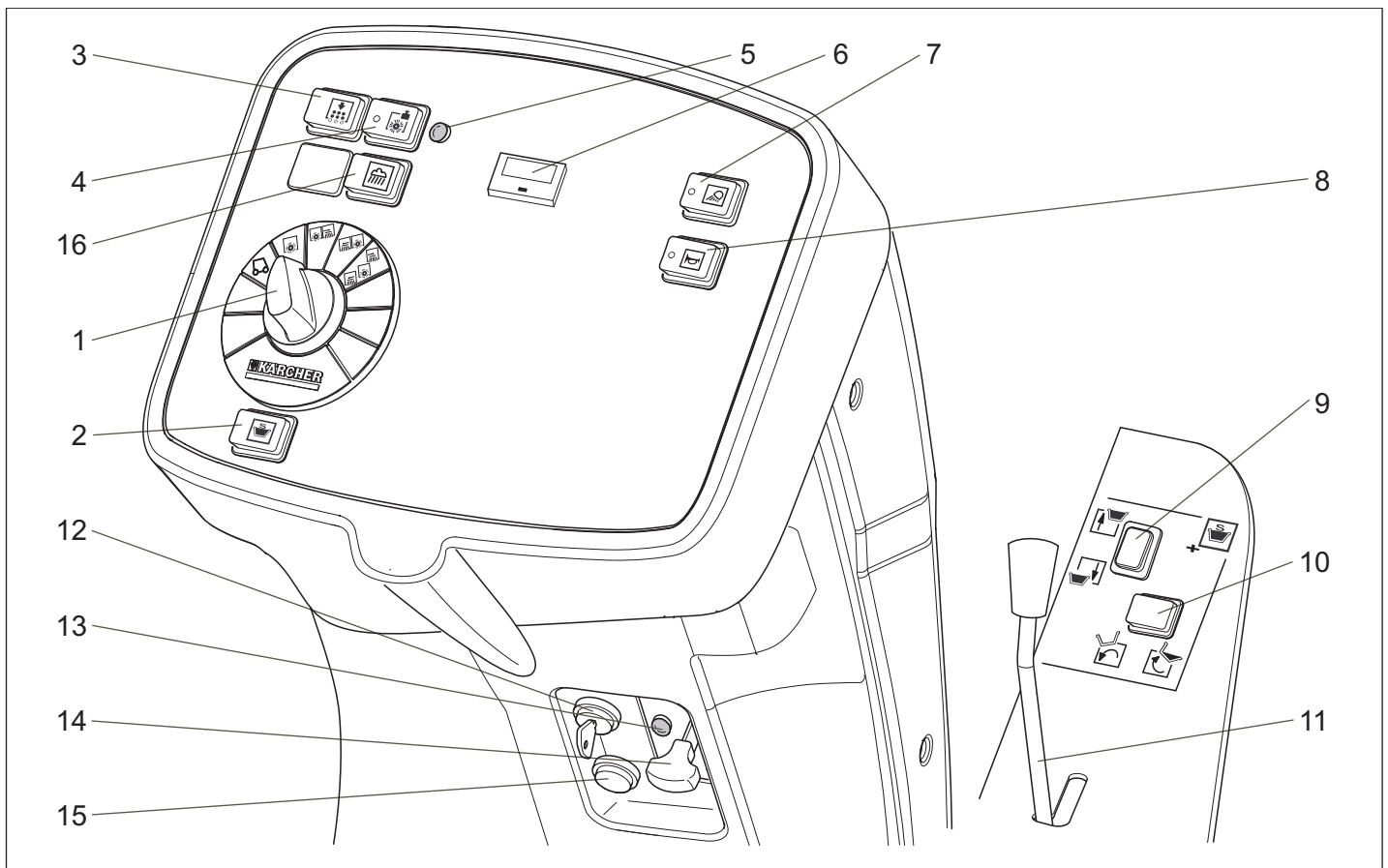

Figure 4

- 1 Programme switch
- 2 Switch two-hand operations Lift/tilt emptying mechanism
- 3 Button for filter shaker system
- 4 Button for power-operating mode
- 5 Indicator lamp for power-operating mode
- 6 Elapsed-time counter with reset button
- 7 Switch for working lamp
- 8 Horn switch
- 9 Raise/lower waste container
- 10 Tilt waste container outwards/inwards
- 11 Parking brake
- 12 Ignition lock
- 13 Charge indicator lamp (only KM 120/150 R D and LPG)
- 14 Choke (only KM 120/150 R G)
- 15 Remote button (only KM 120/150 R LPG)
- 16 Wet cleaning switch, installation set suction hose (option)

Before Startup

Unloading

⚠ Warning

Do not use a forklift truck to unload the machine as this may damage it.

To unload the machine, proceed as follows:

- Cut plastic packing belt and remove foil.
- Connect battery (see section on Care and maintenance)
- Remove the elastic tape fasteners at the stop points.
- Four indicated floor boards of the pallet are fastened with screws. Unscrew these boards.
- Place the boards on the edge of the pallet. Place the boards in such a way that they lie in front of the four wheels of the machine. Fasten the boards with screws.

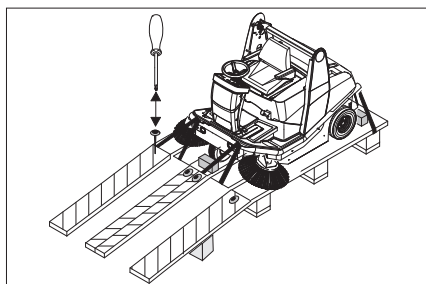

- Slide the four support beams included in the packaging under the ramp.
- Remove the wooden blocks used for arresting the wheels and slide them under the ramp.

The machine can be moved in 2 ways:

- (1) By pushing it (see Moving sweeper without engaging self-propulsion).
- (2) By driving it (see Moving sweeper by engaging self-propulsion).

Moving sweeper without engaging self-propulsion

⚠ Danger

Risk of injury! Before engaging the free-wheel operation, the machine must be secured to prevent it rolling away.

- Lock parking brake.
- Open cover and secure it (Diag. 3).

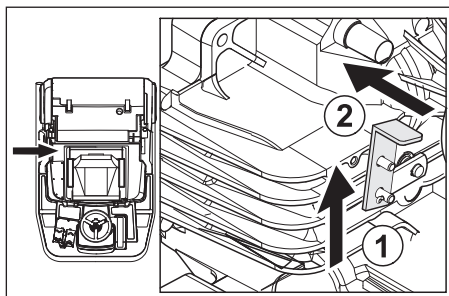

- Engage free-wheel lever in hole. This blocks the travel drive function.
 - Close cover.
 - Release parking brake.
- The machine can now be pushed.

Note

Do not move the machine for long distances without engaging self-propulsion, a speed of 6 km/h should not be exceeded.

Moving sweeper by engaging self-propulsion

- Unhook the free wheel lever.
- The travel drive is now ready for operation.
- Close cover.
 - Release parking brake.
- The appliance can now be driven.

Start up

General notes

- Park the sweeper on an even surface.
- Remove ignition key.
- Lock parking brake.

Refuelling (only KM 120/150 R G and R D)

Refuelling the machine

⚠ Danger

Risk of explosion!

- Only use the fuels specified in the Operations Manual.
- Do not refuel the machine in enclosed spaces.
- Smoking and naked flames are strictly prohibited.
- Ensure that no fuel reaches the hot open surfaces.
- Switch off engine.
- Only KM 120/150 without driver cabin: Open cover and secure it (Diag. 3).
- Open fuel filler cap.
- Insert funnel provided.
- KM 120/150 R G: Use regular unleaded petrol.
- KM 120/150 R D: Use diesel.
- Fill tank to max. 1 cm below the lower edge of the filler nozzle.
- Wipe off any spilt fuel, remove funnel and close fuel filler cap.
- Only KM 120/150 without driver cabin: Close cover.

Resetting fuel gauge

Note

After the machine is switched on, the number of operating hours is displayed for 10 seconds. The fuel gauge is then automatically displayed.

Note

The fuel gauge shows the length of time the machine has been in operation since the elapsed-time counter was last reset.

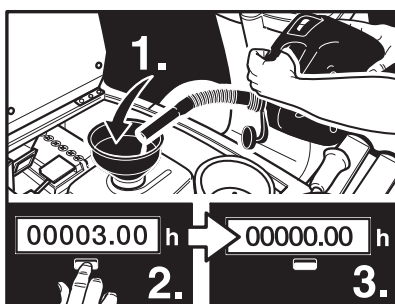

Note

The machine can be operated for a maximum of 3 hours on a full tank.

- Press reset button (2) on the elapsed-time counter.

Connect/ change gas cylinder (only KM 120/150 R LPG)

⚠ Warning

Only use replacement cylinders with 11 kg contents of tested models.

⚠ Danger

Risk of injury!

- Follow safety regulations for LPG vehicles.
- Formation of crusts and yellow-frothing deposits on the gas cylinder indicate leakiness.
- Cylinders must be changed only by instructed persons.
- Cylinders containing propellant gases must not be changed in garages and underground areas.
- Do not smoke and use uncovered light while changing the cylinder.
- While changing cylinders, first close the locking valve of the LPG cylinder firmly and immediately put the protective cap on the empty cylinder.

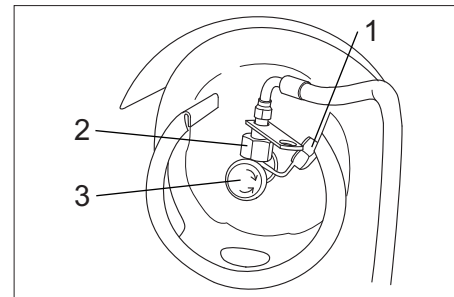

- Place the cylinder in such a way that the connection threading of the locking valve vertically points upwards.
- Close the bracket closure.
- Attach safety splint.
- Remove protective lid (1) from the connection valve of the cylinder.
- Connect the gas tube with Union nut (2) (use 30 mm spanner).

Note

Connection has a left threading.

⚠ Warning

Open the gas drawing valve (3) only after starting the appliance (refer chapter Starting the appliance).

Inspection and maintenance work

- Check engine oil level. *
- Only KM 120/150 R G and R D: Check fill level of fuel tank. *
- Only KM 120/150 R LPG: Check and ensure that the Union nut is fixed properly on the gas tube. *
- Check hydraulics fluid fill level. *
- Check side brush. *
- Check roller brush. *
- Empty waste container.
- Check tyre pressure. *

* For description, see section on Care and maintenance.

Operation

⚠ Warning

The air inlets next to the driver's seat must not be covered. Do not store any objects next to or behind the seat.

Adjusting driver's seat

- Pull seat adjustment lever outwards.
- Slide seat, release lever and lock in place.
- Check that the seat is properly locked in position by attempting to move it backwards and forwards.

Adjusting the external mirror (only KM 120/150 without driver cabin)

- Adjust the left and right exterior mirror manually.

Switching on/off the wipers (only KM 120/150 without driver cabin)

- Press the switch for windscreen washer system.

Programme selection

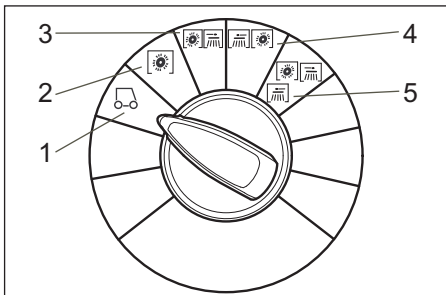

- 1 Driving
Driving to the Place of Use.
- 2 Sweeping with sweep roller
Roller brush is lowered.
- 3 Sweeping with right side brush
Sweep roller and right side brush are lowered.
- 4 Sweep using left side brush (optional)
Sweep roller and left side brush are lowered.
- 5 Sweep using both brushes (optional)
Sweep roller and both brushes are lowered.

Starting the machine

Note

The machine is equipped with a seat contact mat. If the driver's seat is vacated, the machine is switched off.

NOTICE

Only KM 120/150 R G and R LPG: Device starts only if the immobilising brakes are applied (parking position).

Open fuel tap (only KM 120/150 R G and R D)

Note

The fuel cock is supplied from the factory open. If the machine has been out of use for a longer period of time, open the fuel cock.

- Open cover and secure it (Diag. 3).

KM 120/150 R G:

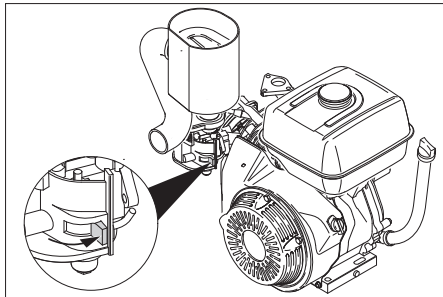

- Push lever in "ON" direction.

KM 120/150 R D:

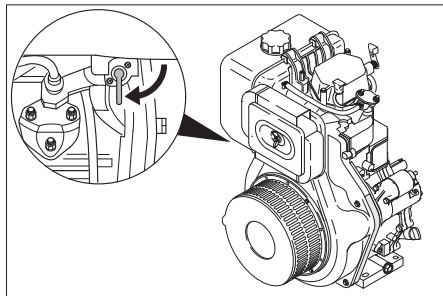

- Turn lever to position "O".

- Close cover.

Open gas supply (only KM 120/150 R LPG)

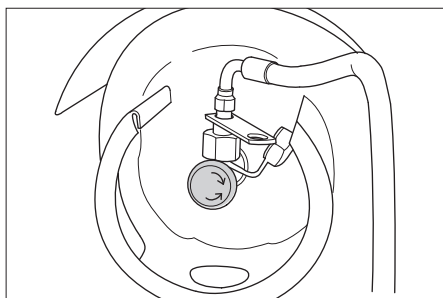

- Open the gas drawing valve by turning it in anti-clockwise direction.

Turning on the Appliance

- Lock parking brake.
- Sit on the driver's seat.
- Do NOT press the accelerator pedal.
- Set programme switch to step 1 (driving).
- Only KM 120/150 R G: Press choke lever downwards. Once the engine is running, pull choke lever back up.

- Only KM 120/150 R LPG: Press remote switch for 5 seconds, then release it.

- Turn ignition key past position 1.

- If the machine starts, release the ignition key.

Note

Never operate the starter motor for longer than 10 seconds. Wait at least 10 seconds before operating the starter motor again.

Note

Operation during winter: When starting at temperatures below +10 °C, the parking brake is to be applied to disengage the engine from the transmission and therefore assist the starting process.

Drive the machine

- Release parking brake.

Drive forward

- Press right accelerator pedal down slowly.

Reverse drive

⚠ Danger

Risk of injury! While reversing, ensure that there is nobody in the way, ask them to move if somebody is around.

- Press left accelerator pedal down slowly.

Note

Driving method

- The accelerator pedal can be used to vary the driving speed infinitely.
- Avoid pressing the pedal suddenly as this may damage the hydraulic system.
- In the event of power loss on inclined surfaces, slightly reduce the pressure on the accelerator pedal.

Brakes

- Release the accelerator pedal, the machine brakes automatically and stops.

Driving over obstacles

Driving over fixed obstacles which are 50 mm high or less:

- Drive forwards slowly and carefully.

Driving over fixed obstacles which are more than 50 mm high:

- Only drive over these obstacles using a suitable ramp.

Sweeping mode

⚠ Danger

Risk of injury! If the bulk waste flap is open, stones or gravel may be flung forwards by the roller brush. Make sure that this does not endanger persons, animals or objects.

⚠ Warning

Do not sweep up packing strips, wire or similar objects as this may damage the sweeping mechanism.

⚠ Warning

To avoid damaging the floor, do not continue to operate the sweeping machine in the same position.

Note

To achieve an optimum cleaning result, the driving speed should be adjusted to take specific situations into account.

Note

During operation, the waste container should be emptied at regular intervals.

Note

When cleaning surfaces, only lower the roller brush.

Note

Also lower side brush when cleaning along edges.

Sweeping with roller brush (basic-operating mode)**Note**

Two operating modes are possible with the roller brush. In the basic-operating mode, the roller brush is only subjected to a small amount of wear and tear.

- ➔ Set programme switch to step 2. Roller brush is lowered.

Sweeping with roller brush (power-operating mode)**Note**

Two operating modes are possible with the roller brush. Power-operating mode increases cleaning performance.

- ➔ Set programme switch to step 2. Roller brush is lowered.



- ➔ Press power button. Indicator lamp lights up.

Note

The following actions reset the power button automatically:

- Press the power button again.
- Set programme switch to step 1 (driving).
- Switching off the machine.

The indicator lamp goes out and the basic-operating mode is activated.

Note

To sweep up larger items with a height of 60 mm, e.g. soft drink cans, the bulk waste flap must be raised briefly.

Sweeping with bulk waste flap raised

Raising bulk waste flap:

- ➔ Press the pedal for the bulk waste flap forwards and keep pressed down.
- ➔ To lower it, take foot off pedal.

Note

An optimum cleaning result can only be achieved if the bulk waste flap has been lowered completely.

Sweeping with side brushes

To sweep in edge area on right-hand side:

- ➔ Set programme switch to step 3. The right side brush and roller brush are lowered.

To sweep in edge area on left-hand side:

- ➔ Set programme switch to step 4. The left side brush and roller brush are lowered.

To sweep in edge areas on right- and left-hand side:

- ➔ Set programme switch to step 5. Both side brushes and roller brush are lowered.

Note

Roller brush and side brush start operating automatically.

Sweeping dry floors

- ➔ Close wet/dry flap on waste container. Installation set suction hose (option):

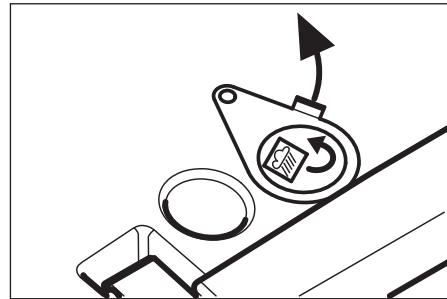

- ➔ Press wet sweeping button repeatedly.

Sweeping damp or wet floors

- ➔ Open wet/dry flap on waste container. Installation set suction hose (option):
- ➔ Press wet sweeping button.

Note

This protects the filter from moisture.

Emptying waste container**Note**

Wait until the automatic filter shaking process is finished and the dust has settled before you open or empty the waste container.

⚠ Danger

Risk of injury! When emptying the waste container, care should be taken to ensure that no persons or animals are within its swivelling range.

⚠ Danger

Danger of crushing. Never reach into the rod assembly for the drainage mechanism. Stay away from the area under the raised container.

⚠ Danger

Danger of tipping. Place the machine on an even surface during emptying.

- ➔ Stop the machine.
- ➔ Set programme switch to step 1 (driving).

Note

The container can only be tilted and emptied once a set minimum level has been reached.

Note

A two-handed operation is required to carry out the following steps.

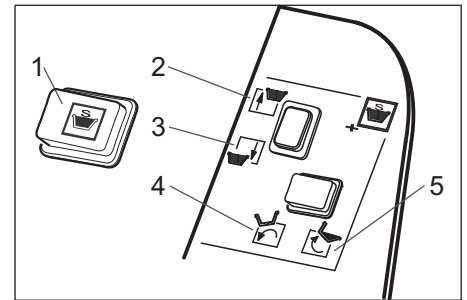

- ➔ Raise waste container. Press button 1 (operator console) and 2 simultaneously.

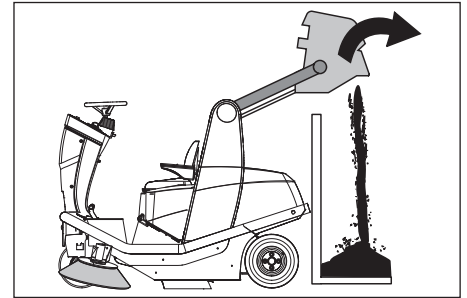

Once the required height has been reached:

- ➔ Tip waste container out. Press button 1 (operator console) and 5 simultaneously.
- ➔ Tip waste container back in. Press button 1 (operator console) and 4 simultaneously.
- ➔ Lower waste container. Press button 1 (operator console) and 3 simultaneously.

Note

The container can only be fully retracted if it is tipped back into its starting position beforehand.

Turn off the appliance

- ➔ Set programme switch to step 1 (driving). The side brush and roller brush are raised.
- ➔ Turn ignition key to "0" and remove it.
- ➔ Lock parking brake.

Note

Once the machine has been switched off, the dust filter is shaken automatically for approx. 15 seconds.

Shutdown

If the sweeper is going to be out of service for a longer time period, observe the following points:

- ➔ Park the sweeper on an even surface.
- ➔ Only KM 120/150 R G and R D: Fill fuel tank and close fuel cock.
- ➔ Only KM 120/150 R LPG: Close the gas cylinder valve and remove the cylinder. Store the gas cylinder according to the safety regulations for LPG vehicles.
- ➔ Change engine oil.
- ➔ Set programme switch to step 1 (driving). The roller brush and side brushes are raised to prevent the bristles being damaged.
- ➔ Turn ignition key to "0" and remove it.

- Only KM 120/150 R G and R LPG: Unscrew spark plugs and pour approx. 3 cm³ of oil into the spark plug hole. Crank the engine several times before replacing the spark plug. Screw in the spark plug.
- Secure sweeper to prevent it rolling away, lock parking brake.
- Clean the inside and outside of the sweeper.
- Park the machine in a safe and dry place.
- Disconnect battery.
- Charge battery approx. every 2 months.

Close fuel tap (only KM 120/150 R G and R D)

- Open cover and secure it (Diag. 3).
KM 120/150 R G:

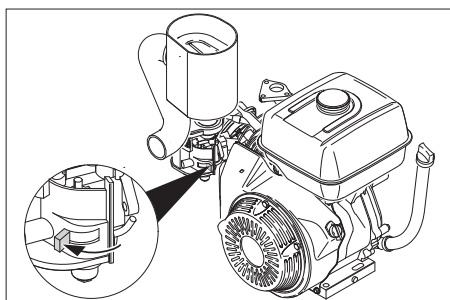

- Push lever in "OFF" direction.

KM 120/150 R D:

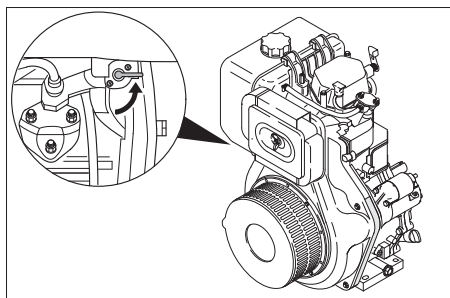

- Turn lever to position "S".
- Close cover.

Close gas supply (only KM 120/150 R LPG)

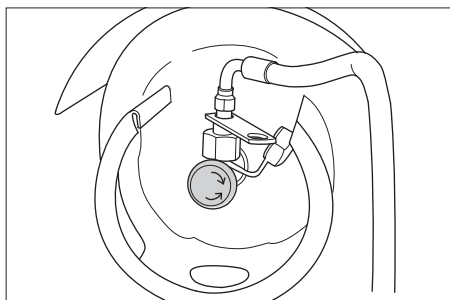

- Close gas drawing valve by turning it in clock-wise direction.

Transport

CAUTION

Risk of injury and damage! Observe the weight of the appliance when you transport it.

⚠ Warning

In general, when shipping the machine, the freewheel lever must be engaged in the upper hole. Only once this has been done, will the travel drive be ready for operation. The machine must always be moved up or down slopes by engaging self-propulsion.

- Turn ignition key to "0" and remove it.
- Only KM 120/150 R G and R D: Empty tank. Draw off fuel using suitable pump.
- Only KM 120/150 R LPG: Close the gas cylinder valve and remove the cylinder. Store the gas cylinder according to the safety regulations for LPG vehicles.
- Secure the wheels of the machine with wheel chocks.
- Secure the machine with tensioning straps or cables.
- Lock parking brake.

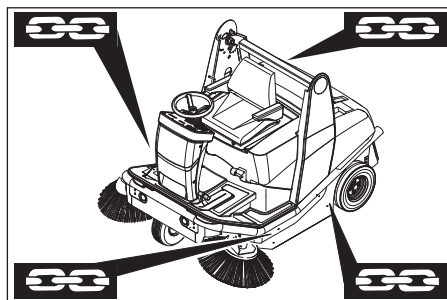

Note

Observe markings for fixing points on base frame (chain symbols). When loading or unloading the machine, it may only be operated on gradients of max. 18%.

Storing the device

CAUTION

Risk of injury and damage! Note the weight of the appliance in case of storage. Park the machine in a safe and dry place.

Maintenance and care

General notes

- First switch off the appliance and remove the ignition key before performing any cleaning or maintenance tasks on the appliance, replacing parts or switching over to another function.
- Pull out the battery plug or clamp the battery while working on the electrical unit.
- Maintenance work may only be carried out by approved customer service outlets or experts in this field who are familiar with the respective safety regulations.
- Mobile appliances used for commercial purposes are subject to safety inspections according to VDE 0701.

- Use only roller brushes/ side-brushes that are provided with the appliance or specified in the Operations Manual. The use of other roller brushes/ side-brushes can affect the safety of the appliance.
- Do not clean the appliance with a water hose or high-pressure water jet (danger of short circuits or other damage).

Cleaning the inside of the machine

⚠ Danger

Risk of injury! Wear dust mask and protective goggles.

- Open cover and secure it (Diag. 3).
- Clean machine with a cloth.
- Blow through machine with compressed air.
- Close cover.

External cleaning of the appliance

- Clean the machine with a damp cloth which has been soaked in mild detergent.

Note

Do not use aggressive cleaning agents.

Maintenance intervals

Note

The elapsed-time counter shows the timing of the maintenance intervals.

Maintenance by the customer

Daily maintenance:

- Check engine oil level.
- Check axle drive oil level.
- Check tyre pressure.
- Only KM 120/150 R LPG: Check gas pipes and connecting screws.
- Only KM 120/150 R LPG: Check gas filter in the screw to the gas cylinder to see if it is dirty, clean it if required (every time you change the cylinder).
- Check function of all operator control elements.

Weekly maintenance:

- Check leakiness of fuel or gas connections.
- Check return-line filter for sweeping system.
- Check air filter.
- Check oil level of sweeper hydraulics.
- Check hydraulic lines for leaks.
- Check moving parts for freedom of movement.
- Check the sealing strips in the sweeping area for position and wear.

Maintenance to be carried out every 100 operating hours:

- Check leakiness of fuel or gas connections.
- Change engine oil (initial change after 20 operating hours).
- Only KM 120/150 R G and R LPG: Check spark plug.
- Check function of seat contact mat.
- Check battery acid level.

- Check tension, wear and function of drive belts (V-belt and circular belt).

Maintenance following wear:

- Replace sealing strips.
- Replace roller brush.
- Replace side brush.

For description, see section on Maintenance work.

Note

Where maintenance is carried out by the customer, all service and maintenance work must be undertaken by a qualified specialist. If required, a specialised Kärcher dealer may be contacted at any time.

Maintenance by Customer Service

Maintenance to be carried out after 20 operating hours:

- Carry out initial inspection.

Maintenance to be carried out every 100 operating hours

Maintenance to be carried out every 200 operating hours

Maintenance to be carried out every 300 operating hours

Note

In order to safeguard warranty claims, all service and maintenance work during the warranty period must be carried out by the authorised Kärcher Customer Service in accordance with the maintenance booklet.

Maintenance Works

Preparation:

- Park the sweeper on an even surface.
- Turn ignition key to "0" and remove it.
- Lock parking brake.

General notes on safety

⚠ Danger

Risk of injury! While working around the lift/tilt emptying mechanism, raise the waste container to its highest point and secure it.

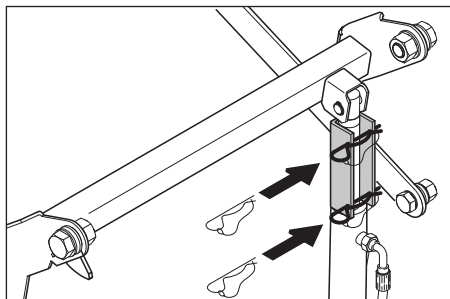

- Insert safety support into the piston rod for the lifting cylinder and secure it.

⚠ Danger

Risk of injury due to engine overrun. Once the engine has been switched off, wait for 5 seconds. Stay well clear of the working area for this time.

- Allow the machine sufficient time to cool down before carrying out any maintenance and repair work.

Do not touch any hot parts, such as the drive motor and exhaust system.

	Please do not release engine oil, fuel oil, diesel and petrol into the environment. Protect the ground and dispose of used oil in an environmentally-clean manner.
--	--

Safety notes regarding the batteries

Please observe the following warning notes when handling batteries:

	Observe the directions on the battery, in the instructions for use and in the vehicle operating instructions!
	Wear an eye shield!
	Keep away children from acid and batteries!
	Risk of explosion!
	Fire, sparks, open light, and smoking not allowed!
	Danger of causticization!
	First aid!
	Warning note!
	Disposal!
	Do not throw the battery in the dustbin!

⚠ Danger

Risk of explosion! Do not put tools or similar on the battery, i.e. on the terminal poles and cell connectors.

⚠ Danger

Risk of injury! Ensure that wounds never come into contact with lead. Always clean your hands after having worked with batteries.

Installing and connecting the battery

- Open cover and secure it (Diag. 3).
- Insert battery in battery mount.
- Screw on mounts on battery base.

- Connect pole terminal (red cable) to positive pole (+).
- Connect pole terminal to negative pole (-).

Charging battery

⚠ Danger

Risk of injury! Comply with safety regulations on the handling of batteries. Observe the directions provided by the manufacturer of the charger.

- Disconnect battery.
- Connect positive terminal cable from the charger to the positive pole connection on the battery.
- Connect negative terminal cable from the charger to the negative pole connection on the battery.
- Plug in mains connector and switch on charger.
- Charge battery using lowest possible level of charging current.

Check fluid level in the battery and adjust if required

⚠ Warning

Regularly check the fluid level in acid-filled batteries.

- Unscrew all cell caps.
- Where fluid level is too low, top up cells to the mark provided with distilled water.
- Charge battery.
- Screw in cell caps.

Remove the battery

Note

Before removing the battery, make sure that the negative pole lead is disconnected. Check that the battery pole and pole terminals are adequately protected with pole grease.

- Open cover and secure it (Diag. 3).
- Disconnect battery.
- Remove the battery from the battery holder.
- Dispose of the used battery according to the local provisions.

Check fuel indicator (only KM 120/150 R G and R D)

Note

After the machine is switched on, the number of operating hours is displayed for 10 seconds. The fuel gauge is then automatically displayed.

Note

The fuel gauge shows the length of time the machine has been in operation since the elapsed-time counter was last reset.

Note

The machine can be operated for a maximum of 3 hours on a full tank.

- Check fuel gauge for elapsed-time counter.

Check gas filter (only KM 120/150 R LPG)

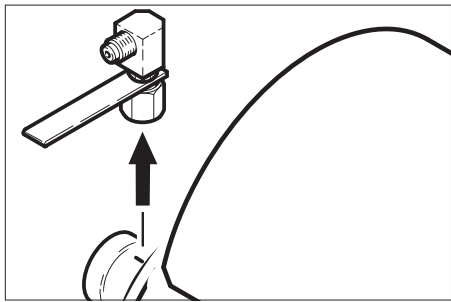

- Check gas filter in the screw to gas cylinder to see if it is dirty.
- Clean dirty filters with compressed air.

Check gas connections (only KM 120/150 R LPG)

Note

Inspection must be carried out by a qualified specialist.

- Check gas connections, pipes and evaporators using leak-search spray for leaks.

Note

Leaks in the gas cylinder cause formation of crusts or yellow frothy deposits on the gas connections, pipes and evaporator. Contact Kärcher Customer Service for maintenance of the gas unit.

Check the tyre pressure

- Park the sweeper on an even surface.
- Connect air pressure testing device to tyre valve.
- Check air pressure and adjust if required.
- Set air pressure for the front and rear tyres at 6 bar.

Replacing wheel

⚠ Danger

Risk of injury!

- Park the sweeper on an even surface.
 - Remove ignition key.
 - When carrying out repairs on public highways, wear warning clothing when working close to passing traffic.
 - Check stability of ground. Also secure the machine with wheel chock(s) to prevent it rolling away.
 - Lock parking brake.
- Check tyres
- Check tyre contact face for foreign objects.
 - Remove objects found.
 - Use suitable, commercially available materials to carry out tyre repairs.

Note

Observe the manufacturer's recommendations. The journey may be resumed providing that the directions supplied by the product manufacturer have been observed. The tyre/wheel change should nonetheless be carried out as soon as possible.

- Open quick-release locks on the relevant side panel.
- Remove side panel.
- Loosen wheel nuts.

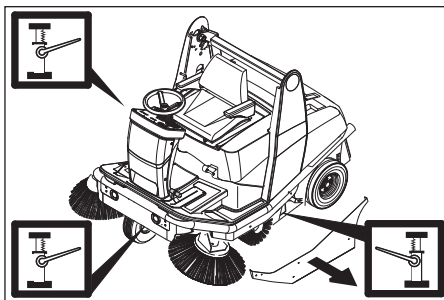

- Position vehicle jack at the appropriate mounting point for the front or rear wheel.
- Raise machine using vehicle jack.
- Remove wheel nuts.
- Remove wheel.
- Mount spare wheel.
- Screw on wheel nuts.
- Lower machine using vehicle jack.
- Tighten wheel nuts.
- Screw on side panel.

Note

Use a suitable commercially available vehicle jack.

Check engine oil level and top up, if required

⚠ Warning (only KM 120/150 R G and R LPG)

The engine is equipped with an oil deficiency switch. When the fill level is insufficient, the engine switches off and can only be restarted once the engine oil has been replenished.

⚠ Danger

Risk of burns!

- Allow engine to cool down.
 - Wait for at least 5 minutes after switching off the engine before checking the engine oil fill level.
 - Open cover and secure it (Diag. 3).
- KM 120/150 R G and R LPG:

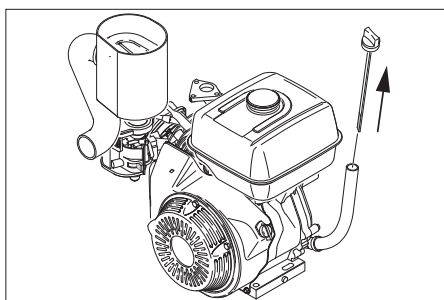

KM 120/150 R D:

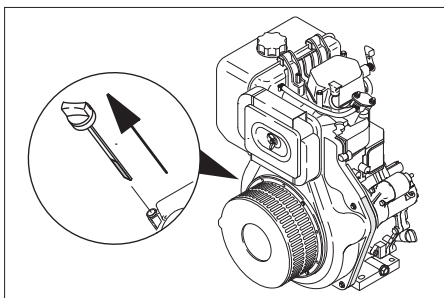

- Pull out oil dipstick.
- Wipe off oil dipstick and insert.
- Pull out oil dipstick.

Note

Oil must be present on at least one third of the oil dipstick. If the oil level is less than this, top up engine oil until it reaches the lower edge of the filler opening.

- Only KM 120/150 R G and R LPG: Dismantle the extension piece at the oil filler opening.
- Top up engine oil using 6.491-538 oil-change pump.
- Only KM 120/150 R G and R LPG: Install the extension piece at the oil filler opening.
- Close oil filler opening.
- Wait at least 5 minutes.
- Check engine oil level.

Oil grade: see Technical Data

Change the engine oil

- Pull out oil dipstick.
- Only KM 120/150 R G and R LPG: Dismantle the extension piece at the oil filler opening.
- Suck off engine oil using 6.491-538 oil-change pump.
- Fill in new engine oil using 6.491-538 oil-change pump.

Oil grade: see Technical Data

- Only KM 120/150 R G and R LPG: Install the extension piece at the oil filler opening.
- Close oil filler opening.
- Wait at least 5 minutes.
- Check engine oil level.

Only KM 120/150 R G and R LPG: The motor oil can be drained via a hose.

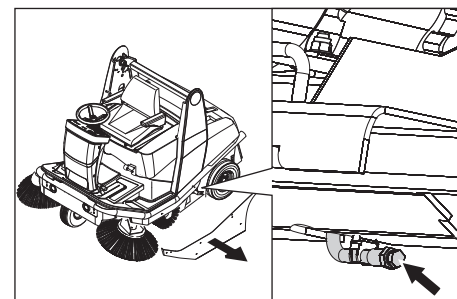

⚠ Danger

Risk of burns due to hot oil!

- Ready a catch bin for appr. 1.5 litre oil.
- Allow engine to cool down.
- Open quick-release locks on the left-hand side panel.
- Remove side panel.
- Remove the oil drain hose from the holder.
- Unscrew oil drain plug.
- Pull out oil dipstick.
- Drain off oil.
- Screw in oil drain plug.
- Insert the oil drain hose in the holder.

Check air filter and replace, if necessary

- Open cover and secure it (Diag. 3).

KM 120/150 R G and R LPG:

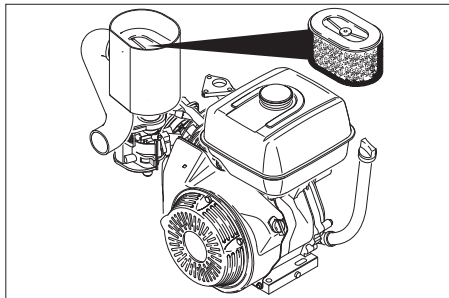

KM 120/150 R D:

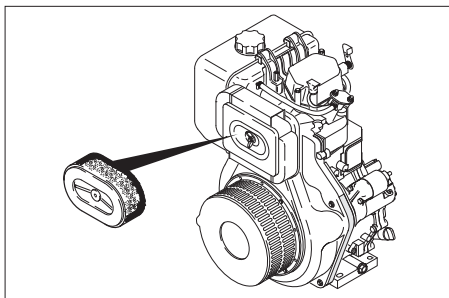

- Unscrew wing nut.
- Remove, check and clean filter cartridge.
- Use either a new or cleaned filter cartridge in the vacuum container.
- Screw on wing nut.

Clean and change spark plug (only KM 120/150 R G and R LPG)

- Open cover and secure it (Diag. 3).

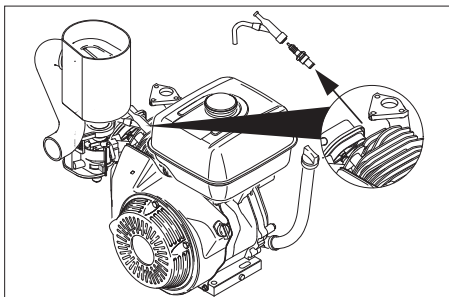

- Remove spark-plug connector.
- Unscrew and clean spark plug.
- Screw in cleaned or new spark plug.
- Push on spark-plug connector.

Check and adjust fill level of hydraulic fluid – sweeping hydraulics circuit

Note

The sweeper is equipped with 2 hydraulic circuits.

Note

Drive in the waste container to check/ correct the filling status.

The cap with the oil dipstick is located in the storage tank above the right rear wheel.

- Open cover and secure it (Diag. 3).

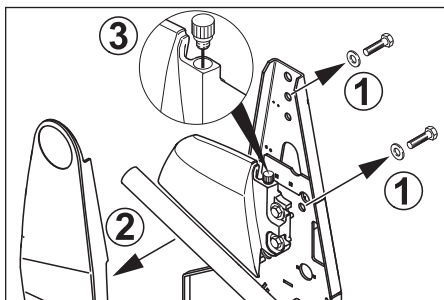

- Loosen screws (1).
- Remove panel (2).
- Open the lock with the oil dipstick (3).
- Check oil level using the oil dipstick.

Note

The oil level must lie between "MIN" and "MAX".

- Top up hydraulic oil if necessary.
- Close container.
- Screw on panel.

Oil grade: see Technical Data

Check and adjust hydraulic fluid fill level and change oil – axle drive circuit

Note

The sweeper is equipped with 2 hydraulic circuits.

■ (1) Checking fill level

- Raise waste container.
- Insert safety support into the piston rod for the lifting cylinder and secure it.
- Check the fill level in the header tank.

Note

The oil level must lie between the "MAX" mark and a distance of 2 cm above the base of the tank.

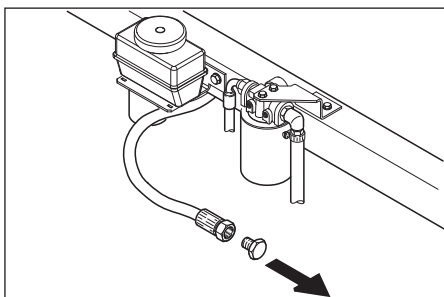

⚠ Warning

This inspection may only be carried out when the engine is cold.

■ (2) Adjusting fill level

- Raise waste container.
- Insert safety support into the piston rod for the lifting cylinder and secure it.
- Remove the lid of the container.
- If required, top up oil carefully.
- Close container.

Oil grade: see Technical Data

■ (3) Changing oil

- Raise waste container.
- Insert safety support into the piston rod for the lifting cylinder and secure it.
- Unscrew oil drain plug.
- Remove the lid of the container.
- Drain off oil.
- Screw in oil drain plug.
- Replenish oil.
- Close container.

Check oil filter/Check backflow pressure

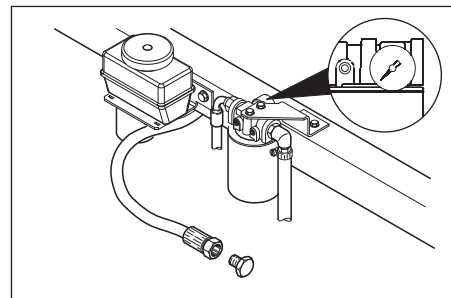

- The oil filter needs to be cleaned or replaced if the manometer display is in the red area.

Check side brush

- Park the sweeper on an even surface.
- Set programme switch to step 1 (driving). Side brushes lift up.
- Turn ignition key to "0" and remove it.
- Check side brush.

Note

The side brush floating mounting adjusts the sweeping track as the bristles wear down. The side brush must be replaced if it becomes too worn.

Replacing side brush

- Park the sweeper on an even surface.
- Set programme switch to step 1 (driving). Side brushes lift up.
- Turn ignition key to "0" and remove it.
- Loosen 3 retaining nuts on underside.
- Clip side brush on to driver and screw on.

Checking roller brush

- Park the sweeper on an even surface.
- Set programme switch to step 1 (driving). Roller brush is raised.
- Turn ignition key to "0" and remove it.
- Secure the machine with wheel chock(s) to prevent it from rolling away.
- Lock parking brake.
- Remove belts or cords from roller brush.

Replacing roller brush

Replacement is due if a visible deterioration in sweeping performance caused by bristle wear is evident.

- Park the sweeper on an even surface.
- Set programme switch to step 1 (driving). Roller brush is raised.
- Turn ignition key to "0" and remove it.
- Secure the machine with wheel chock(s) to prevent it from rolling away.
- Lock parking brake.
- Open quick-release locks on the right-hand side panel.

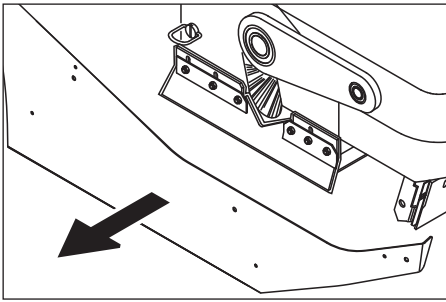

- Remove side panel.
- Unscrew and withdraw bolt on the roller brush swinging arm.

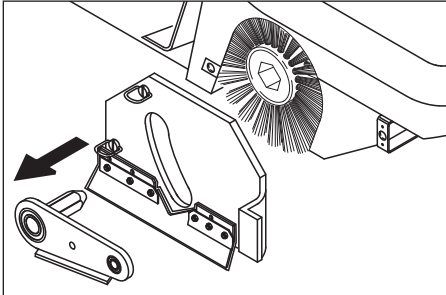

- Pull out roller brush swinging arm.
- Remove lifting rod assembly from pins.
- Open quick-release locks and remove cover.

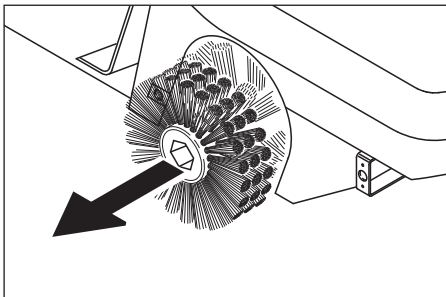

- Pull out roller brush.

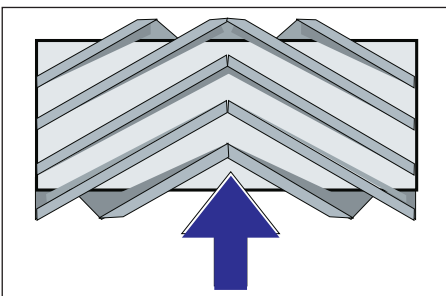

Installation position of roller brush in direction of travel

- Push new roller brush into the roller brush housing and onto the drive pin.

Note

When installing the new roller brush, ensure correct positioning of the bristle assembly.

- Position roller brush cover.
- Push lifting rod assembly on to pins.
- Push roller brush mount on to the pins.
- Tighten bolt on the roller brush mount.
- Position retaining screws for the roller brush cover and screw home.
- Screw on side panel.

Note

Once the new roller brush has been installed, the sweeping track must be readjusted.

Check and adjust roller brush sweeping track

Note

To do this, the machine must be in basic-operating mode. The power button indicator light should not light up.

- Set programme switch to step 1 (driving). The side brush and roller brush are raised.
- Drive sweeper on to a smooth, even surface covered with a visible layer of dust or chalk.
- Lower roller brush and allow it to briefly rotate.
- Raise roller brush.
- Press pedal which raises bulk waste flap and keep pressed.
- Drive machine backwards.

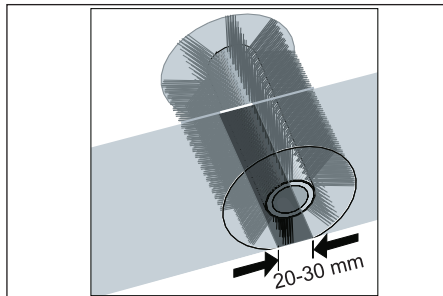

The sweeping track should have an even rectangular shape which is between 20 and 30 mm wide.

Note

The shape of the sweeping track must not be trapezoidal. If so, consult Customer Service.

Note

The sweeping track can be adjusted using a handwheel in basic-operating mode.

- Open cover and secure it (Diag. 3).

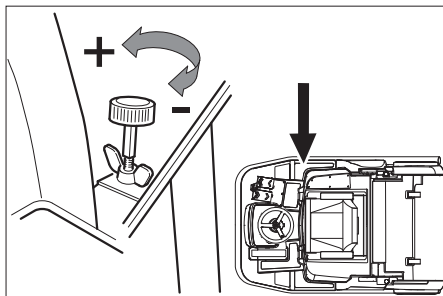

- Release the wing nut.

Enlarging sweeping track:

- Turn the adjustment screw in an anti-clockwise direction (+).

Reducing sweeping track:

- Turn the adjustment screw in a clockwise direction (-).
- Tighten the wing nut.

Note

In power-operating mode, the sweeping track is automatically adjusted due to the floating mounting for the side brush as the bristles wear down. The roller brush must be replaced if it becomes too worn.

Adjusting and replacing sealing strips

- Park the sweeper on an even surface.
- Set programme switch to step 1 (driving). Roller brush is raised.
- Turn ignition key to "0" and remove it.
- Secure the machine with wheel chock(s) to prevent it from rolling away.
- Lock parking brake.
- Open the side panel quick-release locks on both sides.
- Remove side panels.

■ Front sealing strip

- Loosen retaining nuts for the front sealing strip (1) slightly (to replace, unscrew).
- Screw on new sealing strip without fully tightening the nuts.

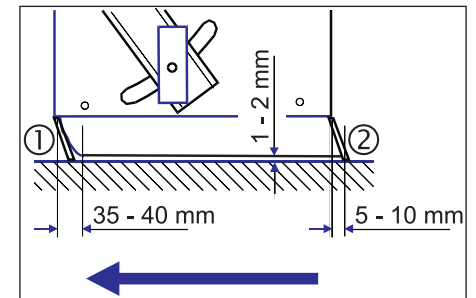

- Adjust sealing strip.
- Set the distance of the sealing strip to the floor so that the bottom edge trails behind at a distance of between 35 and 40 mm.

- Tighten nuts.

■ Rear sealing strip

- Set the distance between the sealing strip and the floor so that the bottom edge trails behind at a distance of between 5 and 10 mm.
- If worn, replace.
- Remove roller brush.
- Unscrew retaining nuts for rear sealing strip (2).
- Screw on new sealing strip.

■ Side sealing strips

- Slightly loosen retaining nuts for the side sealing strip (to replace, unscrew).
- Screw on new sealing strip without fully tightening the nuts.
- To set the floor clearance, insert a sheet with a thickness of between 1 and 2 mm under the sealing strip.
- Adjust sealing strip.
- Tighten nuts.
- Screw on side panels.

Replacing dust filter

⚠ Danger

Empty waste container before replacing dust filter. Wear a dust mask when working around the dust filter. Observe safety regulations on the handling of fine particulate material.

- Slightly raise the waste container and tipp it a little.

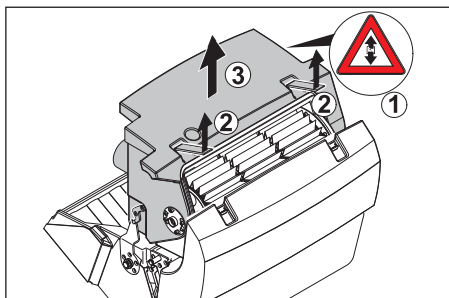

- Disconnect filter motor from power supply (1).
- Disconnect the plug connection of the limit switch.
- Loosen the screw joint of the filter agitator motor.
- Open catches (2).
- Slightly tip the filter box backwards and take it out (3).

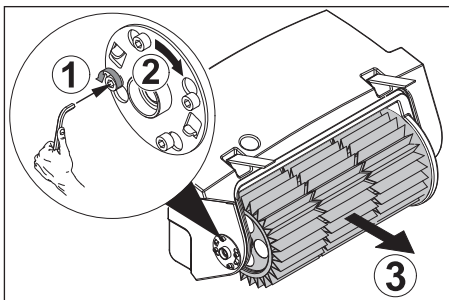

- Loosen filter mount (1), turn (2) and pull out.
- Remove louver filter (3).
- Insert new filter.
- Make sure driver engages with grooves on drive side.
- Snap filter mount back on and tighten screws.

Note

Make sure when installing the new filter that the fins are not damaged and the filter case seal does not get jammed.

Replacing filter case seal

- Lift filter case seal out of groove in the cover.
- Insert new seal.

Checking drive belt

⚠ Danger

The engine requires approx. 3-4 seconds to come to a standstill once it has been switched off. During this time, stay well clear of the working area.

- Turn ignition key to "0" and remove it.
- Open cover and secure it (Diag. 3).
- Check tension of drive belt and V-belt of the suction blower, also check for wear or damage.

- Check tension of drive belt and V-belt of the roller brush also check for wear or damage.

- Only KM 120/150 R LPG and KM 120/150 with driver cabin:

Check tension of drive belt and V-belt of the light machine; also check for wear or damage.

Check cup seal

- Check the cup seal at the suction blower regularly to see that it sits properly.

Replacing electric bulb

- Turn ignition key to "0" and remove it.
- Remove side brush.

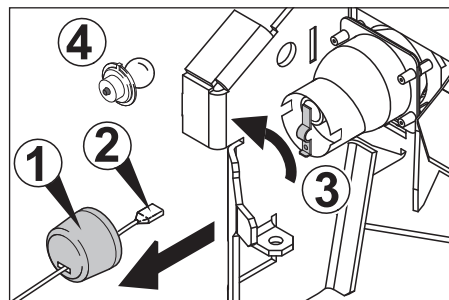

- Remove splash guard (1).
- Disconnect plug (2).
- Twist contact plate to one side (3).
- Remove defective bulb (4).
- Insert new bulb.
- Twist contact plate back into original position.
- Connect plug.
- Mount splash guard.
- Screw on side brush.

Replacing fuses of drive control/ electronic system

The drive control/electronic system is installed behind the front panel. To replace a fuse, the front panel must be removed.

- Loosen screws on both sides of the panel.

Note

The assignment of fuses is indicated on the inside of the front panel. Only use fuses with identical safety ratings.

- Replace defective fuses.
- Replace front panel.

Replacing electrical starter in the engine room (only KM 120/150 R D)

- Open cover and secure it (Diag. 3).

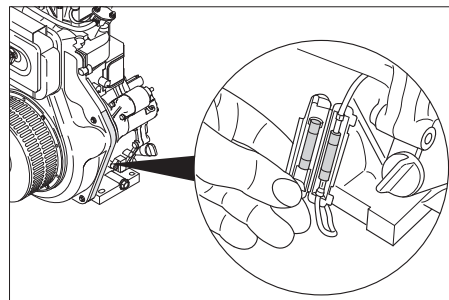

- Replace defective fuse.

Troubleshooting

Fault	Remedy
Appliance cannot be started	Sit on the driver seat, activate seat contact mat
	Refuel/ replace gas cylinder
	Open fuel tap/ gas supply
	Check connections and links in petrol or gas lines.
	Check fuse of the electrical starter, replace if required (only KM 120/150 R D)
	Charging battery
	Clean and change spark plug, replace if required (only KM 120/150 R G and R LPG)
	Inform Kärcher Customer Service.
	For temperatures below +10 °C: Lock parking brake
Engine is running erratically	Clean or replace air filter
	Check connections and links in petrol or gas lines.
	Inform Kärcher Customer Service.
Engine is running but machine is not moving	Release parking brake
	Check setting of freewheel lever
	Inform Kärcher Customer Service.
Engine is running but machine is only moving slowly	Release parking brake
	Allow machine to warm up for approx. 3 minutes in sub-zero temperatures
	Inform Kärcher Customer Service.
Machine is not sweeping properly	Check roller brush and side brushes for wear, replace if necessary.
	Check function of bulk waste flap
	Check sealing strips for wear, adjust or replace as required
	Adjust roller mirror
	Check hydraulic system (sweeping) for leaks.
	Inform Kärcher Customer Service.
Dust gathers in the machine	Empty waste container
	Check suction fan drive belt
	Check sealing cover on suction fan
	Check dust filter, clean or replace
	Check filter case seal
	Check sealing strips for wear, adjust or replace as required
Poor cleaning performance at edges	Replace side brush
	Check sealing strips for wear, adjust or replace as required
	Inform Kärcher Customer Service.
Side brush or roller brush switch-on operation is not working	Check hydraulic system (sweeping) for leaks.
	Inform Kärcher Customer Service.
Side brush or roller brush is not being lowered	Inform Kärcher Customer Service.
Insufficient vacuum performance	Check filter case seal
	Check sealing cover on suction fan
	Insert lamella filter correct; see Changing dust filter
Roller brush does not turn.	Remove belts or cords from roller brush
Charge indicator lamp glows only during operations (only KM 120/ 150 R D and R LPG)	Inform Kärcher Customer Service.

Technical specifications

		KM 120/150 R G	KM 120/150 R D	KM 120/150 R LPG
Machine data				
Length x width x height (without driver cabin)	mm	1900 x 1230 x 1400	1900 x 1230 x 1400	1900 x 1230 x 1800
Length x width x height (with driver cabin)	mm	1900 x 1230 x 2010	1900 x 1230 x 2010	1900 x 1230 x 2010
Length x width x height (with driver cabin and beacon light)	mm	1900 x 1230 x 2205	1900 x 1230 x 2205	1900 x 1230 x 2205
Unladen weight (without attachment sets)	kg	660	670	710
Permissible overall weight	kg	1110	1120	1160
Driving speed	km/h	10	10	10
Cleaning speed	km/h	8	8	8
Max. climbing performance (appliance without driver cabin)	%	18	18	18
Max. climbing performance (appliance with driver cabin)	%	10	10	10
Roller brush diameter	mm	300	300	300
Roller brush width	mm	850	850	850
Side brush diameter	mm	600	600	600
Surface cleaning performance without side brushes	m ² /h	6800	6800	6800
Surface cleaning performance with 2 side brushes	m ² /h	11588	11588	11588
Working width without side brushes	mm	850	850	850
Working width with 2 side brushes	mm	1470	1470	1470
Volume of waste container	l	150	150	150
Protection type, drip-proof	--	IPX 3	IPX 3	IPX 3
Engine				
Type	--	Honda, 1 cyl., four-stroke	Yanmar L100AE, 1 cyl., four-stroke	Honda, 1 cyl., four-stroke
Cylinder capacity	cm ³	390	406	390
Max. power	kW/PS	9,5/13	7,4/10	9,5/13
Maximum torque at 2500 rpm	Nm	26,5	--	26,5
Maximum torque at 2700 rpm	Nm	--	27	--
Capacity of fuel tank, normal petrol (unleaded)	l	6	--	--
Capacity of fuel tank, diesel	l	--	5,5	--
Spark plug, NGK	--	BPR 6 ES	--	BPR 6 ES
Type of protection	--	IP 22	IP 22	IP 22
Battery	V, Ah	12, 44	12, 44	12, 44
Fuel consumption	l/h	ca. 2	ca. 1,3	--
Gas consumption	kg/h	--	--	ca.
Oil grades				
SAE 15 W 40 engine	l	1,1	1,65	1,1
Sweeping hydraulics	--	HVLP 46	HVLP 46	HVLP 46
Axle drive	--	SAE 20 W 50	SAE 20 W 50	SAE 20 W 50
Tyres				
Size, front	--	4.00-4	4.00-4	4.00-4
Air pressure, front	bar	6	6	6

Size, rear	--	4.00-8	4.00-8	4.00-8
Air pressure, rear	bar	6	6	6
Brake				
Service brake	--	hydrostatic	hydrostatic	hydrostatic
Parking brake	--	Hand lever (with spring)	Hand lever (with spring)	Hand lever (with spring)
Filter and vacuum system				
Filter surface area, fine dust filter	m ²	9	9	9
Category of use – filter for non-hazardous dust	--	U	U	U
Nominal vacuum, suction system	mbar	12	12	12
Nominal volume flow, suction system	l/s	50	50	50
Working conditions				
Temperature	°C	-5 and +40	-5 and +40	-5 and +40
Air humidity, non-condensing	%	0 - 90	0 - 90	0 - 90
Noise emission				
Sound pressure level L _{pA} Machine without driver cabin	dB(A)	82	83	82
Sound pressure level L _{pA} Machine with driver cabin	dB(A)	88	88	88
Uncertainty K _{pA}	dB(A)	2	2	2
Sound power level L _{WA} + Uncertainty K _{WA}	dB(A)	101	100	100
Machine vibrations				
Hand-arm vibration value	m/s ²	<2,5	<2,5	<2,5
Seat	m/s ²	<0,5	<0,5	<0,5
Uncertainty K	m/s ²	0,2	0,2	0,2

Accessories

Installation set suction hose

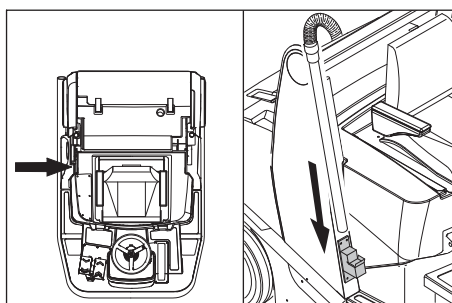

- Remove suction hose from holder.
- Suck in the dirt.
- Insert the suction hose in the holder.

Note

After completing the suction, ensure that the tube of the suction hose lies on the floor of the holder.

EC Declaration of Conformity

We hereby declare that the machine described below complies with the relevant basic safety and health requirements of the EU Directives, both in its basic design and construction as well as in the version put into circulation by us. This declaration shall cease to be valid if the machine is modified without our prior approval.

Product: Ride-on vacuum sweeper
Type: 1.511-xxx

Relevant EU Directives

2006/42/EC (+2009/127/EC)
2004/108/EC
2000/14/EC

Applied harmonized standards

EN 60335-1
EN 60335-2-72
EN 61000-6-2: 2005
EN 62233: 2008

Applied national standards

CISPR 12

Applied conformity evaluation method

2000/14/EC: Appendix V

Sound power level dB(A)

KM 120/150 R D

Measured: 99
Guaranteed: 101

KM 120/150 R G

Measured: 98
Guaranteed: 100

KM 120/150 R LPG

Measured: 98
Guaranteed: 100

The undersigned act on behalf and under the power of attorney of the company management.

H. Jenner
CEO

S. Reiser
Head of Approval

Authorised Documentation Representative
S. Reiser

Alfred Kärcher GmbH Co. KG
Alfred-Kärcher-Str. 28 - 40
71364 Winnenden (Germany)
Phone: +49 7195 14-0
Fax: +49 7195 14-2212

Warranty

The warranty terms published by the relevant sales company are applicable in each country. We will repair potential failures of your appliance within the warranty period free of charge, provided that such failure is caused by faulty material or defects in manufacturing. In the event of a warranty claim please contact your dealer or the nearest authorized Customer Service centre. Please submit the proof of purchase.



1.511-106.0
1.511-107.0
1.511-108.0
1.511-206.0
1.511-207.0
1.511-208.0

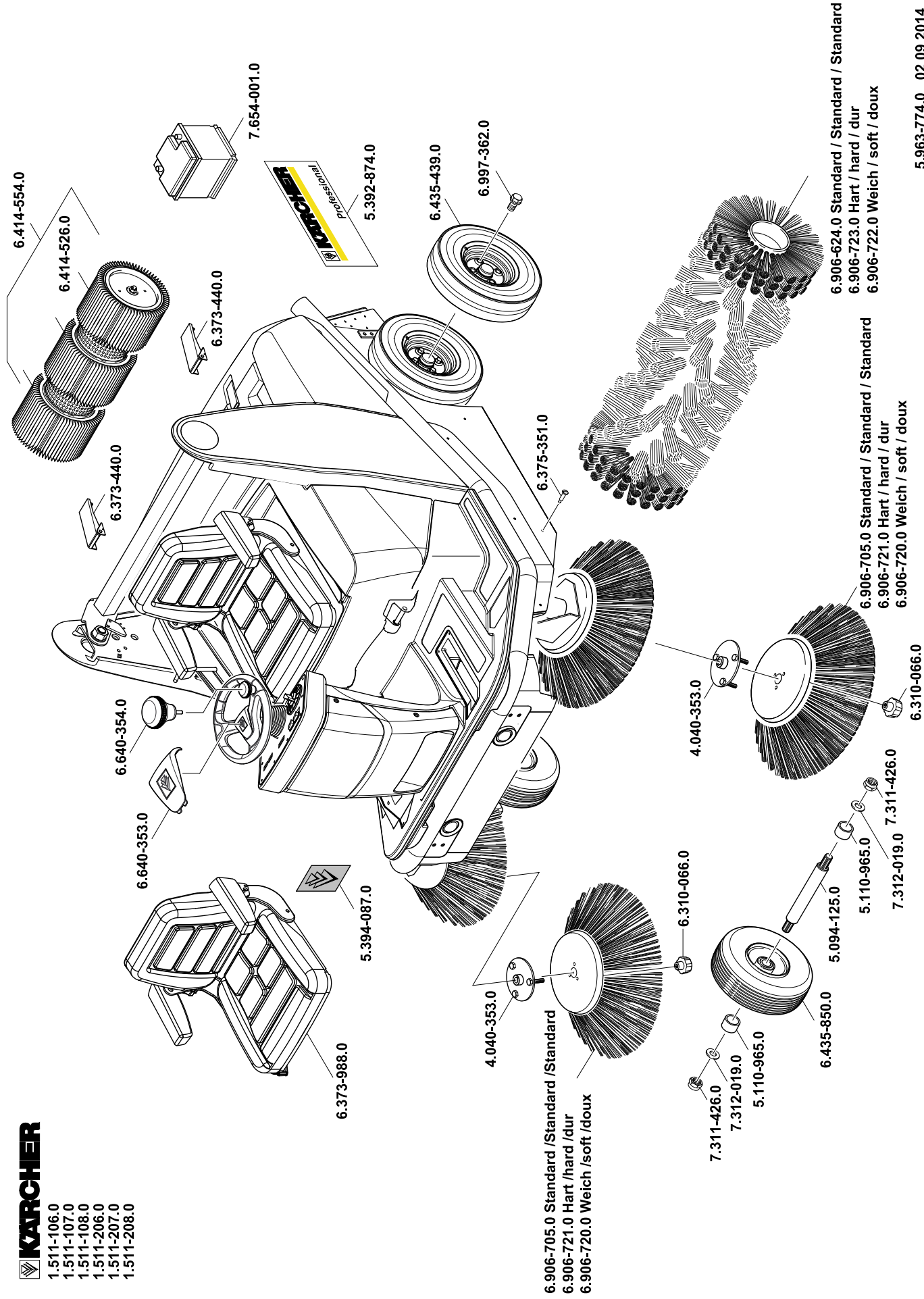



<http://www.kaercher.com/dealersearch>

