

CA 20 C Sanitary Everyday Cleaner

Floor cleaning

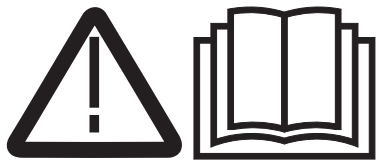

Warning

These are only brief instructions! Read the product information sheet and adhere to the safety instructions on the product label prior to using the detergent. Follow the dosing instructions on the product label.

The non-compliance with safety instructions may lead to damages of the object to be cleaned and to dangers for the environment, the operator and other persons.

Preparation

1

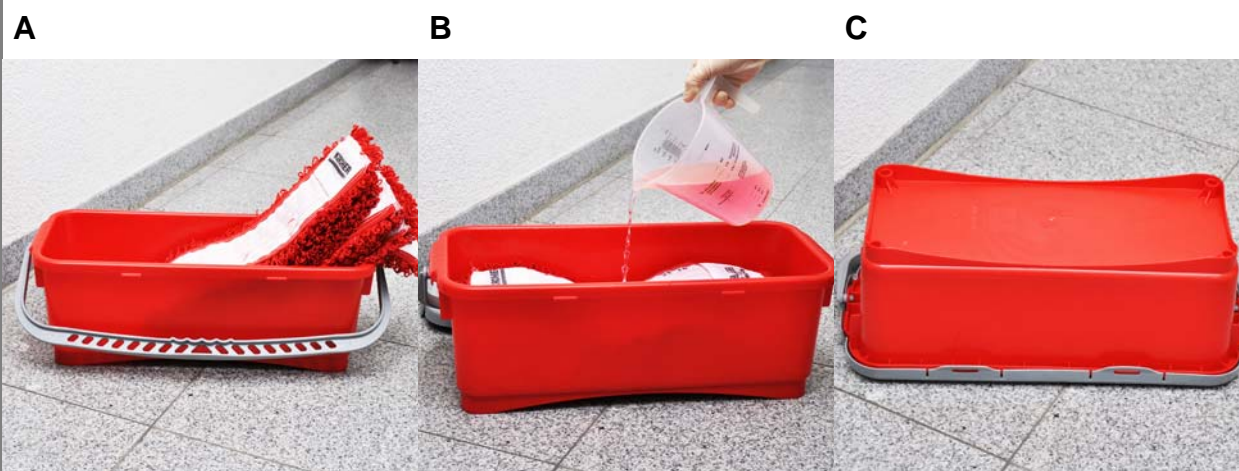

- A Place red mops into the bucket (10 to 15 pcs).
- B Pour the sanitary household cleaning solution onto the mops. Dosage: 10 ml/l. 1l detergent solution / 10 - 15 mops
- C Close the lid tightly, turn the bucket around and let the detergent solution soak in.

Cleaning

2



Note

Before cleaning, remove any coarse dirt from the surface.

- A Fasten the mop in the holder.
- B Clean the floor evenly.
- C If necessary wipe the surface with clear water.

After cleaning

3



- A Place the used cleaning supplies into the laundry bag.
- B Wash and dry the bucket. Prepare new mops if needed.

CA 20 C Sanitary Everyday Cleaner

Mopping with a bucket

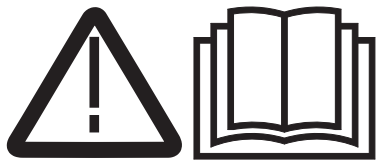

Warning

These are only brief instructions! Read the product information sheet and adhere to the safety instructions on the product label prior to using the detergent. Follow the dosing instructions on the product label.

The non-compliance with safety instructions may lead to damages of the object to be cleaned and to dangers for the environment, the operator and other persons.

Preparation



- A Fill the bucket with water.
- B Sanitary household cleaner dosage: 10 ml/l.
- C Pour the sanitary household cleaner into the bucket.

Cleaning



- A Moisten and wring out the cloth into the bucket.
- B Clean the surface with the cloth.
- C Dry and polish the surface as needed.

After cleaning

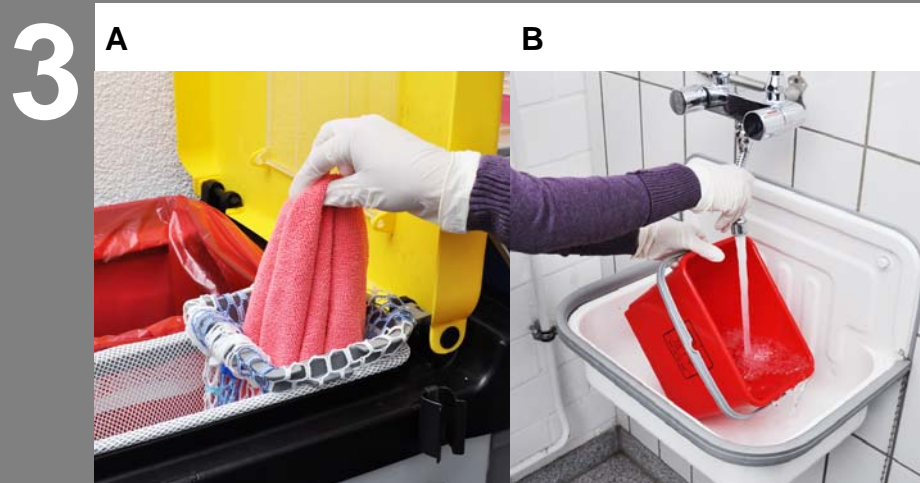

- A Place the used cleaning supplies into the laundry bag.
- B Wash and dry the bucket.

CA 20 C Sanitary Everyday Cleaner

Mopping with spray bottle

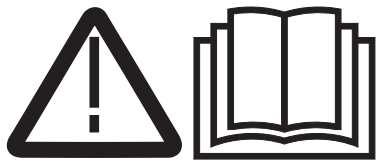

Warning

These are only brief instructions! Read the product information sheet and adhere to the safety instructions on the product label prior to using the detergent. Follow the dosing instructions on the product label.

The non-compliance with safety instructions may lead to damages of the object to be cleaned and to dangers for the environment, the operator and other persons.

Preparation

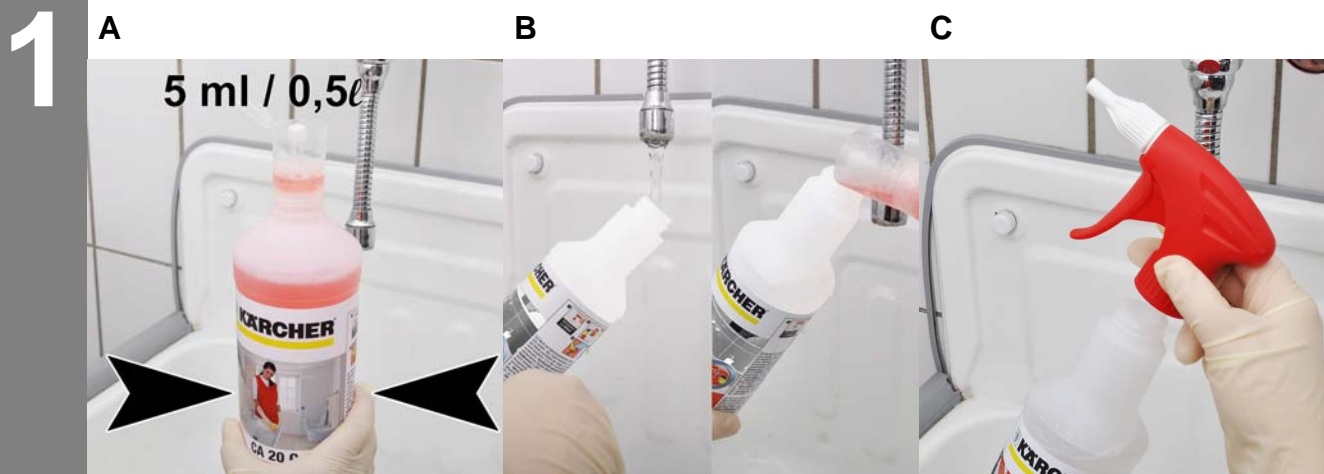

- A Sanitary household cleaner dosage: 5 ml/0.5 l.
- B Fill the spray bottle with water and add detergent.
- C Screw the spray head onto the bottle.

Cleaning



Note

Before cleaning, remove any coarse dirt from the surface.

- A Spray the sanitary household cleaning solution onto the cloth one to three times.
- B Clean the surface with the cloth.
- C Remove loosened dirt. Dry and polish the surface.

After cleaning



- A Place the used cleaning supplies into the laundry bag.