

# KÄRCHER



## MEMANG LEBIH BERKUASA

HIGH PERFORMANCE FOR EFFECTIVE CLEANING

 **GERMAN TECHNOLOGY**  
POWERFUL & RELIABLE

## PRESSURE CLEANER MAKES CLEANING EASY

Kärcher Pressure Cleaners offer the perfect solution for every cleaning task. Where previously dirt reigned supreme, afterwards there is nothing but cleanliness. With Kärcher, you upgrade your home environment and restore value to your possessions: from old to new, from shabby to chic. Passionate engineering, the highest standards of quality and decades of experience in developing innovative pressure cleaners make this possible. With the wide range of accessories and detergents, it opens up unlimited application possibilities for the high pressure cleaning.



### 1 Power Control and Premium Power Control range

Always the correct setting, always the best result – this is ensured by the new Kärcher Power Control range with pressure regulation on the spray lance and a pressure indicator on the trigger gun. The products also feature a telescopic handle for optimal storage, the tried-and-tested Plug 'n' Clean system for simple use of detergents and the Premium version also has a hose reel.

### 2 Compact range

Small and powerful: Kärcher's Compact range convinces with its compact dimensions, low space requirements, easy storage and high mobility.

### 3 Foam Jet nozzle for cleaning with powerful foam

Foam nozzle with extra powerful foam for easy cleaning of all surfaces such as paint, glass and stone. Ideal for vehicles, garden furniture, façades, stairways, caravans, paths, walls, venetian blinds, terraces, driveways etc. Suitable for all Kärcher pressure washers of the K 2 to K 5 classes. Ideal for use with Kärcher ultra foam cleaner.



## Home Pressure Cleaners Range

**K 2.050****K 2 COMPACT****K 2.360****Technical data**

Max. Pressure (bar/Mpa)	100	110	20 - 120
Max. Flow Rate (l/s)	342	360	360
Power Rate (Watt)	1400	1400	1400
Pressure Hose (m)	3	4	6
Motor Type	Universal	Universal	Universal
Detergent Application	Suction Tube	Suction Tube	Detergant Tank
Order no.	<b>1.601-652.0</b>	<b>1.673-500.0</b>	<b>1.601-686.0</b>

**K 2 POWER VPS****K 2 HR****K 3 HR PLUS****K 3 DELUXE PREMIUM****Technical data**

Max. Pressure (bar/Mpa)	100	20 - 110	20 - 120	20 - 120
Max. Flow Rate (l/s)	360	360	380	380
Power Rate (Watt)	1400	1400	1600	1600
Pressure Hose (m)	7.5	10	10	10
Motor Type	Induction	Universal	Universal	Water Cooled Induction
Detergent Application	Suction Tube	Suction Tube	Detergant Tank	Suction Tube
Order no.	<b>1.118-001.0</b>	<b>1.599-241.0</b>	<b>1.599-261.0</b>	<b>1.603-220.0</b>

**K 4 BASIC****K 4 PREMIUM POWER CONTROL****K 5 POWER CONTROL****Technical data**

Max. Pressure (bar/Mpa)	20 - 130	20 - 130	20 - 145
Max. Flow Rate (l/s)	420	420	500
Power Rate (Watt)	1800	1800	2100
Pressure Hose (m)	6	8	10
Motor Type	Water Cooled Induction	Water Cooled Induction	Water Cooled Induction
Detergent Application	Suction Tube	Plug 'n' Clean	Plug 'n' Clean
Order no.	<b>1.180-080.0</b>	<b>1.324-130.0</b>	<b>1.324-550.0</b>

## COMPACT AND VERSATILE

Ideal for tradesmen, building service providers, small businesses and anyone else who needs to work in a mobile way: The handy and powerful high-pressure cleaners. Their rugged design, practical carrying handle and integrated accessory storage guarantee maximum flexibility of use with minimal weight. Kärcher quality on the go.



### 1 Robust. Compact. Powerful Pressure Cleaner

Cold water compact class – for fast and thorough cleaning. Light and powerful: these compact, all-round cleaning machines clean courtyards and workshops in next to no time. They excel with pressure, flow rate and working time. Patented Kärcher power flat jet nozzles, cleaning up to 40% more impact force than conventional nozzles. High area coverage and thorough dirt removal.

The HD 5/11 P portable high-pressure cleaner impresses with its compact construction style, low weight and outstanding mobility. The machine features a reliable three-piston axial pump with brass cylinder head. An additional carrying handle and the extendable push handle make it easier to transport the machine and store it in small spaces.

### 2 For independent use

Petrol or diesel-powered high-pressure cleaners from Kärcher can be used anywhere there is no power supply available. This means that the machines are ideal for use in agriculture, construction or in the public sector.

### 3 Target group-specific solutions

In addition to the standard range, Kärcher also offers target group-specific cold water high-pressure cleaners, which are tailored to specific customer requirements. The HD 7/11-4 C Classic, for example, is used in the car wash industry. Extra large crankshafts and connecting rods with robust ball bearings. Ceramic pistons for reduced wear and tear. High performance sealing packages for longer working times.

## PROFESSIONAL PRESSURE CLEANER

## Classic Range

145  
max bar

HD 4/10 X

160  
max bar

HD 5/11 Cage

170  
max bar

HD 5/13

150  
max bar

HD 7/11-4 C Classic

240  
max bar

HD 9/20-4 C Classic

## Technical data

Operational Pressure (bar/Mpa)	100	110	130	70 - 110	70 - 200
Max. Flow Rate (l/h)	400	500	500	520 - 700	520 - 900
Connected Load (W)	1800	2200	2600	2900	6900
Spray lance length (mm)	600	600	850	850	600
Motor / Current Type	2-pole / 1ph	2-pole / 1 ph	2-pole / 1 ph	4-pole / 1 ph	4-pole / 3ph
Weight (Kg)	17.5	21.3	35	51.6	56
Order no.	1.520-976.0	1.520-204.0	1.520-022.0	1.367-305.0	1.367-308.0

## Power Range

160  
max bar

HD 5/11 P

175  
max bar

HD 5/12 C

225  
max bar

HD 6/15 M

240  
max bar

HD 6/16-4 M Plus

## Technical data

Operational Pressure (bar/Mpa)	110	120	150	160
Max. Flow Rate (l/h)	490	500	560	600
Connected Load (W)	2200	2500	3100	3300
Spray lance length (mm)	840	840	840	840
Motor / Current Type	2-pole / 1 ph	2-pole / 1 ph	2-pole / 1 ph	4-pole / 1 ph
Weight (Kg)	20.6	24.4	28.6	37
Order no.	1.520-960.0	1.520-900.0	1.150-945.0	1.524.933.0

## Engine Range

200  
max bar

HD 6/15 G Classic

250  
max bar

HD 7/20 G Classic

300  
max bar

HD 9/25 G Classic

## Technical data

Operational Pressure (bar/Mpa)	150	200	250
Max. Flow Rate (l/h)	600	700	900
Drive   Motor Type	Petrol   G200FA	Petrol   G210FA	Petrol   G390FA
Spray lance length (mm)	840	840	840
Weight (Kg)	42.5	36.2	56.8
Order no.	1.187-010.0	1.187-011.0	1.187-013.0

# HIGH SUCTION POWER VACUUM CLEANER

Kärcher multi-purpose vacuum cleaners are extremely powerful and designed to vacuum up regardless of whether it is dry, wet, coarse or fine dirt. For cleaning car interiors, households or hobby workshops - any type of dirt can be removed easily, quickly and conveniently with the Kärcher specific vacuum cleaners, thanks to their maximum suction power and matching accessories.

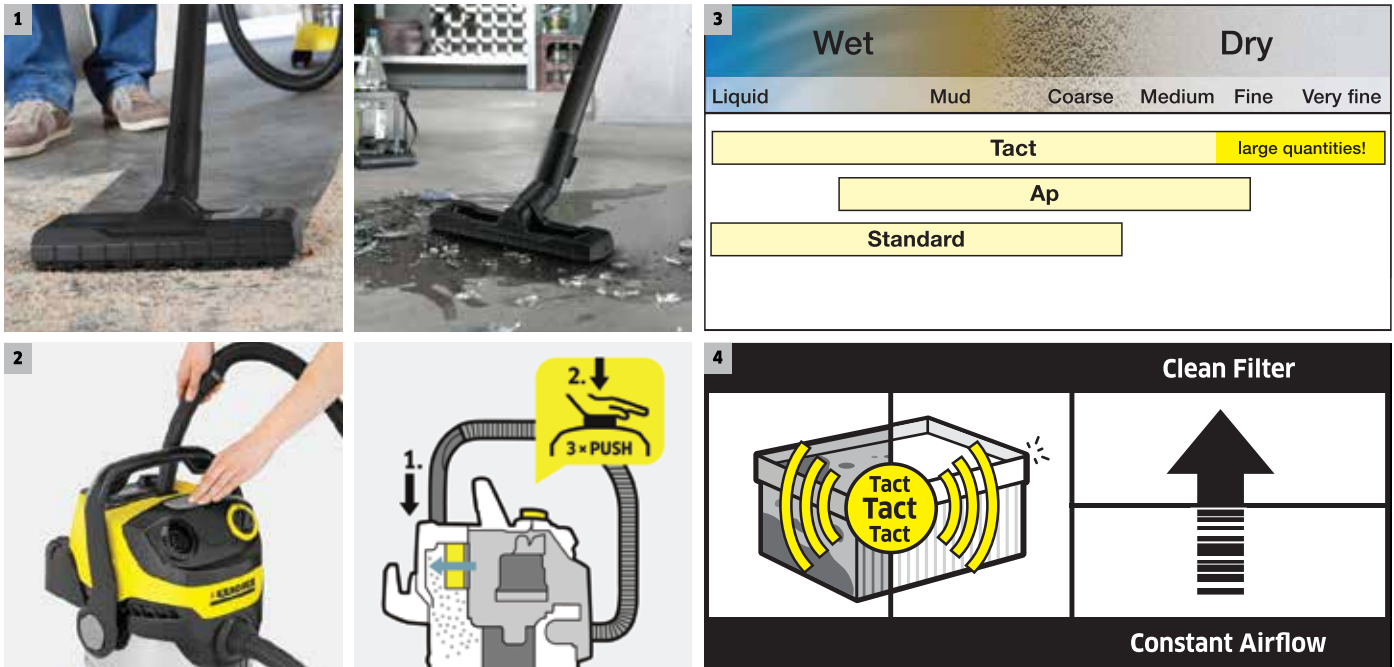

## 1 First-class floor nozzles

Dry, wet, coarse or fine dirt - it doesn't matter! The in-house developed floor nozzles guarantee perfect dirt pick-up, impress with optimal sliding behaviour and can be quickly and easily adapted to dry or wet dirt. With the clips floor nozzle, the changeover is effected by changing the inlay and, with the switchable floor nozzle, the changeover is carried out using the foot switch. The special floor nozzles guarantee all-round cleaning satisfaction.

And overview of the advantages: Fast and residue-free dirt removal, ideal for dry and wet dirt, effortless vacuuming.

## 2 Consistently high suction power

Thanks to the integrated filter cleaning function, dirty filters in all the top machines WD 5 can be cleaned quickly and efficiently simply by pushing the filter cleaning button. This means that even with difficult cleaning tasks, consistently high suction power is available. (see illustration).

The advantages at a glance: no manual cleaning required, no contact with dirt.

## 3 The optimal vacuum cleaner for all cleaning tasks

Kärcher NT vacuum cleaners are ideal for all wet and dry cleaning tasks. With universal and special tools.

- TACT vacuum cleaner: for liquids, coarse and fine dust. With the capacity for larger jobs.
- Ap vacuum cleaners: powerful universal vacuums for liquid or wet dirt and medium-fine dusts.
- Standard wet and dry cleaners: designed to pick up large quantities of liquid and coarse dirt.

## 4 Tact - the automatic filter cleaning system

Our professional wet and dry vacuum cleaners with the patented tact system allow uninterrupted operation, even with large quantities of fine dust. The filter automatically cleans itself with targeted, powerful blasts of air. The procedure is triggered automatically whilst maintaining constant high suction power. Other benefits include low maintenance costs and a long filter service life.



## Wet &amp; Dry Vacuum Cleaners Range



WD 1 Classic



WD 1S Classic



WD 2 PLUS V-12/4/18/C

## Technical data

Power Rate (W)	1200	1300	1000
Suction Power (Air Watts)	180	200	180
Container Capacity (L)	15	18 Stainless Steel	12
Power Cable (m)	5	5	4
Suction Hose (m)	1.5	1.5	1.8
Weight (Kg)	3.9	4.7	4.3
Order no.	1.098-331.0	1.098-323.0	1.628-009.0



WD 3 V-17/4/20



WD 3 S V-17/4/20



WD 5 S V-25/5/22

## Technical data

Power Rate (W)	1000	1000	1100
Suction Power (Air Watts)	200	200	240
Container Capacity (L)	17	17 Stainless Steel	25 Stainless Steel
Power Cable (m)	4	4	5
Suction Hose (m)	2	2	2.2
Weight (Kg)	5.4	5.8	8.7
Order no.	1.628-101.0	1.628-135.0	1.628-350.0

# PROFESSIONAL WET & DRY VACUUM CLEANER

As a professional user, you know there's much more to a good wet and dry vacuum cleaner than suction power alone. The overall design - with all filters and control elements, ergonomics, stability and optimal accessories - is the deciding factor. For decades, we have been continuously setting new standards in this area with our innovative technologies - at an excellent price-performance ratio too.

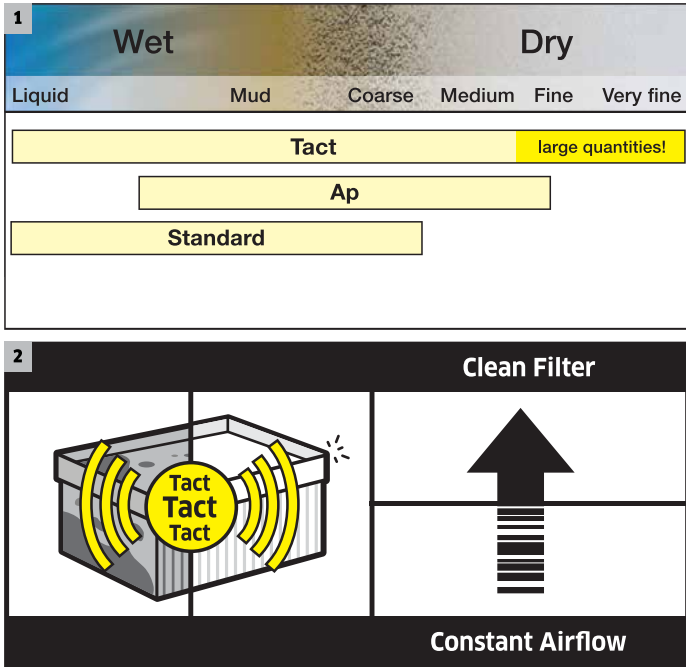

**3** EN 60335-2-69/IEC 60335-2-69 Appendix AA

Dust class	Max. degree of permeability	Suitable for	Application
L	≤ 1.0 %	■ Dusts with MAC values > 1 mg/m	
M	< 0.1 %	■ Dust with MAC values > 0.1 mg/m <sup>3</sup> ■ Wood dusts up to max. 1200 W/50 L	■ Wood dusts (beech, oak) ■ Paint dusts ■ Ceramic dusts ■ Plastic dusts
H	< 0.005 %	■ Dusts with MAC values ■ Carcinogenic dusts (§35 GeStoffV) ■ Pathogenic dusts	■ Carcinogenic dusts (lead, coal, cobalt, nickel, copper, cadmium, etc.) ■ Mould, bacteria, Germs ■ Formaldehyde
Additional requirement asbestos*	< 0.005 %	■ Dusts containing asbestos	■ Dusts containing asbestos from night storage heaters or fire walls
Explosive dusts (ATEX Zone 22)	Dust class L, M or H subject to additional requirements	■ Dusts in Zone 22 dust explosion classes	■ Paper dusts ■ Flour dusts ■ Metal dusts (e.g. aluminium)
EX	≤ 1.0 %	■ Dusts with MAC values > 1 mg/m <sup>3</sup>	

\* Binding for Germany according to TRGS 519.  
ATEX = ATmosphere EXplosion MAC = maximum allowable concentration

## 1 The optimal vacuum cleaner for all cleaning tasks

Kärcher NT vacuum cleaners are ideal for all wet and dry cleaning tasks. With universal and special tools.

- Tact vacuum cleaner: for liquids, coarse and fine dust. With the capacity for larger jobs.
- Ap vacuum cleaners: powerful universal vacuums for liquid or wet dirt and medium-fine dusts.
- Standard wet and dry cleaners: designed to pick up large quantities of liquid and coarse dirt.

## 2 Tact - the automatic filter cleaning system

Our professional wet and dry vacuum cleaners with the patented Tact system allow uninterrupted operation, even with large quantities of fine dust. The filter automatically cleans itself with targeted, powerful blasts of air. The procedure is triggered automatically whilst maintaining constant high suction power. Other benefits include low maintenance costs and a long filter service life.

## 3 Safety classes

Kärcher special vacuum cleaners are TÜV tested for optimal dust pick-up. All M and H class vacuum cleaners feature an antistatic system, electrically conductive accessories and power tool autostart. Our special H class vacuum cleaners have been tested and approved for asbestos use (according to TRGS 519). Our vacuum cleaners approved for ATEX Zone 22 can be used to remove explosive dusts.



## PROFESSIONAL WET & DRY VACUUM CLEANER

### Classic Range



NT 30/1 Me Classic



NT 38/1 Me Classic



NT 70/2 Me Classic

#### Technical data

Vacuum (mbar)	227	268	225
Air Flow (l/s)	59	75	53
Power (W)	1500	1600	2300
Container Capacity (L)	28	38	70
Cable length (m)	5	6.5	7.5
Order no.	1.428-569.0	1.428-531.0	1.667-225.0

## AP Class - Semi Filter Clean

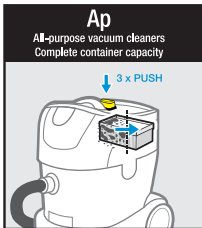

NT 22/1 Ap Bp L Pack



NT 30/1 Ap L

#### Technical data

Vacuum (mbar)	152	254
Air Flow (l/s)	57	74
Power (W)	Max. 575	1380
Container Capacity (L)	22	30
Cable length (m)	Battery run time. Eco 31 / Max. 24 min.	7.5
Order no.	1.528-120.0	1.148-221.0

## TACT Class - Auto Filter Clean



NT 30/1 Tact L



NT 40/1 Tact Te L

#### Technical data

Vacuum (mbar)	245	254
Air Flow (l/s)	74	74
Power (W)	1380	1380
Container Capacity (L)	30	40
Cable length (m)	7.5	7.5
Order no.	1.148-201.0	1.148-311.0

## FOR THOROUGH CLEANING RESULTS

A beautiful carpet makes the home feel cosy, emphasises features, and keeps your feet warm. The textile floor covering not only looks good, but it also improves slip-resistance, and dampens the noise of footsteps. The length of the pile determines how easy or demanding it is to maintain a carpeted floor. The maintenance effort is also determined by how often the carpet is used. For all carpets, regular and thorough cleaning is recommended: This maintains the appearance, increases the lifetime and, furthermore, ensures hygiene, since heavily ingrained dirt is loosened and pet hair and harmful mites are removed.



### 1 Kärcher nozzle technology

Kärcher spray extraction cleaners are not only ideal for allergy sufferers but also household with pets. With the right accessories, Kärcher SE 4001 can also be used as fully functional multi-purpose vacuum cleaners.

### 2 Quick-drying

Puzzi machines use a powerful suction turbine that leaves fabrics almost dry within minutes. They dry up to 50% faster than comparable products. This not only saves time but also reduces the risk of mold growth. Properly airing out the mattress, sofas or car seat within 24 hours of deep cleaning is important to prevent mold growth.

### 3 The spray extraction principle

With the spray extraction method, the water and cleaning agent are sprayed deep into the carpet while simultaneously vacuuming the dirty solution back again. Dirt is dissolved and removed in a single pass. Due to the low residual moisture, carpets are dry in next to no time.

### 4 Benefits D-RM760 carpet cleaner agent

The CarpetPro Cleaner iCapsol D-RM 760 tablet features innovative iCapsol technology for quick cleaning and drying. It's easy to dispense and safe to use due to individually packaged tabs in water-soluble film. Suitable for all floor coverings with Woolsafe certification and phosphate-free.



Technical data			
Air flow (l/s)	70	71	74
Vacuum (mbar/kPa)	210 / 21	270/27	254 / 25.4
Power Rate (Watt)	1400	1240	1250
Fresh/dirty water tank (L)	4/4	8 / 7	10 / 9
Weight (Kg)	7.8	8.6	10.5
Power cable (M)	7.5	7.5	7.5
Order no.	1.081-130.0	1.100-240.0	1.100-130.0

# OUTSTANDING FUNCTIONALITY VACUUM CLEANER

Kärcher vacuum cleaner comes with its own unique features that makes your life more convenient and stylish. The bagless VC 3 multi cyclone vacuum cleaner fits perfectly into the modern family home with its elegant design and practical size while it offers consistent high power without loss of suction. And, the surprisingly affordable T 8/1 Classic vacuum cleaner offers excellent cleaning performance and 8 litre catch pan for long work intervals, professionally designed vacuum cleaner for home use.

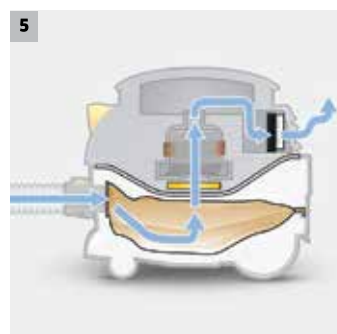

## 1 The cordless vacuum cleaner

Kärcher cordless vacuum cleaner offers maximum freedom of movement and a long battery running time - for a very high level of comfort. Thanks to state-of-the-art technology, the device offers powerful cleaning performance. And the innovative design ensures compact storage.

## 2 Long-lasting, powerful and safe

The ash and dry vacuum cleaner impress with their long-lasting and high level of suction power due to the integrated filter cleaning. With special accessories, the AD 4 Premium can also be used as a high-quality dry vacuum cleaner.

## 3 The starter canister vacuum cleaners

Kärcher floor vacuum cleaner are canister vacuum cleaners for the practical cleaning of flats or small homes. Well-equipped for many applications thanks to diverse accessories.

## 4 Multi-cyclone technology

The yellow VC 3 Plus multi-cyclone vacuum cleaner without filter bag is powerful and economical. With its transparent waste container, the cleaning effect can be seen at a glance.

## 5 The six-stage filter system including HEPA

The six-stage filter system with three-ply fleece filter bag, permanent main filter, motor protection filter and exhaust/HEPA filter ensures a separation degree of up to 99.997 per cent for optimal dust separation in HEPA quality.



Technical data	VC 3 PLUS	T 8/1 CLASSIC	AD 4 PREMIUM	VC 4s CORDLESS
Power Rate (Watt)	1100	1600	600	18 V (Lithium-ion battery)
Capacity (L)	0.9	8	17	0.3
Weight (Kg)	4.5	5	5.3	1.25
Power Cable	5	7.5	4	-
Tank (Type)	Plastic	Plastic	Metal	Plastic
Filter	HEPA 12	Main filter basket	Exhaust air filter	HEPA 12
Order no.	1.198-128.0	1.527-162.0	1.629-731.0	1.198-281.0



# STEAM CLEANING WITHOUT CHEMICAL

One for everything: the steam cleaner. The Kärcher steam cleaners ensure cleanliness in the entire household and your family can be sure that everything is cleaned fibre-deep – completely without chemicals. Thanks to the top cleaning performance, the steam kills up to 99.99%\* of coronavirus and all bacteria and ensures maximum hygiene and a healthy living environment. Whether in the kitchen, bathroom, on floors or even for the ironing, Kärcher really goes full steam and delivers top results.



## 1 Deep cleanliness without chemical

Scientific test confirm: Kärcher steam cleaners kills up to 99.99% of all household bacteria on hard surface, and they do this entirely without chemicals, using only steam.

\* The high temperature of the steam and excellent moisture penetration of the cloths reliably eliminate bacteria. For a healthy and child-friendly living space.

## 2 Clean better than a traditional wiping mop\*\*

The Kärcher steam cleaners achieve better results on hard floors than traditional, manual floor cleaning methods such as a wiping mop with detergents. This has been tested according to international performance standards.

\* When thoroughly cleaning with the Kärcher steam cleaner, 99.99% of all common household bacteria will be killed on common household hard surfaces.

\*\* When thoroughly cleaning with the Kärcher steam cleaner, the cleaning performance is better than cleaning manually with a mop and detergent. Tested according to international performance standards.

## 3 Cleanliness throughout the house

Put a stop tiresome scrubbing and scouring! Kärcher's highly efficient steam cleaners make cleaning effortless and ensure impeccable cleanliness throughout your entire home. The devices are extremely versatile and can replace a variety of conventional cleaning utensils thanks to the wide range of available accessories. Typical areas of use include common hard surfaces throughout the home - in kitchen (eg. fittings, sinks, exhaust hood and work surfaces) and bathrooms (e.g. shower cabins, fittings, sinks, tiles and crevices).

## 4 Hot and tough on dirt

Kärcher professional steam cleaners prove that steam is more than just hot air. For cleaning reliably without the use of chemicals, these machines are efficient and hygienic. With vapoHydro function, you can adapt the steam flow and saturation to the respective surface. And with corresponding accessories you can also clean both hard surfaces and textile surfaces without chemicals with the SG 4/4.



Technical data	SC 2 Deluxe EasyFix	SC 3 Deluxe EasyFix	SC 4 EasyFix	SG 4/4
Power Rate (Watt)	1500	1900	2000	2300
Capacity (L)	1	1	0.5 + 0.8	4
Max. Steam Pressure (bar)	3.2	3.5	3.5	4
Tank	Non-detachable	Refillable Tank	Refillable & detachable Tank	2-tank system
Weight (Kg)	2.7	3.3	4.1	8
Power cable (M)	4	4	4	7.5
Order no.	1.513-240.0	1.513-202.0	1.512-450.0	1.092-104.0

# BREATHE PURE, LIVE HEALTHY

If you've ever wondered how important air is, simply try holding your breath for few seconds. For us to feel good and be able to work, learn, or regenerate effectively, the air we breathe needs to be clean. Kärcher offers various air purifiers for different living situations and with the intelligent automatic mode, the device always adapts its performance to current air quality. Plug in, switch on and breathe easy. Our AF 20, AF 30, and AF 50 air purifier reliably filter allergens, pollutants and pathogens from the air you breathe with an efficient filtration of HEPA 13.



**Dual air inlet system -**  
A high airflow rate for fast air purification



**Silent operation -**  
Smooth-running motors and ventilators and quiet air ducts



**Colour display -**  
Displays temperature, air humidity and quality, and filter and device status



**HEPA 13 Filter -**  
Filters 99.95% of all particles larger than 0.3µm

	HEPA 8 - 10	HEPA 11 - 12	HEPA 13
Filtration efficiency (0.3µm particle size)	≥ 95%	≥ 99.5%	≥ 99.95%
Application	<p><b>For capturing:</b></p> <p>dust pet dander pollen</p> <p>mold</p>	<p><b>For capturing:</b></p> <p>dust pet dander pollen mold</p> <p>smoke fine dust odor</p>	<p><b>For capturing:</b></p> <p>dust pet dander pollen mold</p> <p>smoke dust mites odor virus</p> <p>asbestos carbon dust bacteria anthrax</p> <p>insecticides</p>

PORTABLE



AF 20

COMPACT



AF 30

POWERFUL



AF 50

Technical data	AF 20	AF 30	AF 50
Max. airflow (m³/h)	220	320	520
Utilization Area (m²)	20 - 40	30 - 60	50 - 100
Power Settings	3	5	5
Noise (dB)	26 (low speed) / 52 (high speed)	26 (low speed) / 51 (high speed)	29 (low speed) / 53 (high speed)
Order no.	1.024-820.0	1.024-821.0	1.024-822.0

## DIRTY JOBS DONE CLEAN

Powerful Kärcher submersible pumps offer quick, reliable help if you want to pump out clear or dirty water. Kärcher submersible pumps contain the tried-and-trusted ceramic slide ring sealing used in professional applications. This high-quality sealing makes the pumps more robust, prolongs their service life and means they are perfect for demanding use in and around the home.



**Extremely long-lasting**



**Flexible switching level adjustment**



**Perfect protection**



**Automatic pump start**



**Mop-dry pumping results**



**Individual switching level**



**Manual or automatic**



**Practical, quick connection**



**SP 9.500 Dirt**



**SP 11.000 Dirt**



**SP 16.000 Dirt**



**SP 22.000 Dirt Level Sensor**

**Technical data**

<b>Max. Motor Rating (W)</b>	280	400	550	750
<b>Water Flow Rate (l/h)</b>	9500	11000	16000	22000
<b>Max. Pressure (m/bar)</b>	6.0/6.0	7.0/7.0	8.0/8.0	8.0/8.0
<b>Max. Grain Size (mm)</b>	20	20	20	30
<b>Switching Technique</b>	Float Switch	Float Switch	Vertically adjustable float switch	Level Sensor
<b>Order no.</b>	<b>1.645-800.0</b>	<b>1.645-820.0</b>	<b>1.645-830.0</b>	<b>1.645-851.0</b>





### Highly efficient blower

AB30 air blower ensures a fast drying time of carpets and hard flooring. Ideal for the construction site, toilet, and after water damages in buildings.

### Air Blower



**AB 30 Classic**

**Technical data**

Speed Settings	3
Blower Speed	1000 / 1250 / 1400
Power (W)	520
Weight (KG)	8.5
Dimensions ((L x W x H) (mm))	400 x 400 x 402
<b>Order no.</b>	<b>1.004-058.0</b>

### Single Disc Cleaner



**BDS 43 / 150 c Classic**

**Technical data**

Power Rated (W)	1500
Working width (mm)	430
Brush contact pressure (g/cm <sup>2</sup> /kg)	30 / 43
Brush rotational speed (rpm)	150
Fresh/dirty water tank (L)	10/-
<b>Order no.</b>	<b>1.291-247.0</b>



### Rubost & reliable single disc cleaner

Whether scrubbing, crystallising, shampooing or diamond polishing - our powerful single disc machines are just as versatile as they are efficient in everyday use.



### Sweep 10 times faster

A person with a normal broom can sweep between 200-250m<sup>2</sup> in an hour. With a KM70/20C push sweeper, one can cover up to 2800m<sup>2</sup> in an hour, which is almost 10 times the coverage. You spend much less time cleaning and more on other productive work.

### Push Sweepers



**KM 70/20 C**

**Technical data**

Working width (mm)	480
Brush setting	Adjustable
Max. area performance (m <sup>2</sup> /h)	2800
Waster container (l)	20
Drive type	manual
Dimensions (L x W x H) (mm)	1300 / 765 / 1035
<b>Order no.</b>	<b>1.517-106.0</b>

## WATERING SYSTEM • HOSE REEL / HOSE TROLLEY



<b>Model:</b>	<b>Hose Hanger</b>
<b>Type</b>	1. Hose hanger 2. Hose Hanger Plus 3. Premium Hose Hanger W/ Box
<b>Function</b>	<ul style="list-style-type: none"> <li>■ Avoid hose tangle or trip hazards</li> <li>■ Neat garden area</li> <li>■ At ease finding garden tools</li> </ul>

<b>Model:</b>	<b>Hose Reel</b>
<b>Type</b>	1. Hose Reel HR25, 1/2", 15m 2. Hose Reel HR25 With Bracket 3. Premium Hose Reel W/ Box
<b>Function</b>	<ul style="list-style-type: none"> <li>■ Avoid hose tangle or trip hazards</li> <li>■ No tedious pulling and tugging</li> <li>■ Space-saving</li> </ul>

<b>Model:</b>	<b>Hose Trolley</b>
<b>Type</b>	1. Hose Trolley HT 3.420 Kit 1/2", 20m 2. Hose Trolley HT 3.420 Kit 5/8", 20m 3. Hose Trolley HT 3.400 Only
<b>Function</b>	<ul style="list-style-type: none"> <li>■ Angled hose connection</li> <li>■ Height-adjustable handle</li> <li>■ Non-slip ergonomic handle</li> </ul>

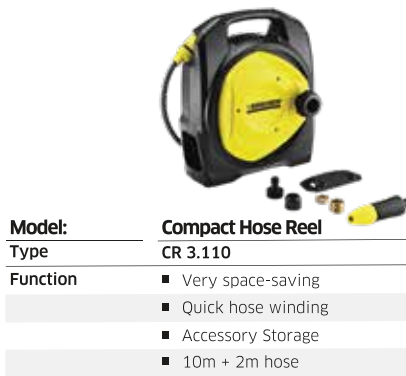

<b>Model:</b>	<b>Compact Hose Reel</b>
<b>Type</b>	<b>CR 3.110</b>
<b>Function</b>	<ul style="list-style-type: none"> <li>■ Very space-saving</li> <li>■ Quick hose winding</li> <li>■ Accessory Storage</li> <li>■ 10m + 2m hose</li> </ul>



<b>Model:</b>	<b>Premium Auto Hose Reel</b>
<b>Type</b>	<b>CR 7.220</b>
<b>Function</b>	<ul style="list-style-type: none"> <li>■ Automatic hose retraction</li> <li>■ Adjustable swivel</li> <li>■ Swivels from 0° to 180°</li> <li>■ 20m + 2m hose</li> </ul>

## WATERING SYSTEM • HIGH QUALITY HOSE



<b>Model:</b>	<b>PRIMOFLEX® Hose</b>
<b>Type</b>	1. PrimoFlex 1/2" 15m 2. PrimoFlex 5/8" 15m 3. PrimoFlex 3/4" 25m
<b>Function</b>	<ul style="list-style-type: none"> <li>■ 3 layers hose</li> <li>■ Pressure resistant 22 bar</li> <li>■ Anti-UV layer</li> </ul>

<b>Model:</b>	<b>PRIMOFLEX® PLUS HOSE</b>
<b>Type</b>	1. PrimoFlex Plus 1/2" 20m 2. PrimoFlex Plus 5/8" 25m
<b>Function</b>	<ul style="list-style-type: none"> <li>■ 3 layers hose</li> <li>■ Pressure resistant 40 bar</li> <li>■ Anti-UV layer</li> <li>■ Kevlar Fibre</li> </ul>

<b>Model:</b>	<b>PRIMOFLEX® PREMIUM HOSE</b>
<b>Type</b>	1. PrimoFlex Premium 1/2" 20m 2. PrimoFlex Premium 5/8" 25m
<b>Function</b>	<ul style="list-style-type: none"> <li>■ 5 layers hose</li> <li>■ Pressure resistant 40 bar</li> <li>■ Anti-UV layer</li> <li>■ Kevlar Fibre</li> </ul>

<b>Model:</b>	<b>Spiral Hose Set</b>
<b>Type</b>	1. Spiral Hose 5/6" 10m
<b>Function</b>	<ul style="list-style-type: none"> <li>■ Anti-UV</li> <li>■ Kink-proof</li> <li>■ Phthalate-free</li> <li>■ Ideal for watering in small garden</li> </ul>

Available at:

# K'ARCHER

Please contact us for more information:

**Germany Head Office**  
Alfred Kärcher SE & Co.KG  
Alfred-Kärcher-Straße 28-40  
71364 Winnenden

**Malaysia Office**  
Kärcher Cleaning Systems Sdn Bhd  
No. 5, Jalan Perintis U1/52,  
Seksyen U1, Kawasan Perindustrian  
Temasya Glenmarie,  
40150 Shah Alam, Selangor  
[www.kärcher.com.my](http://www.kärcher.com.my)