

Turnable Hose Connection

DSA 1500 / 3000

Turnable Hose Connections are accessories to WOMA high-pressure guns. They are designed to allow the high pressure hose to rotate freely at the connection to the high-pressure gun. Recoil forces of the hose are avoided and the gun work becomes more comfortable and safe.

Special benefits

- Pressurized components made of high-strength stainless steel
- All functional components are protected against the penetration of dirt and splashing water

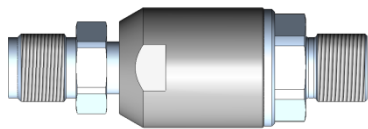

DSA 1500

Technical data DSA 1500	
Operating pressure	max. 1.500 bar
Nominal flow rate	max. 65 l/min
Medium temperature	max. 98 °C
Gun connection A	M22 x 1,5 DZ
Diameter	39 mm
Overall length L1	116 mm
Connected length L2	95-105 mm
Weight	approx. 0,55 kg



DSA 3000

Technical data DSA 3000	
Operating pressure	max. 3.000 bar
Nominal flow rate	max. 45 l/min
Medium temperature	max. 98 °C
Gun connection A	1 1/8"-12-UNF
Diameter	39 mm
Overall length L1	147-157 mm
Connected length L2	117-127 mm
Weight	approx. 0,7 kg

Variants		
Type	Hose connection P	Material-Number
DSA 1500	M24 x 1,5 24°DKO	9.872-437.0
DSA 3000	3/8"-24-UNF-LH	9.872-639.0
DSA 3000	9/16"-18-UNF-LH	9.872-640.0